

- NOTES**
- 1- ALL DIMENSIONS ARE IN MILLIMETERS, EXCEPT OTHERWISE NOTED.
 - 2- ALL COORDINATES AND ELEVATIONS ARE IN METERS.
 - 3- ALL COORDINATES OF THIS PLAN ARE LOCAL.
 - 4- H.P.P. = 100.00 - CORRESPONDING TO 41.668 M.S.L.
 - 5- SHOWN PIPING / PIPELINES AND RELEVANT SUPPORTS, ARE INDICATIVE.
 - 6- DIMENSIONS OF W.H.C.P. AND RELEVANT SUPPORTS WILL BE FINALIZED.
 - 7- REFERENCE COORDINATES E=1000.000 , N=1000.000 REFER TO X=435082.354 , Y=3294748.888 UTM .
 - 8- FOR DETAIL OF BURN PIT & ACCESS ROAD SEE BK-W046S-PEDCO-110-CV-PY-0002
 - 9- DUE TO NOT FINALIZING OF WAST MANAGEMENT PHILOSOPHY, MUD PITS ARE HOLD.

LEGEND & ABBREVIATIONS

F.T.	FUEL TANK
S.R.	SECURITY ROOM
S.G.	SWITCH GEAR
W.T.	WATER TANK
D.G.	DIESEL GENERATOR SHELTER
H.P.P.	HIGH POINT PAVING

-X-X-	FENCE
- - -	MATCH LINE
○	WELL LOCATION
---	SURFACE WATER TRENCH
	GRATING

REFERENCE DRAWING	DRG. No.
GENERAL CIVIL LAYOUT - W046S	BK-W046S-PEDCO-110-CV-PY-0001
CIVIL AND STRUCTURAL DRAWINGS - W046S	BK-W046S-PEDCO-110-CV-PY-0002
P&ID - W046S	BK-W046S-PEDCO-110-PR-PI-0001

- نقشه پلان و پروفایل در جدول زیر درج شده است.
- نقشه پلان و پروفایل در جدول زیر درج شده است.
- نقشه پلان و پروفایل در جدول زیر درج شده است.

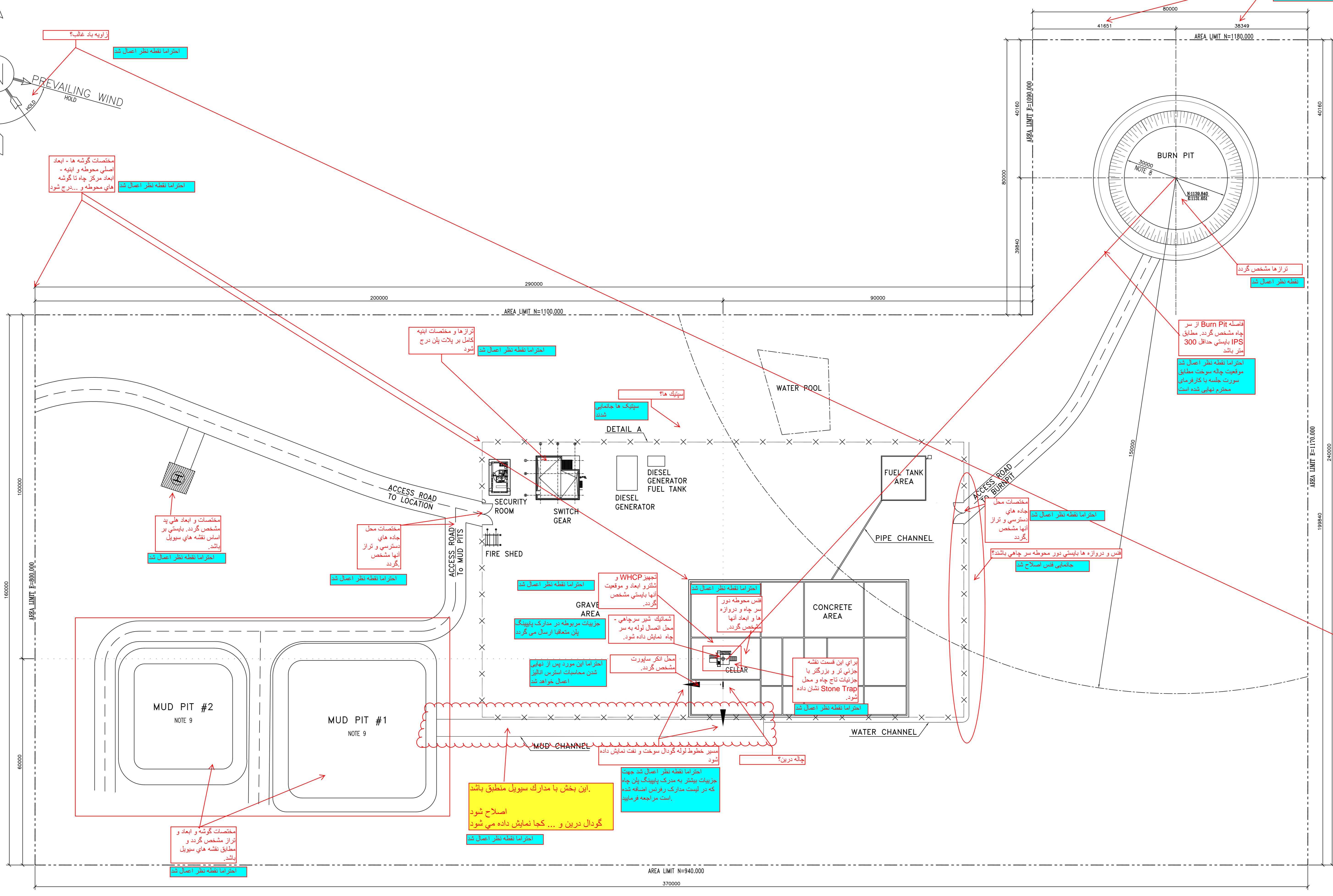
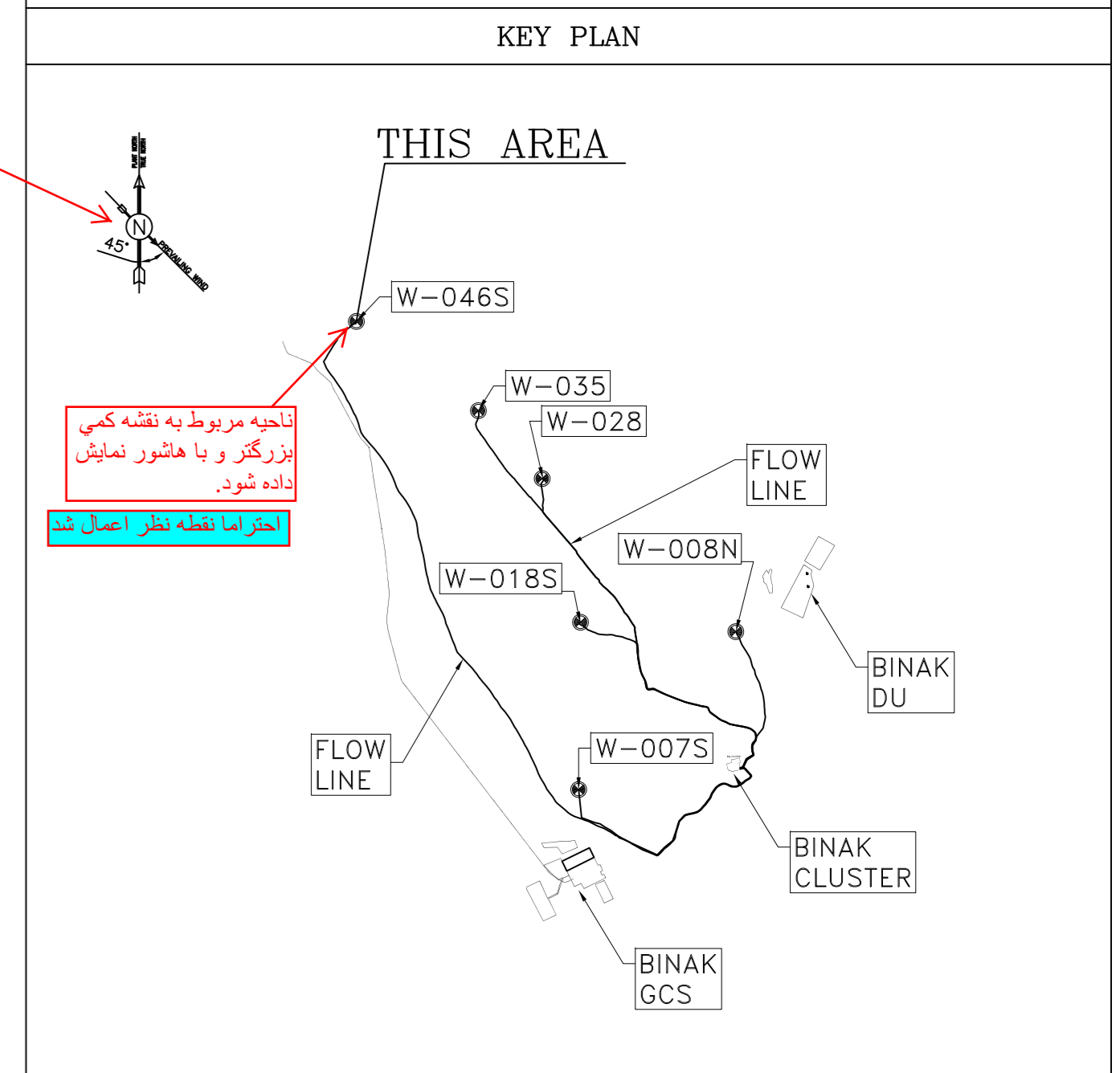

WELLHEAD PLOT PLAN
WELL NO.: W046S SC: 1/500

DOO	MAY.2022	IPC	A.KHOSRAVI	M.FAKHARIAN	M.MEHRSHAD	***
REV.	DATE	P.O.I.S	PREP.	CHK.	APP.	AUT.
PROJECT NAME: BINAK OILFIELD DEVELOPMENT/SUB-SURFACE WORK PACKAGES W046S WELLHEAD FACILITIES						
PROJECT NO.: 971020						
EPC CONTRACTOR: HIRGAN ENERGY			GENERAL CONTRACTOR: PETROIRAN DEVELOPMENT COMPANY			
DRAWING TITLE: PLOT PLAN DRAWING - W046S						
SCALE	SIZE	DRAWING NO.	SHEET NO.	REV.	BUDGET REF.	LOCATION SIZE CLASS
AS SHOWN	A0	BK-W046S-PEDCO-110-PI-DW-0001	1 OF 2	D00	053-073-9184	F 5 A

REV.	DESCRIPTION	BY	DATE	BY	DATE	
***	*****	***	****	***	****	
CHECKED BY						
REV. APPR.						
اصل و کپی این نقشه و حق اقتباس متعلق به شرکت ملی مناطق نفت خیز جنوب میباشد.						
THE ORIGINAL AND ALL COPIES OF THIS DRAWING TOGETHER WITH THE COPYRIGHT THEREIN ARE THE SOLE PROPERTY OF N.I.S.O.C./ FIELDS						
DATE	SCALE	DRAWING BY	CHECKED BY	PROJECT ENG.		
NO CONSTRUCTION PERMITTED UNLESS DRAWING APPROVED						
APPROVED FOR CONSTRUCTION			BY:	DATE:		
SCALE	SIZE	DRAWING NO.	SHEET NO.	REV.	BUDGET REF.	LOCATION SIZE CLASS
AS SHOWN	A0	BK-W046S-PEDCO-110-PI-DW-0001	1 OF 2	D00	053-073-9184	F 5 A

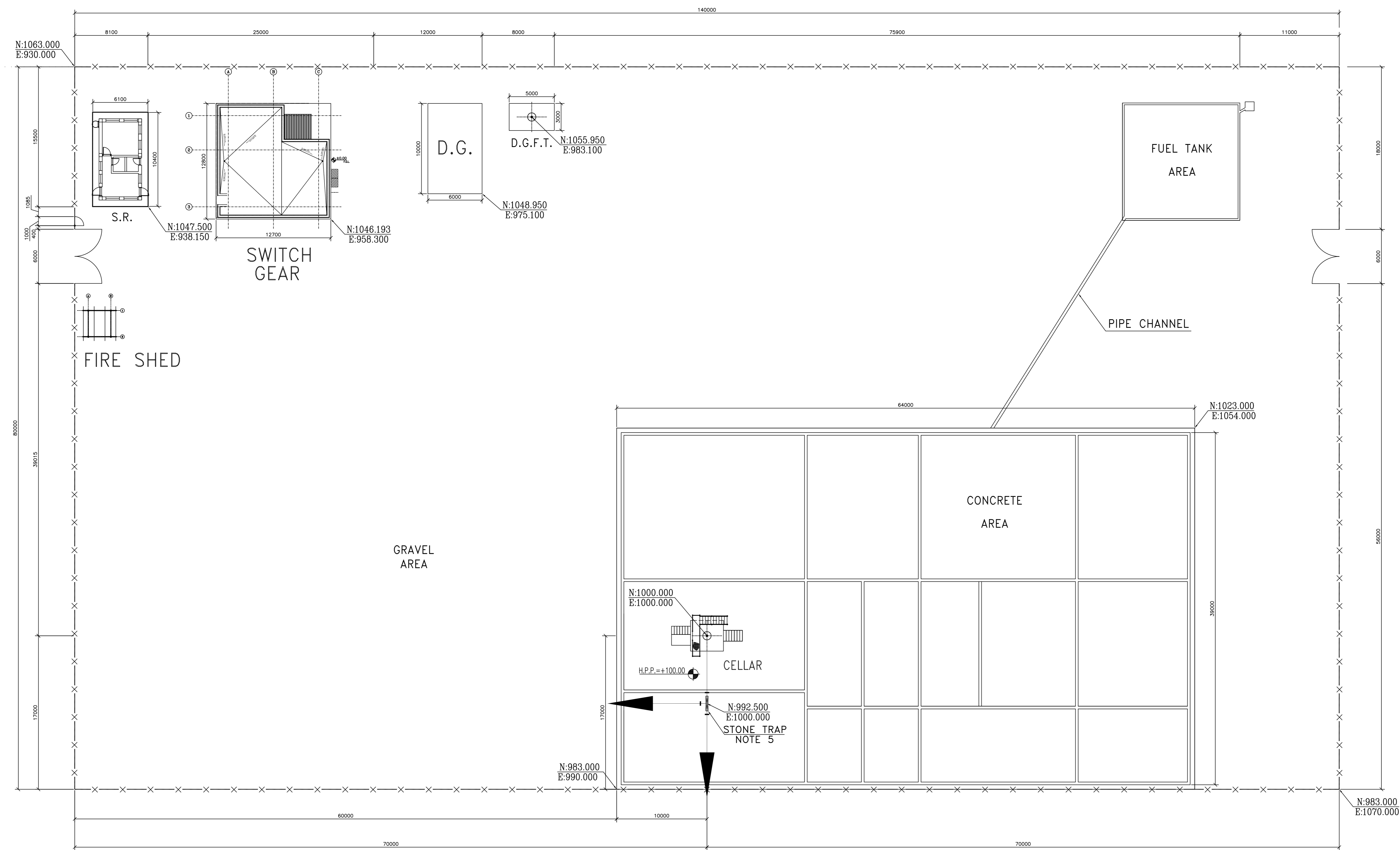
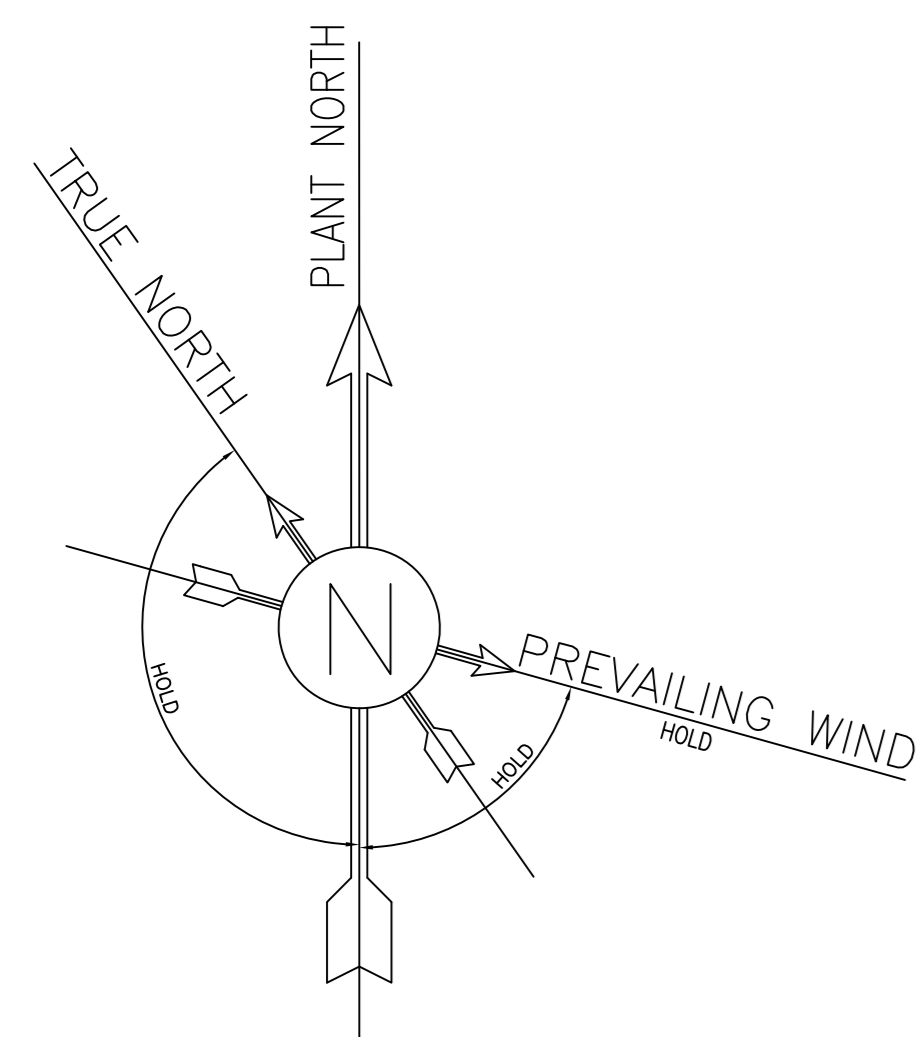

DETAIL A
SC: 1/200

- NOTES**
- 1- ALL DIMENSIONS ARE IN MILLIMETERS, EXCEPT OTHERWISE NOTED.
 - 2- ALL COORDINATES AND ELEVATIONS ARE IN METERS.
 - 3- ALL COORDINATES OF THIS PLAN ARE LOCAL.
 - 4- H.P.P. 100.00m CORRESPONDING TO 41.668 M.S.L.
 - 5- SHOWN PIPING / PIPELINES AND RELEVANT SUPPORTS, ARE INDICATIVE.
 - 6- DIMENSIONS OF W.H.C.P. AND RELEVANT SHELTER WILL BE FINALIZED.
 - 7- REFERENCE COORDINATES E=1000.000 , N=1000.000 REFER TO X=435082.354 , Y=3294748.888 UTM.
 - 8- FOR DETAIL OF BURN PIT & ACCESS ROAD SEE BK-W046S-PEDCO-110-CV-PY-0002

LEGEND & ABBREVIATIONS

D.G.F.T.	DIESEL GENERATOR FUEL TANK
S.R.	SECURITY ROOM
S.G.	SWITCH GEAR
W.T.	WATER TANK
D.G.	DIESEL GENERATOR SHELTER
H.P.P.	HIGH POINT PAVING

-X-X-	FENCE
- - -	MATCH LINE
○	WELL LOCATION
—	SURFACE WATER TRENCH
▨	GRATING

REFERENCE DRAWING	DRG. No.
GENERAL CIVIL LAYOUT - W046S	BK-W046S-PEDCO-110-CV-PY-0001
CIVIL AND STRUCTURAL DRAWINGS - W046S	BK-W046S-PEDCO-110-CV-PY-0002
P&ID - W046S	BK-W046S-PEDCO-110-PR-PI-0001

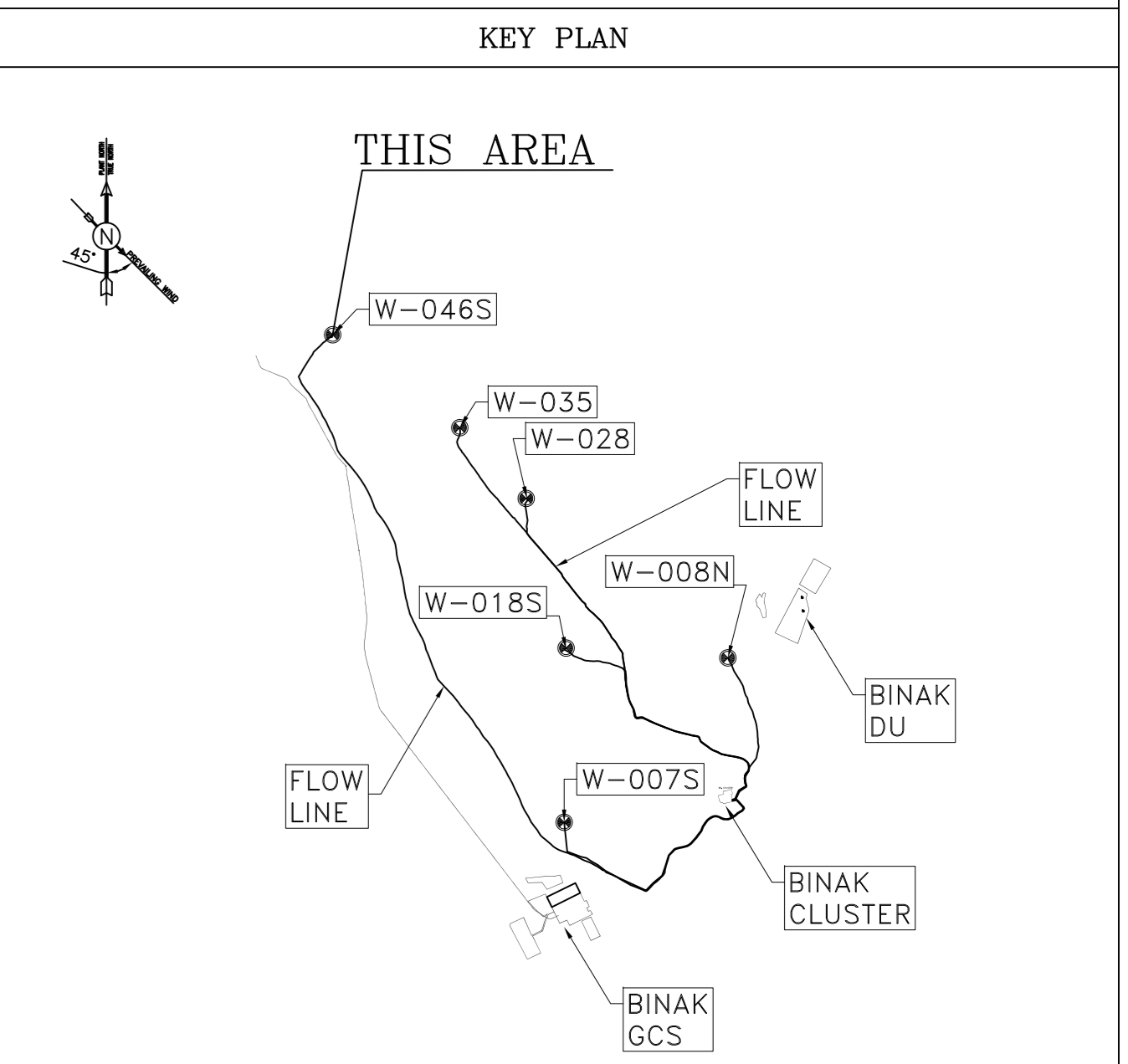

REV.	DESCRIPTION	BY	DATE	BY	DATE

PROJECT NAME: BINAK OILFIELD DEVELOPMENT/SUB-SURFACE WORK PACKAGES W046S WELLHEAD FACILITIES		PROJECT NO.: 971020									
EPC CONTRACTOR: HIRGAN ENERGY - DESIGN & INSPECTION COMPANIES	GENERAL CONTRACTOR: PETROIRAN DEVELOPMENT COMPANY	BINAK OILFIELD DEVELOPMENT SUB-SURFACE WORK PACKAGES W046S WELLHEAD FACILITIES									
DATE	SCALE	DRAWING BY	CHECKED BY	PROJECT ENG.							
DRAWING TITLE: PLOT PLAN DRAWING - W046S		NO CONSTRUCTION PERMITTED UNLESS DRAWING APPROVED									
APPROVED FOR CONSTRUCTION		BY:	DATE:								
SCALE	SIZE	DRAWING NO.	SHEET NO.	REV.	BUDGET REF.	LOCATION	SIZE	CLASS	SERIAL NO.	SHEET	REVISION
AS SHOWN	A0	BK-W046S-PEDCO-110-PI-DW-0001	2 OF 2	D00	053-073-9184	F	5	A	707616	2 OF 2	D00