

SC1/200 1 DETAIL-1

PIPE SLEEPERS LOCATION TABLE

ITEM	TYPE	COORDINATES		T.O.PED
		E (m)	N (m)	
P.S.-01	A	505000	680000	+0.50
P.S.-02	A	505000	674000	+0.50
P.S.-03	A	505000	668000	+0.50
P.S.-04	A	505000	662000	+0.50
P.S.-05	A	505000	656000	+0.50
P.S.-06	A	505000	650000	+0.50
P.S.-07	A	505000	656000	+0.50
P.S.-08	A	505000	638000	+0.50
P.S.-09	A	505000	632000	+0.50
P.S.-10	A	505000	626000	+0.50
P.S.-11	A	505000	620000	+0.50
P.S.-01	B	506000	614000	+0.50
P.S.-02	B	506000	610000	+0.50
P.S.-03	B	506000	602000	+0.50
P.S.-04	B	506000	596000	+0.50
P.S.-05	B	506000	590000	+0.50
P.S.-06	B	503000	587000	+0.50
P.S.-07	B	506000	584000	+0.50
P.S.-08	B	506000	578000	+0.50

PIPE SLEEPERS LOCATION TABLE

ITEM	TYPE	COORDINATES		T.O.PED
		E (m)	N (m)	
P.S.-09	B	506000	572000	+0.50
P.S.-10	B	506000	566000	+0.50
P.S.-11	B	506000	560000	+0.50
P.S.-12	B	506000	554000	+0.50
P.S.-13	B	506000	550000	+0.50
P.S.-14	B	506000	546000	+0.50
P.S.-15	B	506000	542000	+0.50
P.S.-16	B	506000	536000	+0.50
P.S.-17	B	506000	530000	+0.50
P.S.-18	B	506000	524000	+0.50
P.S.-19	B	506000	518000	+0.50
P.S.-20	B	506000	512000	+0.50
P.S.-21	B	509000	507000	+0.50
P.S.-22	B	509000	501000	+0.50
P.S.-23	B	509000	495000	+0.50
P.S.-24	B	509000	489000	+0.50
P.S.-25	B	509000	483000	+0.50
P.S.-26	B	509000	477000	+0.50
P.S.-27	B	509000	471000	+0.50

NOTES

- 1) ALL ELEVATIONS AND COORDINATES ARE IN "m" AND DIMENSIONS ARE IN "mm" UNLESS OTHERWISE NOTED.
- 2) ALL DIMENSIONS AND ELEVATIONS SHALL BE CHECKED BY THE CONTRACTOR PRIOR TO CONSTRUCTION.
- 3) 28 DAYS CHARACTERISTIC COMPRESSIVE STRENGTH OF CONCRETE IS 25MPa. (ON CYLINDRICAL SPECIMEN)
- 4) 28 DAYS CHARACTERISTIC COMPRESSIVE STRENGTH OF LEAN CONCRETE IS 15MPa. (ON CYLINDRICAL SPECIMEN)
- 5) CONCRETE COVER OVER BARS SHALL BE 75mm FOR FOUNDATION AND 40mm FOR CAST IN-SITU OTHER PARTS.
- 6) TENSION STRENGTH OF BARS SHALL BE OF MINIMUM  $f_y=4000 \text{ kg/cm}^2$
- 7) UNDERGROUND CONCRETE SHALL BE PROTECTED AND COATED ACCORDING TO RELEVANT SPECIFICATION.
- 8) CEMENT TYPE II SHALL BE USED ACCORDING TO GEOTECHNICAL REPORT SUGGESTION.
- 9) FILL MATERIAL SHALL BE COMPACTED TO NOT LESS THAN 95% OF (MODIFIED PROCTOR) METHOD.
- 10) REINFORCEMENT SHALL BE ADJUSTED LOCALLY TO SUIT THE RECESS OF ANCHOR BOLTS, HOLES AND OTHER EMBEDDED MATERIALS.
- 11) HEIGHT POINT PAVING ACCORDING MEAN SEA LEVEL.

LEGEND

X=500.000 E=437384.709  
Y=500.000 N=288757.469

REFERENCE DRAWING

DRG. No.
*****

KEY PLAN

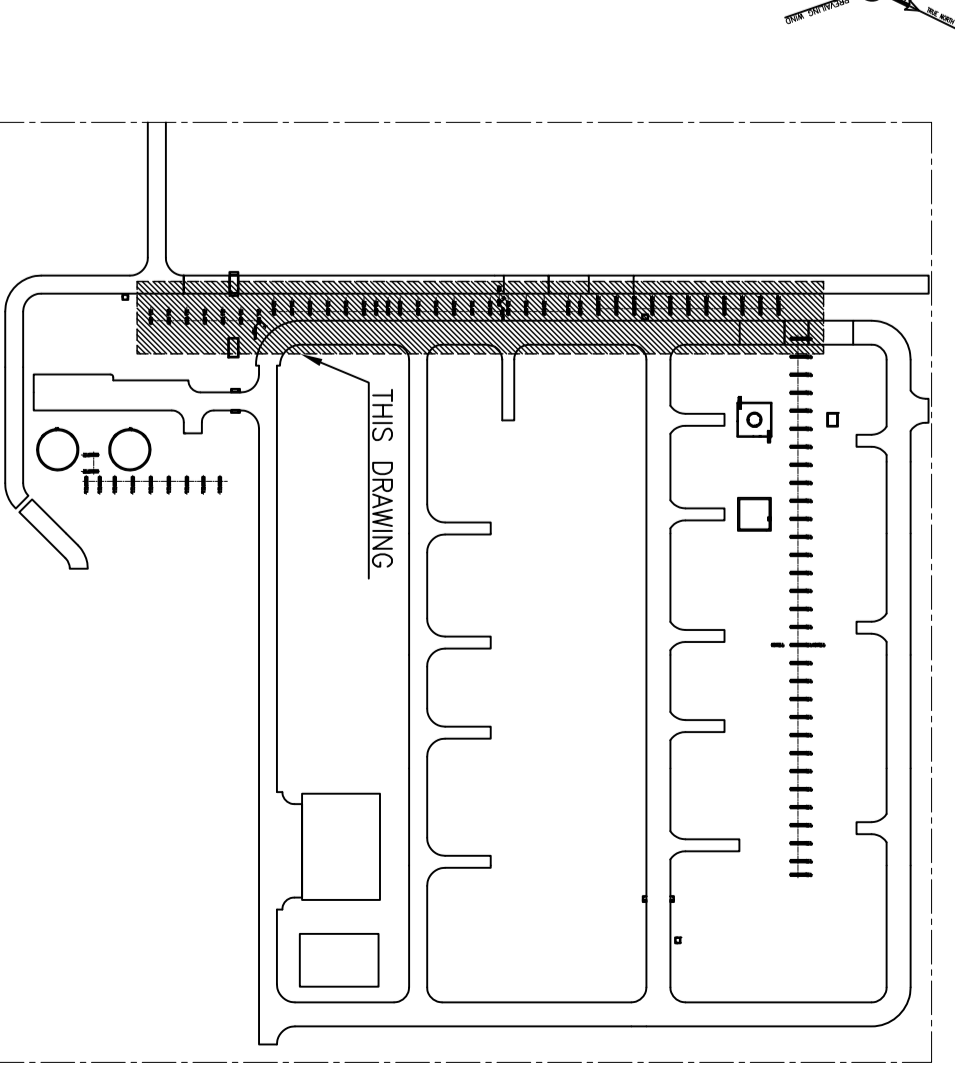

REV.	DESCRIPTION	BY	DATE	BY	DATE
***	*****	***	****	***	****

THE ORIGINAL AND ALL COPIES OF THIS DRAWING TOGETHER WITH THE COPYRIGHT THEREIN ARE THE SOLE PROPERTY OF N.I.S.O.C./ FIELDS

NO CONSTRUCTION PERMITTED UNLESS DRAWING APPROVED  
APPROVED FOR CONSTRUCTION BY: DATE:

<b>PROJECT NAME:</b> BINAK OILFIELD DEVELOPMENT/SURFACE FACILITIES GAS COMPRESSOR STATION <b>PROJECT NO.:</b> 971020	<b>EPC CONTRACTOR:</b> HURGHAN ENERGY - DESIGN & INSPECTION <b>DEVELOPMENT COMPANY:</b> PETROHEAVY DEVELOPMENT COMPANY
<b>DRAWING TITLE:</b> FOUNDATION DRAWING FOR COMPRESS AREA SECONDARY SLEEPER	<b>DRAWING NO:</b> BK-GCS-PEPCO-120-ST-DWG-0046 <b>SHEET NO:</b> 01 OF 03 <b>REV:</b> D00
<b>SCALE:</b> 1:200 <b>SIZE:</b> A0	<b>SCALE:</b> DRAWING BY: CHECKED BY: PROJECT ENG. <b>SCALE:</b> DRAWING BY: CHECKED BY: PROJECT ENG.