

- NOTES**
- ALL COORDINATES ARE IN UTM SYSTEM, ZONE 39.
 - ALL ELEVATION REFERENCES IS MEAN SEA LEVEL.
 - CUT DIMENSIONS ARE IN METERS UNLESS STATED OTHERWISE.
 - CUT DEPTH AND FILL HEIGHT SHOWN IN PLAN ARE ACCORDING TO NATURAL GROUND ELEVATION.
 - THE FILLING VOLUME IS FOR FINAL COMPACTED SOIL (NOT TOTAL REQUIRED SOIL) .
 - 30 cm SPOILED SOIL SHOULD BE REMOVED BEFORE ANY CONSTRUCTIONAL ACTIVITIES IF ANY.
 - CUT & FILL SLOPE IN GRADING AREA IS 1H:2V (200%).
 - HORIZONTAL AND VERTICAL DISTANCES BETWEEN TIK-MARKS IS 5m.
 - R.G.L IN GCS UNIT IS 11.00.
 - R.G.L IN UTILITY AREA IS 11.00.
 - R.G.L IN FLARE AREA IS 11.00.
 - THE SUITABLE MATERIAL FOR FILLING SHALL BE COLLECTED BASED ON TO THE BELOW RULES:
 - PROJECT GEOTECHNICAL INVESTIGATION REPORT, BORROW MATERIALS AND SPECIFICATION STUDY PART.
 - "GENERAL SPECIFICATION FOR ROAD" NO. 101, SECTION 207, IRAN PLANNING AND BUDGET ORGANIZATION.
 - PROJECT GENERAL SPECIFICATION "SPECIFICATION FOR EARTH WORK" DOCUMENT NUMBER "BK-GNRL-PEDCO-000-CV-SP-0004".
 - CLIENT'S SITE SUPERVISORY BODY RECOMMENDATIONS AND APPROVALS.
- GEODETIC PARAMETERS:**
 HORIZONTAL COORDINATE SYSTEM : WGS84 / UTM ZONE 39
 ELLIPSOID : WORLD GEODETIC SYSTEM 1984 (WGS84)
 MAP PROJECTION : UNIVERSAL TRANSVERSE MERCATOR (UTM)
 VERTICAL DATUM : MSL

LEGEND

--- (dashed line)	STAR	--- (thick line)	WATER CHANNEL
--- (dotted line)	TRENCH	--- (wavy line)	RIVER
--- (dotted line)	EMBANKMENT	--- (thick line with arrow)	WATER COURSE
--- (dotted line)	BURNING PIT LINE	--- (dotted line)	CONTOURS
--- (dotted line)	GAS LINE	--- (dotted line)	SPOT HEIGHT
--- (dotted line)	WATER LINE	--- (dotted line)	TRIG POINT
--- (dotted line)	EXISTING BUILDING	--- (dotted line)	BRIDGE
--- (dotted line)	CONCRETE AREA	--- (dotted line)	CULVERT
--- (dotted line)	MANHOLE	--- (dotted line)	WELL LOCATION
--- (dotted line)	LIGHTING PIGLE	--- (dotted line)	WELL
--- (dotted line)	GUARD ROOM	--- (dotted line)	SITE
--- (dotted line)	HELIPAD	--- (dotted line)	CAMP SITE
--- (dotted line)	FENCE	--- (dotted line)	ASPHALT ROAD
--- (dotted line)	TREE	--- (dotted line)	GRAVEL ROAD
--- (dotted line)	FOUNDATION	--- (dotted line)	PROPOSED ROAD
--- (dotted line)	BOUNDARY	--- (dotted line)	TRACK

REFERENCE DRAWING	DRG. No.
SPECIFICATION FOR EARTH WORK	BK-GNRL-PEDCO-220-CV-PY-0001

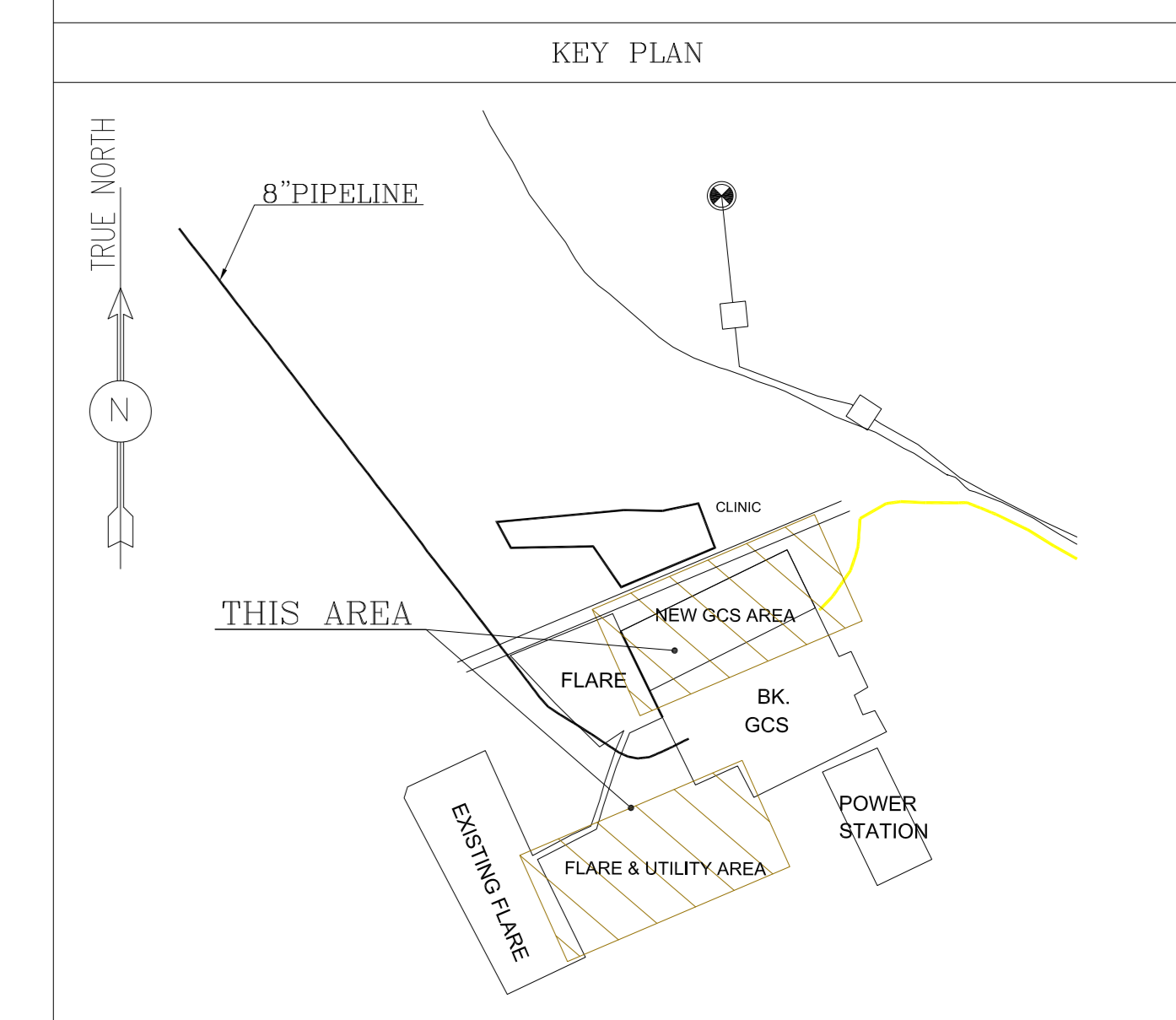

Stations Coordinate

Point	Easting	Northing	Elevation
BT1	437235.882	3290019.26	12.335
BT4	437421.713	3290025.268	10.992
ST5	437435.489	3289980.901	10.986
ST6	437338.947	3289874.973	10.926
ST7	437545.763	3289974.61	11.002

TOPOGRAPHY PLAN
(Sc. 1:1000)

D04	APR. 2023	APC	R.BERLOUIE	M.FAKHARIAN	M.MEHRSHAD	***
D03	OCT. 2022	IFA	R.BERLOUIE	M.FAKHARIAN	M.MEHRSHAD	***
D02	SEP. 2022	IFA	R.BERLOUIE	M.FAKHARIAN	M.MEHRSHAD	***
D01	AUG. 2022	IFA	R.BERLOUIE	M.FAKHARIAN	M.MEHRSHAD	***
D00	MAY. 2022	IFC	R.BERLOUIE	M.FAKHARIAN	M.MEHRSHAD	***
REV.	DATE	P.O.I.S	PREP.	CHK.	APP.	AUT.

اےمل و کلے نسیج این نقشه و حق اقتباس متعلق به شرکت ملی مناطق نفت خیز جنوب میباشد.
 THE ORIGINAL AND ALL COPIES OF THIS DRAWING TOGETHER WITH THE COPYRIGHT THEREIN ARE THE SOLE PROPERTY OF N.I.S.O.C./ FIELDS

PROJECT NAME: BINAK OILFIELD DEVELOPMENT CLIENT SITE CAMP
 PROJECT NO.: 971020
 EPC CONTRACTOR: HIRGAN ENERGY COMPANIES
 EPD/EPC CONTRACTOR(GC): PETROIRAN DEVELOPMENT COMPANY
 DRAWING TITLE: ROUGH GRADING PLAN & DETAILS

SCALE	SIZE	DRAWING NO.	SHEET NO.	REV.
1:1000	A0	BK-GCS-PEDCO-120-CV-PY-0007	01 OF 08	D04

BINAK OILFIELD DEVELOPMENT GENERAL

DATE	SCALE	DRAWING BY	CHECKED BY	PROJECT ENG.

NO CONSTRUCTION PERMITTED UNLESS DRAWING APPROVED

APPROVED FOR CONSTRUCTION	BY:	DATE:			
BUDGET REF.	LOCATION	SIZE CLASS	SERIAL NO.	SHEET	REVISION
053-073-9184	F	5	S	709395	1 D04

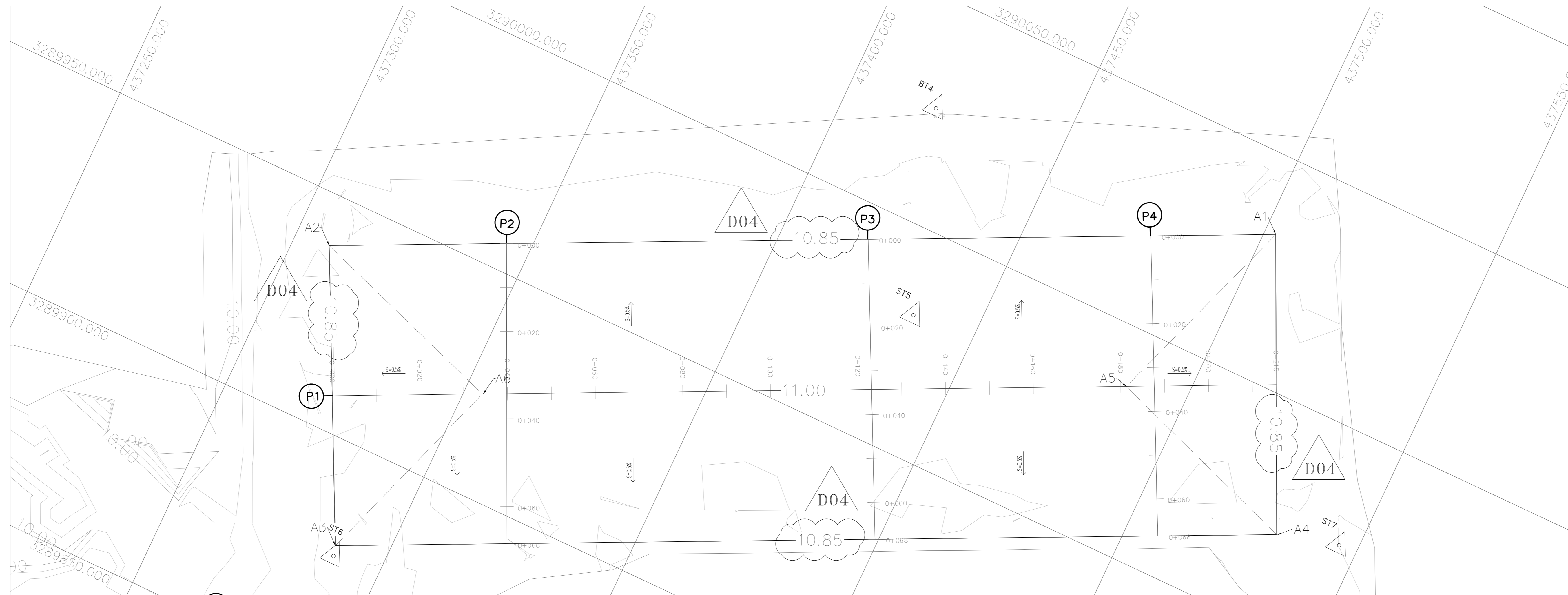
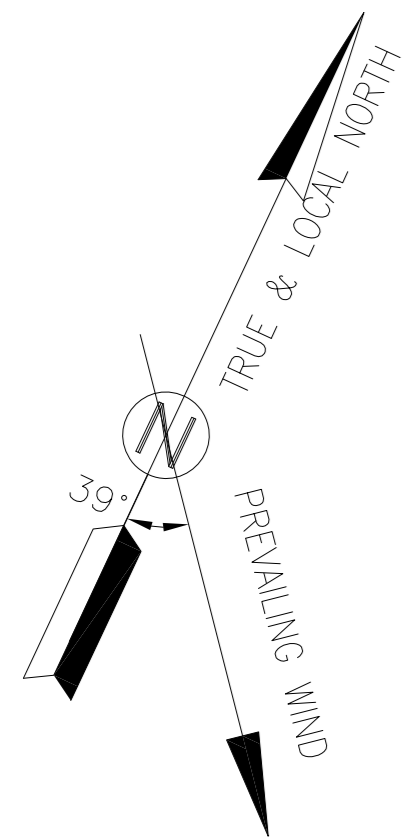

ROUGH GRADING

(Sc. 1:500)

AREA NAME	DESCRIPTION	UTM-COORDINATE (ZONE 39N)			ROUGH GRADING ELEVATION	REMARKS
		NAME	EASTING	NORTHING		
AREA-A	GCS AREA (New GCS)	A1	437502.60	3290032.67	10.85	LOW POINT OF ROUGH-GRADING
		A2	437308.04	3289938.70	10.85	
		A3	437338.35	3289877.28	10.85	
		A4	437531.86	3289970.75	10.85	
		A5	437486.40	3289986.82	11.00	HIGH POINT OF ROUGH-GRADING
		A6	437354.03	3289922.88	11.00	

PROFILE COORDINATES						
AREA NAME	DESCRIPTION	PROFILE NAME	START POINT		END POINT	
			EASTING	NORTHING	EASTING	NORTHING
AREA-A		P1	437323.19	3289907.99	437517.23	3290001.71
		P2	437344.47	3289956.30	437373.61	3289894.33
		P3	437418.80	3289992.20	437449.28	3289930.86
		P4	437476.89	3290020.25	437507.42	3289958.94

- NOTES**
- ALL COORDINATES ARE IN UTM SYSTEM, ZONE 39.
 - ALL ELEVATION REFERENCES IS MEAN SEA LEVEL.
 - ALL DIMENSIONS ARE IN METERS UNLESS STATED OTHERWISE.
 - CUT DEPTH AND FILL HEIGHT SHOWN IN PLAN ARE ACCORDING TO NATURAL GROUND ELEVATION.
 - THE FILLING VOLUME IS FOR FINAL COMPACTED SOIL (NOT TOTAL REQUIRED SOIL).
 - 30 cm SPOILED SOIL SHOULD BE REMOVED BEFORE ANY CONSTRUCTIONAL ACTIVITIES IF ANY.
 - CUT & FILL SLOPE IN GRADING AREA IS 1H:2V (200%).
 - HORIZONTAL AND VERTICAL DISTANCES BETWEEN TIK-MARKS IS 5m.
 - R.G.L IN GCS UNIT IS 11.00.
 - R.G.L IN UTILITY AREA IS 11.00.
 - R.G.L IN FLARE AREA IS 11.00.
 - THE SUITABLE MATERIAL FOR FILLING SHALL BE COLLECTED BASED ON TO THE BELOW RULES:
 - PROJECT GEOTECHNICAL INVESTIGATION REPORT, BORROW MATERIALS AND SPECIFICATION STUDY PART.
 - "GENERAL SPECIFICATION FOR ROAD" NO. 101, SECTION 207, IRAN PLANNING AND BUDGET ORGANIZATION.
 - PROJECT GENERAL SPECIFICATION "SPECIFICATION FOR EARTH WORK" DOCUMENT NUMBER "BK-GNRL-PEDCO-000-CV-SP-004".
 - CLIENT'S SITE SUPERVISORY BODY RECOMMENDATIONS AND APPROVALS.
- GEODETIC PARAMETERS:**
 HORIZONTAL COORDINATE SYSTEM : WGS84 / UTM ZONE 39
 ELLIPSOID : WORLD GEODETIC SYSTEM 1984 (WGS84)
 MAP PROJECTION : UNIVERSAL TRANSVERSE MERCATOR (UTM)
 VERTICAL DATUM : MSL

LEGEND

STAIR	EMBANKMENT	BURNING PIT LINE	GAS LINE	WATER LINE	EXISTING BUILDING	CONCRETE AREA	MANHOLE	LIGHTING PIGLE	GUARD ROOM	HELIPAD	FENCE	TREE	FOUNDATION	BOUNDARY	WATER CHANNEL	RIVER	WATER COURSE	CONTOURS	SPOT HEIGHT	TRIG POINT	BRIDGE	CULVERT	WELL LOCATION	WELL	SITE	CAMP SITE	ASPHALT ROAD	GRAVEL ROAD	PROPOSED ROAD	TRACK	ROUGH GRADING CONTOUR	SLOPE LIMIT DIRECTION
-------	------------	------------------	----------	------------	-------------------	---------------	---------	----------------	------------	---------	-------	------	------------	----------	---------------	-------	--------------	----------	-------------	------------	--------	---------	---------------	------	------	-----------	--------------	-------------	---------------	-------	-----------------------	-----------------------

REFERENCE DRAWING	DRG. No.
SPECIFICATION FOR EARTH WORK	BK-GNRL-PEDCO-220-CV-PY-0001

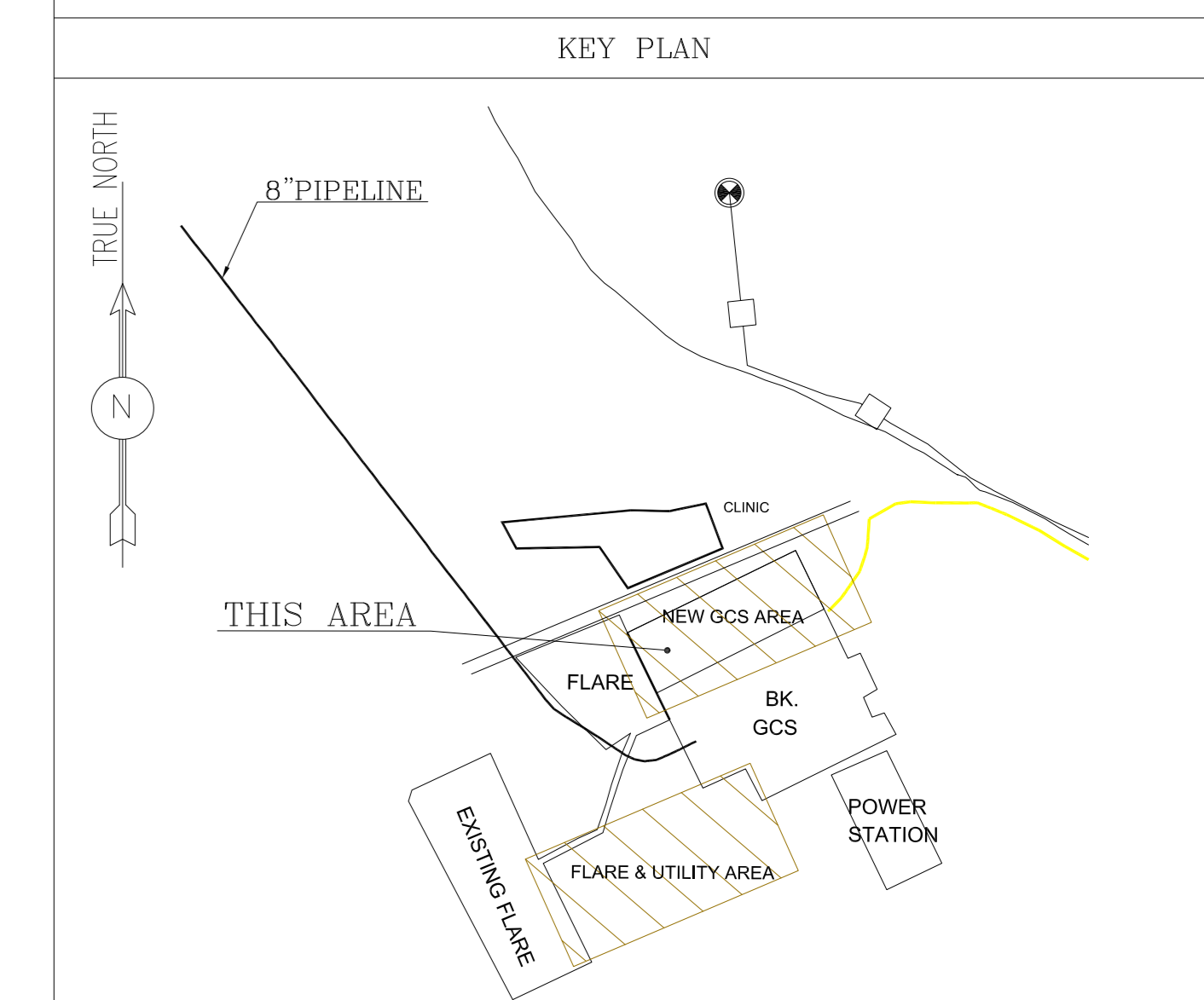

D04	APR. 2023	APC	R.BERLOUIE	M.FAKHARIAN	M.MEHRSHAD	***
D03	OCT. 2022	IFA	R.BERLOUIE	M.FAKHARIAN	M.MEHRSHAD	**
D02	SEP. 2022	IFA	R.BERLOUIE	M.FAKHARIAN	M.MEHRSHAD	***
D01	AUG. 2022	IFA	R.BERLOUIE	M.FAKHARIAN	M.MEHRSHAD	***
D00	MAY. 2022	IFC	R.BERLOUIE	M.FAKHARIAN	M.MEHRSHAD	**
REV.	DATE	P.O.I.S	PREP.	CHK.	APP.	AUT.

اعمال و کلیه نسخ این نقشه و حق اقتباس متعلق به شرکت ماسی مناطق نفت خیز جنوب میباشد.
 THE ORIGINAL AND ALL COPIES OF THIS DRAWING TOGETHER WITH THE COPYRIGHT THEREIN ARE THE SOLE PROPERTY OF N.I.S.O.C./ FIELDS

PROJECT NAME:		BINAK OILFIELD DEVELOPMENT CLIENT SITE CAMP			
PROJECT NO.:		971020			
EPC CONTRACTOR:		EPD/EPC CONTRACTOR(GC):			
 HIRGAN ENERGY - DESIGN & INSPECTION COMPANIES		 PETROIRAN DEVELOPMENT COMPANY			
DRAWING TITLE:		ROUGH GRADING PLAN & DETAILS			
DRAWING TITLE:		NO CONSTRUCTION PERMITTED UNLESS DRAWING APPROVED			
APPROVED FOR CONSTRUCTION		BY:		DATE:	
SCALE	SIZE	DRAWING NO.	SHEET NO.	REV.	
1:500	A0	BK-GCS-PEDCO-120-CV-PY-0007	02 OF 08	D04	
BUDGET REF.	LOCATION	SIZE CLASS	SERIAL NO.	SHEET	REVISION
053-073-9184	F	5	S	709395	2

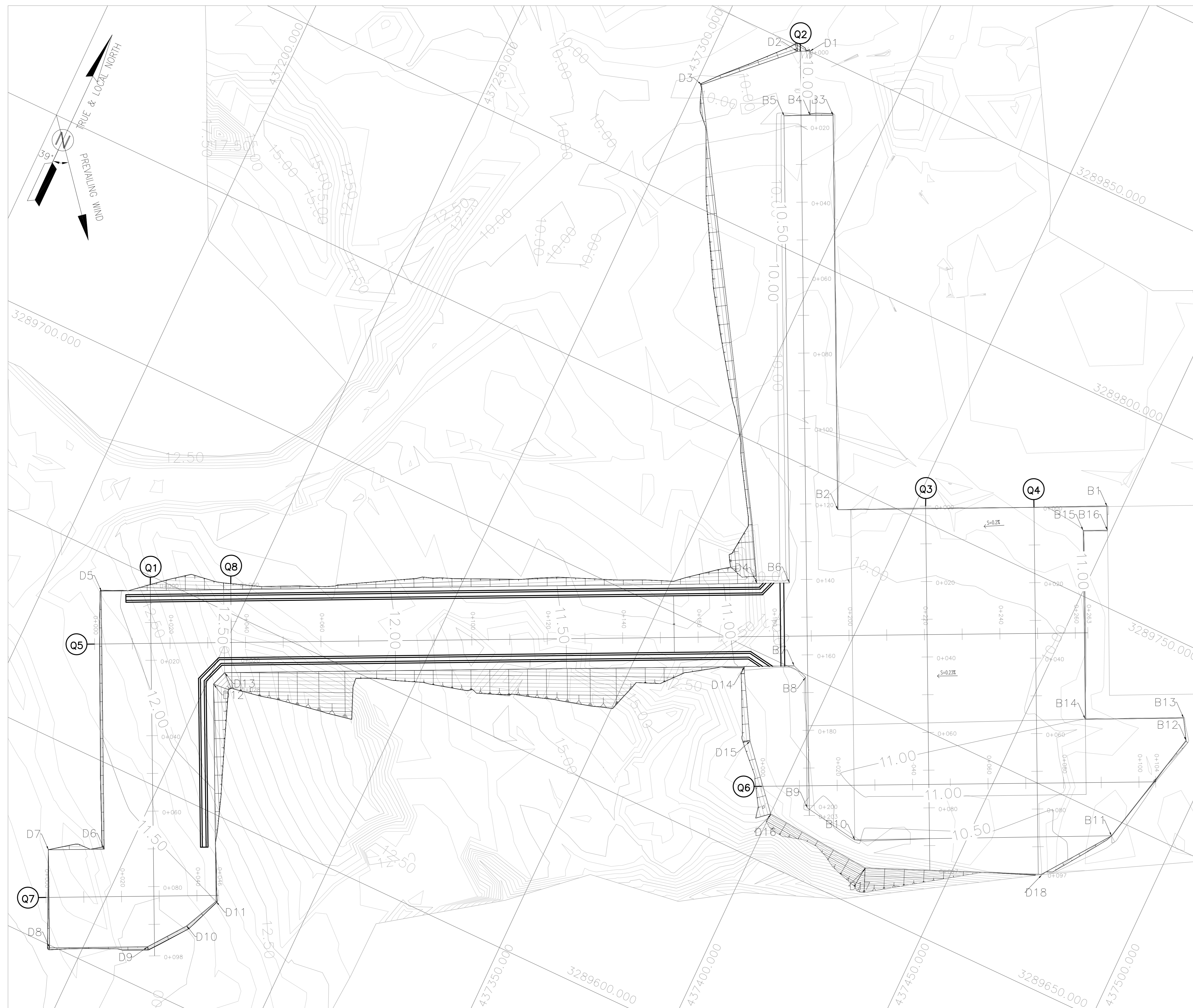

AREA NAME	DESCRIPTION	UTM-COORDINATE (ZONE 39N)			ROUGH GRADING ELEVATION
		NAME	EASTING	NORTHING	
AREA-B	UTILITY UNIT & SLEEPER WAY AREA	B1	437446.27	3289774.21	11.02
		B2	437381.98	3289743.13	10.93
		B3	437336.51	3289837.27	10.93
		B4	437331.01	3289834.71	10.85
		B5	437324.81	3289831.62	10.80
		B6	437378.67	3289720.12	10.80
		B7	437389.14	3289700.75	10.83
		B8	437393.14	3289699.35	10.83
		B9	437408.21	3289668.15	10.83
		B10	437423.19	3289665.78	10.83
		B11	437484.41	3289695.65	10.83
		B12	437491.58	3289726.91	10.87
		B13	437488.44	3289732.03	10.93
		B14	437465.01	3289720.71	11.00
		B15	437443.27	3289765.77	11.00
		B16	437449.02	3289768.54	11.02

AREA NAME	DESCRIPTION	UTM-COORDINATE (ZONE 39N)			ROUGH GRADING ELEVATION
		NAME	EASTING	NORTHING	
AREA-D	ACCESS ROAD TO FLARE AND NEW FLARE AREA	D1	437323.68	3289850.07	10.85
		D2	437320.79	3289848.68	9.64
		D3	437301.50	3289829.84	9.67
		D4	437370.86	3289716.35	10.91
		D5	437214.33	3289640.75	11.90
		D6	437244.08	3289579.16	11.20
		D7	437230.76	3289572.72	11.10
		D8	437242.06	3289549.31	11.10
		D9	437265.48	3289560.62	11.20
		D10	437272.53	3289570.02	11.40
		D11	437276.82	3289579.20	11.50
		D12	437251.77	3289631.07	12.48
		D13	437253.17	3289635.07	12.50
		D14	437377.20	3289694.98	10.98
		D15	437386.90	3289677.83	10.08
		D16	437400.12	3289662.59	10.14
		D17	437428.86	3289660.26	10.20
		D18	437471.88	3289678.52	10.30

- NOTES**
- ALL COORDINATES ARE IN UTM SYSTEM, ZONE 39.
 - ALL ELEVATION REFERENCES IS MEAN SEA LEVEL.
 - ALL DIMENSIONS ARE IN METERS UNLESS STATED OTHERWISE.
 - CUT DEPTH AND FILL HEIGHT SHOWN IN PLAN ARE ACCORDING TO NATURAL GROUND ELEVATION.
 - THE FILLING VOLUME IS FOR FINAL COMPACTED SOIL (NOT TOTAL REQUIRED SOIL).
 - 30 cm SPOILED SOIL SHOULD BE REMOVED BEFORE ANY CONSTRUCTIONAL ACTIVITIES IF ANY.
 - CUT & FILL SLOPE IN GRADING AREA IS 1H:2V (200%).
 - HORIZONTAL AND VERTICAL DISTANCES BETWEEN TIK-MARKS IS 5m.
 - R.G.L IN GCS UNIT IS 11.00.
 - R.G.L IN UTILITY AREA IS 11.00.
 - R.G.L IN FLARE AREA IS 11.00.
 - THE SUITABLE MATERIAL FOR FILLING SHALL BE COLLECTED BASED ON TO THE BELOW RULES:
 - PROJECT GEOTECHNICAL INVESTIGATION REPORT, BORROW MATERIALS AND SPECIFICATION STUDY PART.
 - "GENERAL SPECIFICATION FOR ROAD" NO. 101, SECTION 207, IRAN PLANNING AND BUDGET ORGANIZATION.
 - PROJECT GENERAL SPECIFICATION "SPECIFICATION FOR EARTH WORK" DOCUMENT NUMBER "BK-GNRL-PEDCO-000-CV-SP-0004".
 - CLIENT'S SITE SUPERVISORY BODY RECOMMENDATIONS AND APPROVALS.

GEODETIC PARAMETERS:

HORIZONTAL COORDINATE SYSTEM : WGS84 / UTM ZONE 39
 ELLIPSOID : WORLD GEODETIC SYSTEM 1984 (WGS84)
 MAP PROJECTION : UNIVERSAL TRANSVERSE MERCATOR (UTM)
 VERTICAL DATUM : MSL

LEGEND

--- STAR	--- WATER CHANNEL
--- EMBANKMENT	--- RIVER
--- BURNING PIT LINE	--- WATER COURSE
--- GAS LINE	--- CONTOURS
--- WATER LINE	--- SPOT HEIGHT
--- EXISTING BUILDING	--- TRIC POINT
--- CONCRETE AREA	--- BRIDGE
--- MANHOLE	--- CULVERT
--- LIGHTING PIGLE	--- WELL LOCATION
--- GUARD ROOM	--- WELL
--- HELIPAD	--- SITE
--- FENCE	--- CAMP SITE
--- TREE	--- ASPHALT ROAD
--- FOUNDATION	--- GRAVEL ROAD
--- BOUNDARY	--- PROPOSED ROAD
	--- TRACK
	--- ROUGH GRADING CONTOUR
	--- SLOPE LIMIT DIRECTION

REFERENCE DRAWING	DRG. No.
SPECIFICATION FOR EARTH WORK	BK-GNRL-PEDCO-220-CV-PY-0001

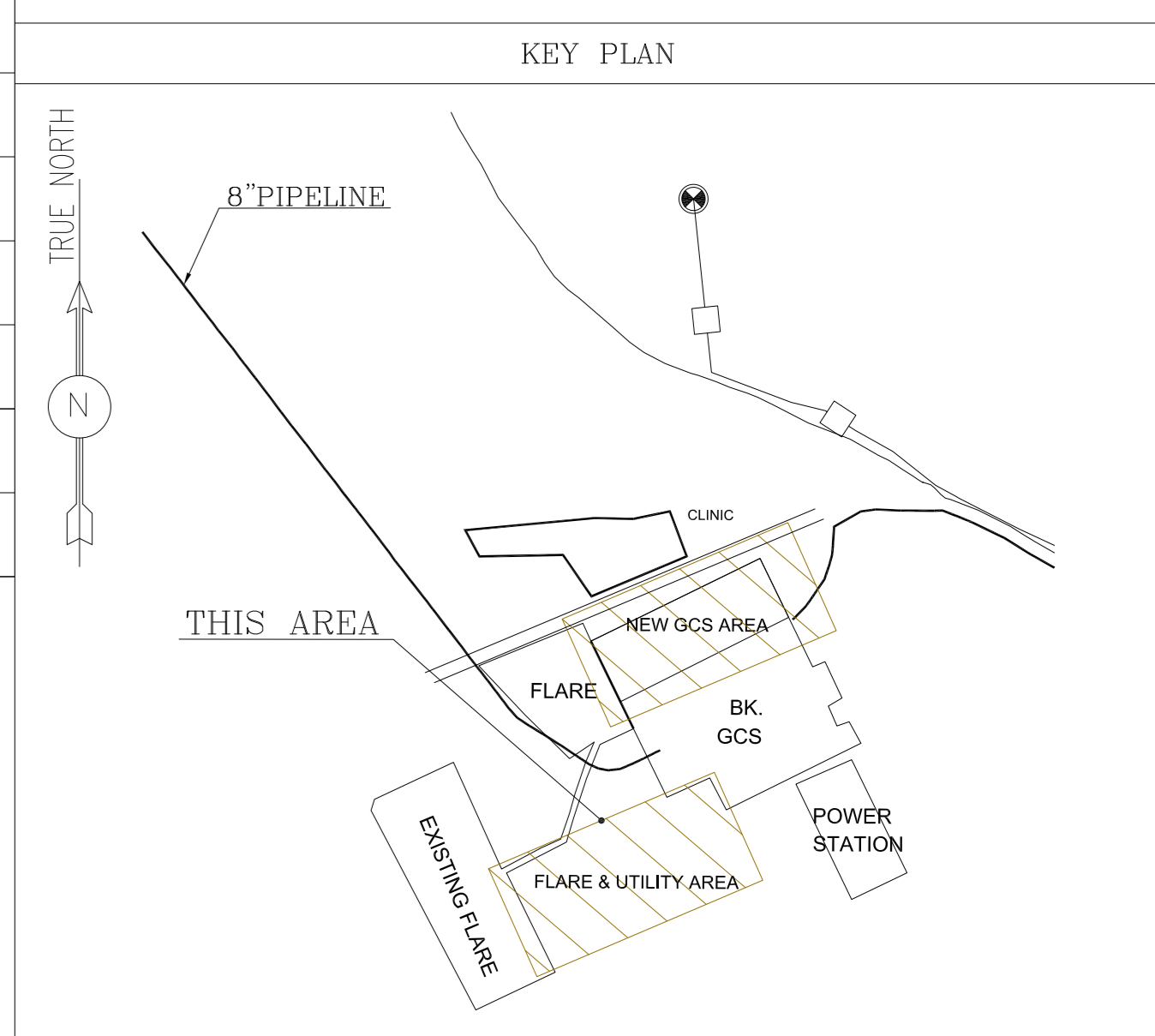

ROUGH GRADING

(Sc. 1:500)

PROFILE COORDINATES						
AREA NAME	DESCRIPTION	PROFILE NAME	START POINT		END POINT	
			EASTING	NORTHING	EASTING	NORTHING
AREA-B	UTILITY UNIT & SLEEPER WAY AREA & FLARE AREA	Q1	437225.36	3289647.80	437268.15	3289559.22
		Q2	437321.39	3289848.97	437409.53	3289666.55
		Q3	437402.63	3289753.90	437444.63	3289666.95
		Q4	437428.78	3289765.82	437471.11	3289678.18
		Q5	437218.67	3289627.32	437455.84	3289741.74
		Q6	437394.82	3289668.21	437488.87	3289713.59
		Q7	437235.52	3289561.04	437276.73	3289580.95
		Q8	437244.56	3289657.10	437256.65	3289632.08

D04	APR.2023	APC	R.BERLOUIR	M.PAKHARIAN	M.MEHRSHAD	***
D03	OCT.2022	IFA	R.BERLOUIR	M.PAKHARIAN	M.MEHRSHAD	***
D02	SEP.2022	IFA	R.BERLOUIR	M.PAKHARIAN	M.MEHRSHAD	***
D01	AUG.2022	IFA	R.BERLOUIR	M.PAKHARIAN	M.MEHRSHAD	***
D00	MAY.2022	IFC	R.BERLOUIR	M.PAKHARIAN	M.MEHRSHAD	***
REV.	DATE	P.O.I.S	PREP.	CHK.	APP.	AUT.

PROJECT NAME: BINAK OILFIELD DEVELOPMENT CLIENT SITE CAMP
 PROJECT NO.: 971020

EPC CONTRACTOR: HIRGAN ENERGY TE
 EPD/EPC CONTRACTOR(GC): PETROIRAN DEVELOPMENT COMPANY PEDCO

DRAWING TITLE: ROUGH GRADING PLAN & DETAILS

NO CONSTRUCTION PERMITTED UNLESS DRAWING APPROVED

DATE	SCALE	DRAWING BY	CHECKED BY	PROJECT ENG.

APPROVED FOR CONSTRUCTION BY: DATE:

BUDGET REF.	LOCATION	SIZE CLASS	SERIAL NO.	SHEET	REVISION
1:500	A0	BK-GCS-PEDCO-120-CV-PY-0007	03 OF 08	D04	053-073-9184

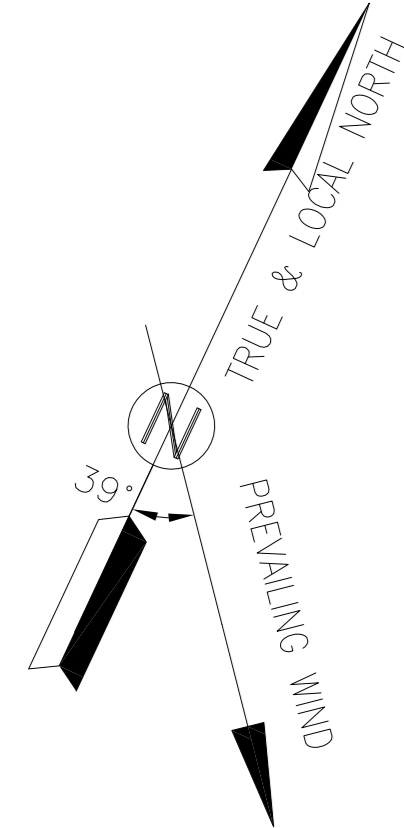

- NOTES**
- ALL COORDINATES ARE IN UTM SYSTEM, ZONE 39.
 - ALL ELEVATION REFERENCES IS MEAN SEA LEVEL.
 - ALL DIMENSIONS ARE IN METERS UNLESS STATED OTHERWISE.
 - CUT DEPTH AND FILL HEIGHT SHOWN IN PLAN ARE ACCORDING TO NATURAL GROUND ELEVATION.
 - THE FILLING VOLUME IS FOR FINAL COMPACTED SOIL (NOT TOTAL REQUIRED SOIL) .
 - 30 cm SPOILED SOIL SHOULD BE REMOVED BEFORE ANY CONSTRUCTIONAL ACTIVITIES IF ANY.
 - CUT & FILL SLOPE IN GRADING AREA IS 1H:2V (200%).
 - HORIZONTAL AND VERTICAL DISTANCES BETWEEN TIK-MARKS IS 5m.
 - R.G.L IN GCS UNIT IS 11.00.
 - R.G.L IN UTILITY AREA IS 11.00.
 - R.G.L IN FLARE AREA IS 11.00.
 - THE SUITABLE MATERIAL FOR FILLING SHALL BE COLLECTED BASED ON TO THE BELOW RULES:
 - PROJECT GEOTECHNICAL INVESTIGATION REPORT, BORROW MATERIALS AND SPECIFICATION STUDY PART.
 - "GENERAL SPECIFICATION FOR ROAD" NO. 101, SECTION 207, IRAN PLANNING AND BUDGET ORGANIZATION.
 - PROJECT GENERAL SPECIFICATION "SPECIFICATION FOR EARTH WORK" DOCUMENT NUMBER "BK-GNRL-PEDCO-000-CV-SP-0004".
 - CLIENT'S SITE SUPERVISORY BODY RECOMMENDATIONS AND APPROVALS.
- GEODETIC PARAMETERS:**
 HORIZONTAL COORDINATE SYSTEM : WGS84 / UTM ZONE 39
 ELLIPSOID : WORLD GEODETIC SYSTEM 1984 (WGS84)
 MAP PROJECTION : UNIVERSAL TRANSVERSE MERCATOR (UTM)
 VERTICAL DATUM : MSL

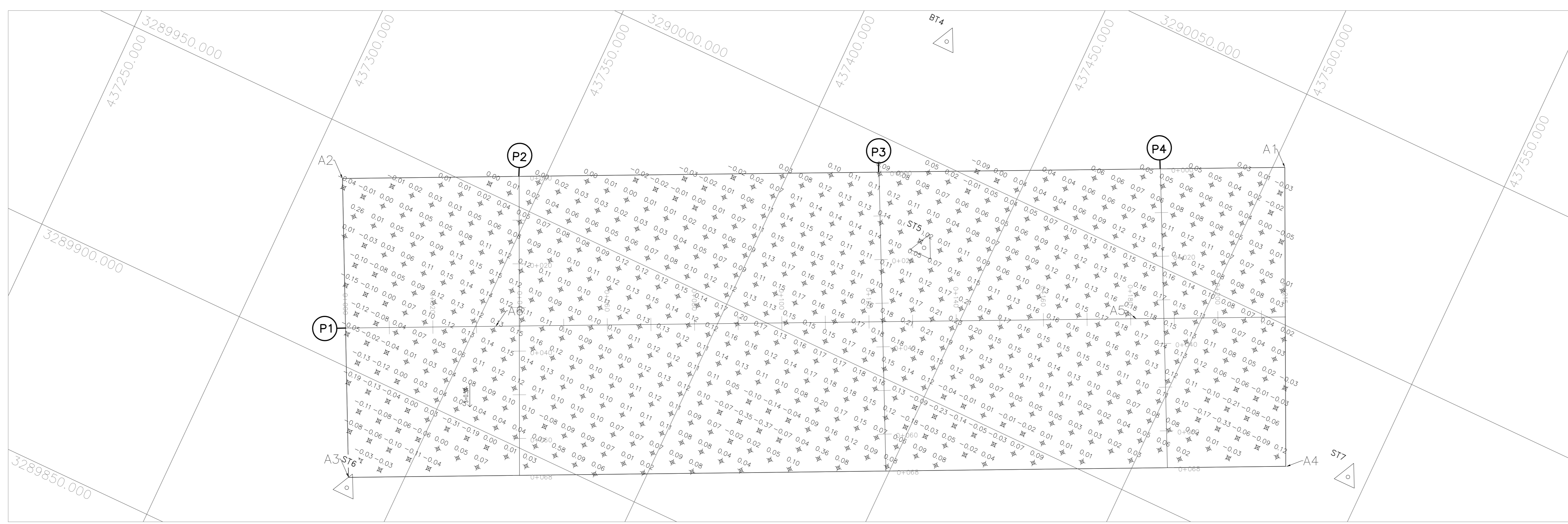

LEGEND

STAIR	WATER CHANNEL
EMBANKMENT	RIVER
BURNING PIT LINE	WATER COURSE
GAS LINE	CONTOURS
WATER LINE	99.27 SPOT HEIGHT
EXISTING BUILDING	TRIG POINT
CONCRETE AREA	BRIDGE
MANHOLE	CULVERT
LIGHTING PIGLE	WELL LOCATION
GUARD ROOM	WELL
HELIPAD	SITE
FENCE	CAMP SITE
TREE	ASPHALT ROAD
FOUNDATION	GRAVEL ROAD
BOUNDARY	PROPOSED ROAD
	TRACK
	ROUGH GRADING CONTOUR
	SLOPE LIMIT DIRECTION

CUT & FILL

(Sc. 1:500)

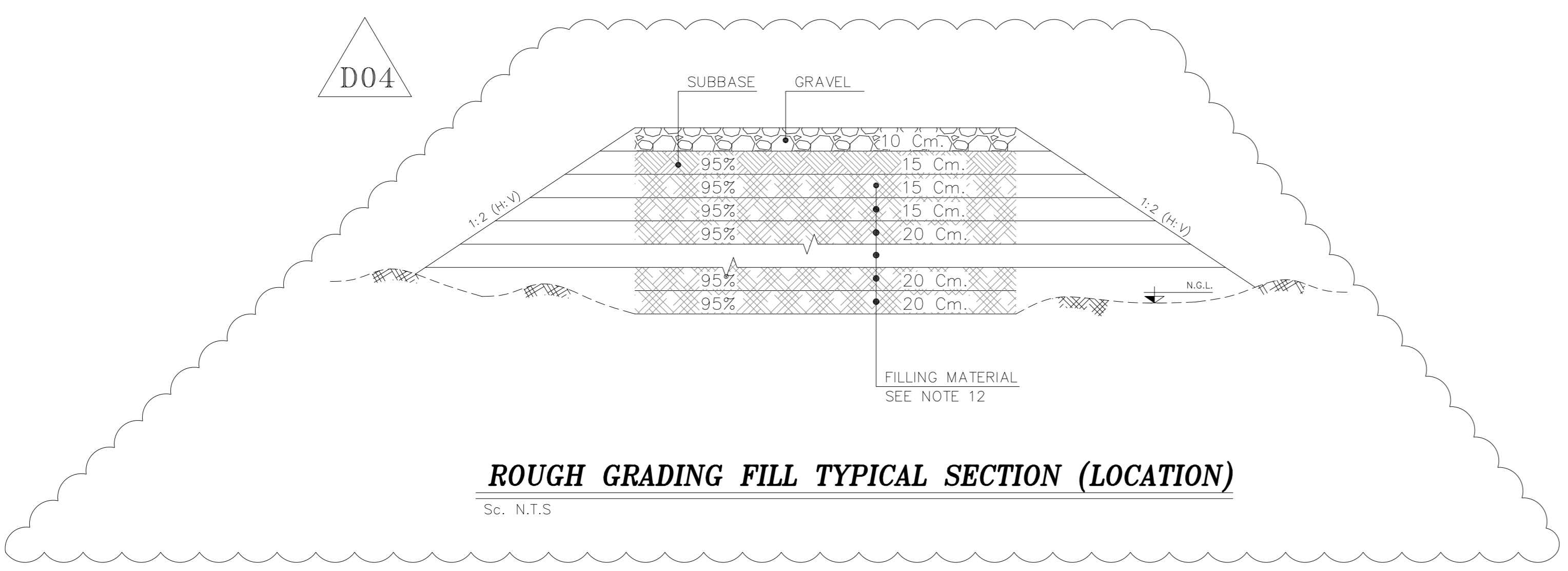

REFERENCE DRAWING	DRG. No.
SPECIFICATION FOR EARTH WORK	BK-GNRL-PEDCO-220-CV-PY-0001

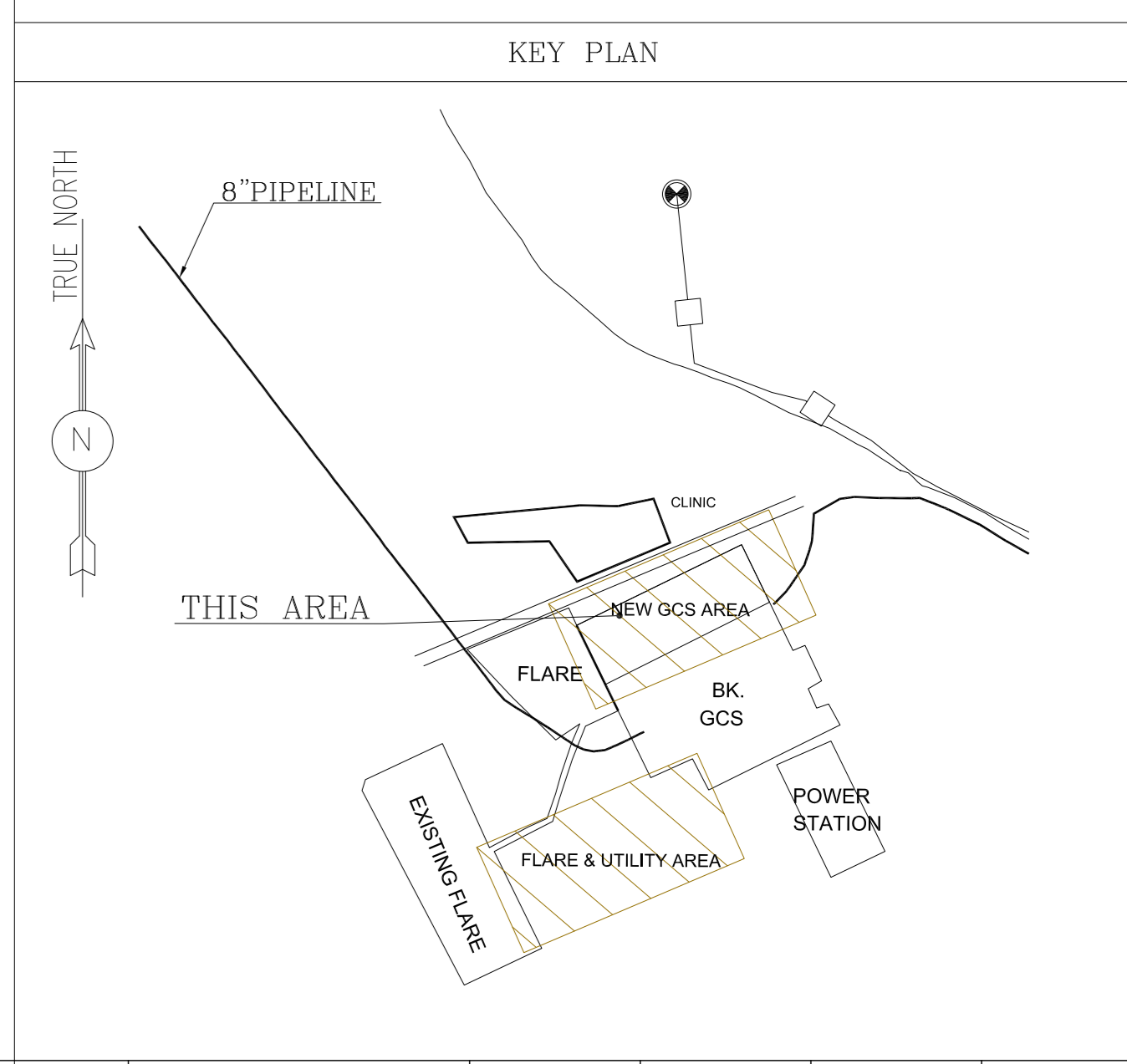

D04	APR.2023	APC	R.BERLOUIR	M.FAKHARIAN	M.MEHRSHAD	***
D03	OCT.2022	IFA	R.BERLOUIR	M.FAKHARIAN	M.MEHRSHAD	**
D02	SEP.2022	IFA	R.BERLOUIR	M.FAKHARIAN	M.MEHRSHAD	***
D01	AUG.2022	IFA	R.BERLOUIR	M.FAKHARIAN	M.MEHRSHAD	***
D00	MAY.2022	IFC	R.BERLOUIR	M.FAKHARIAN	M.MEHRSHAD	**
REV.	DATE	P.O.I.S	PREP.	CHK.	APP.	AUT.

اخذ و کليه نسخ این نقشه و حق اقتباس متعلق به شرکت ملی مناطق نفت خیز جنوب میباشد.
 THE ORIGINAL AND ALL COPIES OF THIS DRAWING TOGETHER WITH THE COPYRIGHT THEREIN ARE THE SOLE PROPERTY OF N.I.S.O.C./ FIELDS

PROJECT NAME:		BINAK OILFIELD DEVELOPMENT CLIENT SITE CAMP			
PROJECT NO.:		971020			
EPC CONTRACTOR:		EPD/EPC CONTRACTOR(GC):			
HIRGAN ENERGY - DESIGN & INSPECTION COMPANIES		PETROIRAN DEVELOPMENT COMPANY			
DRAWING TITLE:		ROUGH GRADING PLAN & DETAILS			
NO CONSTRUCTION PERMITTED UNLESS DRAWING APPROVED					
APPROVED FOR CONSTRUCTION		BY:		DATE:	
SCALE	SIZE	DRAWING NO.	SHEET NO.	REV.	
1:500	A0	BK-GCS-PEDCO-120-CV-PY-0007	04 OF 08	D04	
BUDGET REF.	LOCATION	SIZE CLASS	SERIAL NO.	SHEET	REVISION
053-073-9184	F	5	S	709395	4

BINAK OILFIELD DEVELOPMENT GENERAL				
DATE	SCALE	DRAWING BY	CHECKED BY	PROJECT ENG.

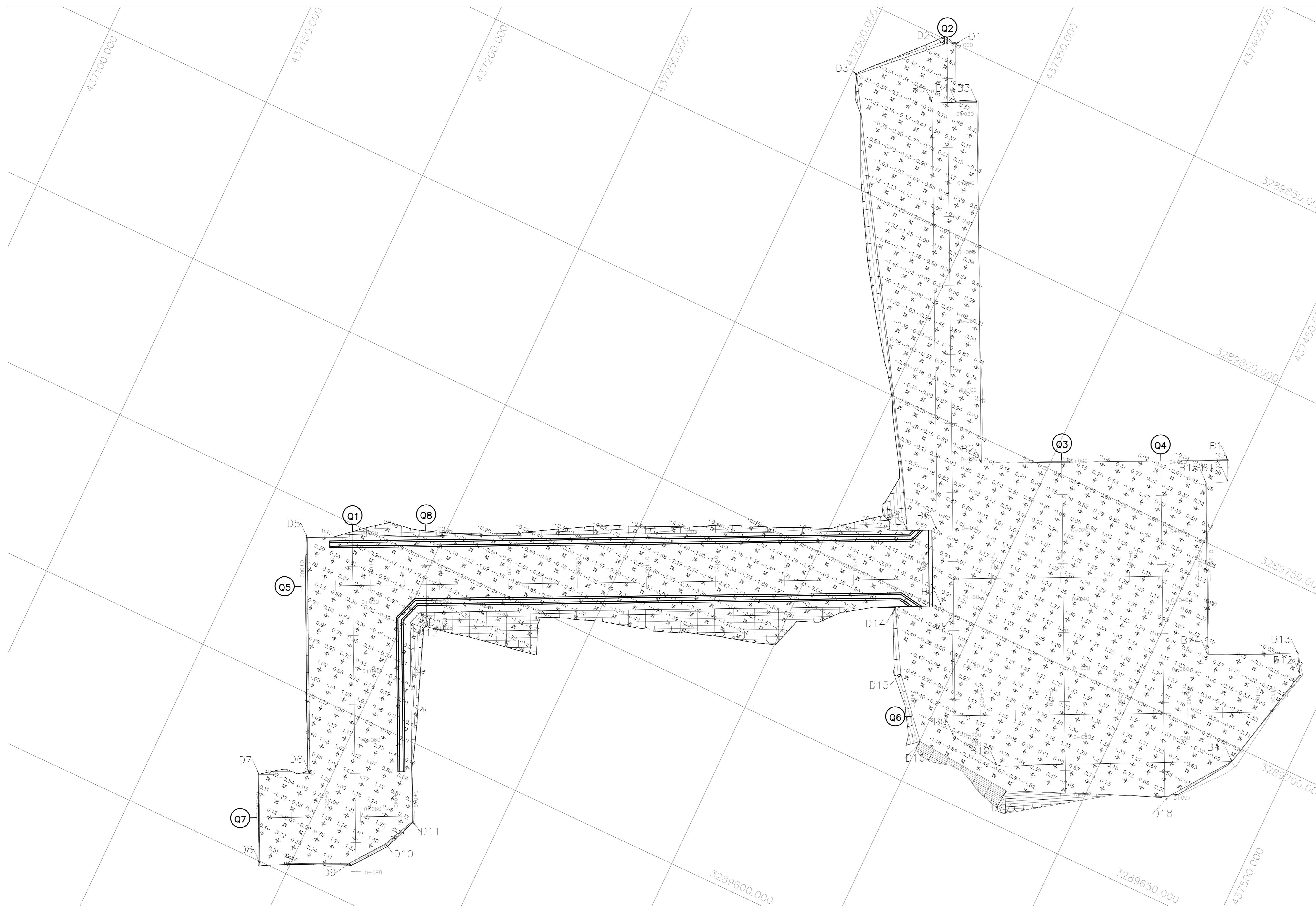
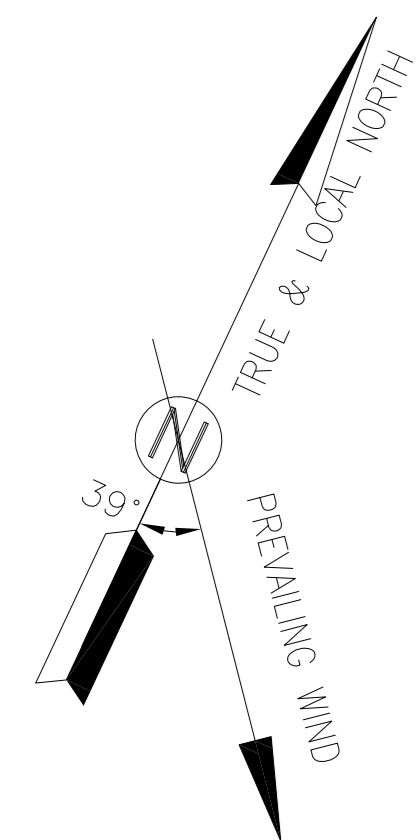

- NOTES**
1. ALL COORDINATES ARE IN UTM SYSTEM, ZONE 39.
 2. ALL ELEVATION REFERENCES IS MEAN SEA LEVEL.
 3. ALL DIMENSIONS ARE IN METERS UNLESS STATED OTHERWISE.
 4. CUT DEPTH AND FILL HEIGHT SHOWN IN PLAN ARE ACCORDING TO NATURAL GROUND ELEVATION.
 5. THE FILLING VOLUME IS FOR FINAL COMPACTED SOIL (NOT TOTAL REQUIRED SOIL) .
 6. 30 cm SPOILED SOIL SHOULD BE REMOVED BEFORE ANY CONSTRUCTIONAL ACTIVITIES IF ANY.
 7. CUT & FILL SLOPE IN GRADING AREA IS 1H:2V (200%).
 8. HORIZONTAL AND VERTICAL DISTANCES BETWEEN TIK-MARKS IS 5m.
 9. R.G.L IN GCS UNIT IS 11.00.
 10. R.G.L IN UTILITY AREA IS 11.00.
 11. R.G.L IN FLARE AREA IS 11.00.
 12. THE SUITABLE MATERIAL FOR FILLING SHALL BE COLLECTED BASED ON TO THE BELOW RULES:
 - PROJECT GEOTECHNICAL INVESTIGATION REPORT, BORROW MATERIALS AND SPECIFICATION STUDY PART.
 - "GENERAL SPECIFICATION FOR ROAD" NO. 101, SECTION 207, IRAN PLANNING AND BUDGET ORGANIZATION.
 - PROJECT GENERAL SPECIFICATION "SPECIFICATION FOR EARTH WORK" DOCUMENT NUMBER "BK-GNRL-PEDCO-000-CV-SP-0004".
 - CLIENT'S SITE SUPERVISORY BODY RECOMMENDATIONS AND APPROVALS.
- GEODETIC PARAMETERS:**
 HORIZONTAL COORDINATE SYSTEM : WGS84 / UTM ZONE 39
 ELLIPSOID : WORLD GEODETIC SYSTEM 1984 (WGS84)
 MAP PROJECTION : UNIVERSAL TRANSVERSE MERCATOR (UTM)
 VERTICAL DATUM : MSL

LEGEND

STAIR	WATER CHANNEL
EMBANKMENT	RIVER
BURNING PIT LINE	WATER COURSE
GAS LINE	CONTOURS
WATER LINE	99.27 SPOT HEIGHT
EXISTING BUILDING	TRIC POINT
CONCRETE AREA	BRIDGE
MANHOLE	CULVERT
LIGHTING PIGLE	WELL LOCATION
GUARD ROOM	WELL
HELIPAD	SITE
FENCE	CAMP SITE
TREE	ASPHALT ROAD
FOUNDATION	GRAVEL ROAD
BOUNDARY	PROPOSED ROAD
	TRACK
	ROUGH GRADING CONTOUR
	SLOPE LIMIT DIRECTION

REFERENCE DRAWING	DRG. No.
SPECIFICATION FOR EARTH WORK	BK-GNRL-PEDCO-220-CV-PY-0001

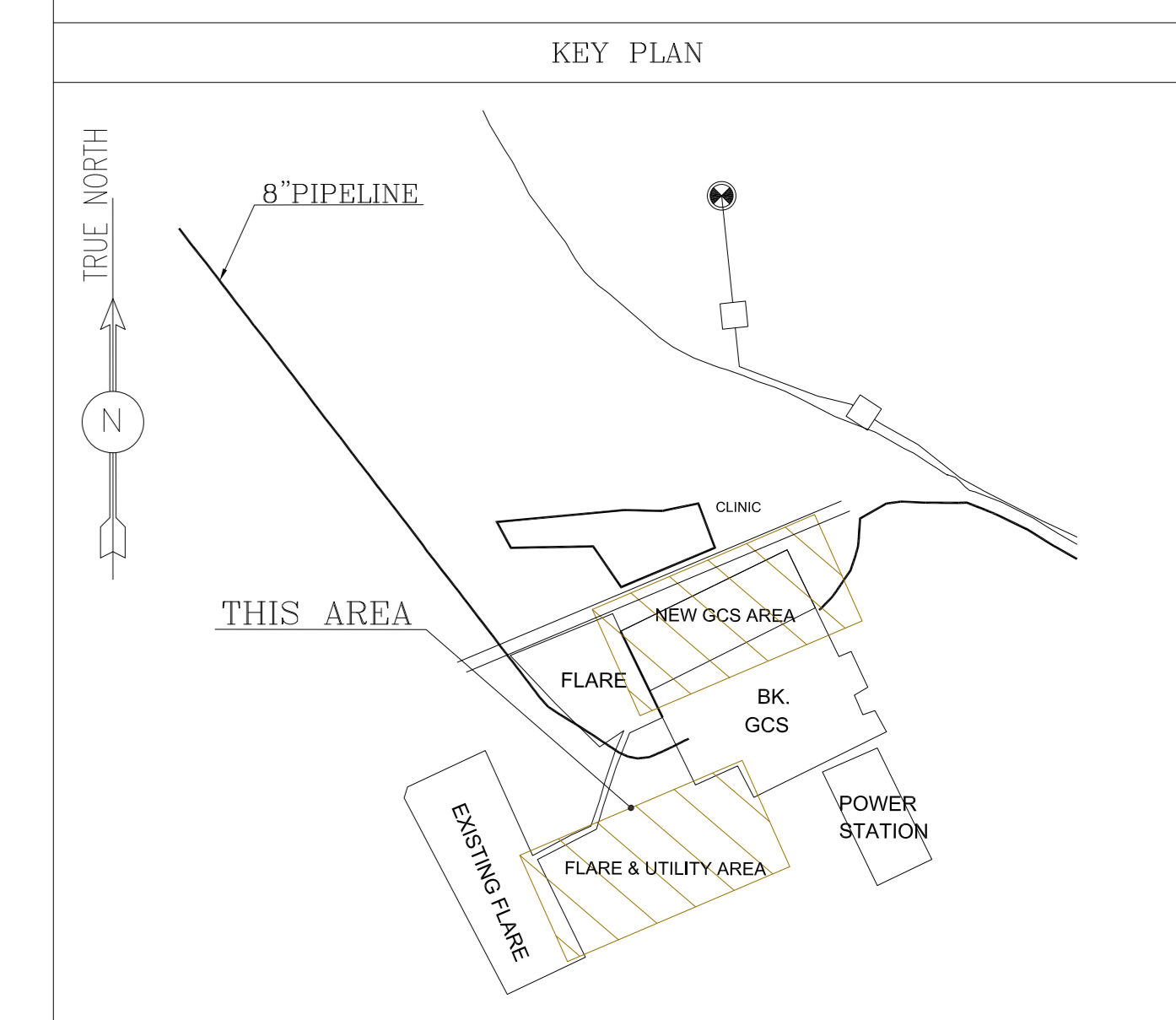

CUT & FILL

(Sc. 1:500)

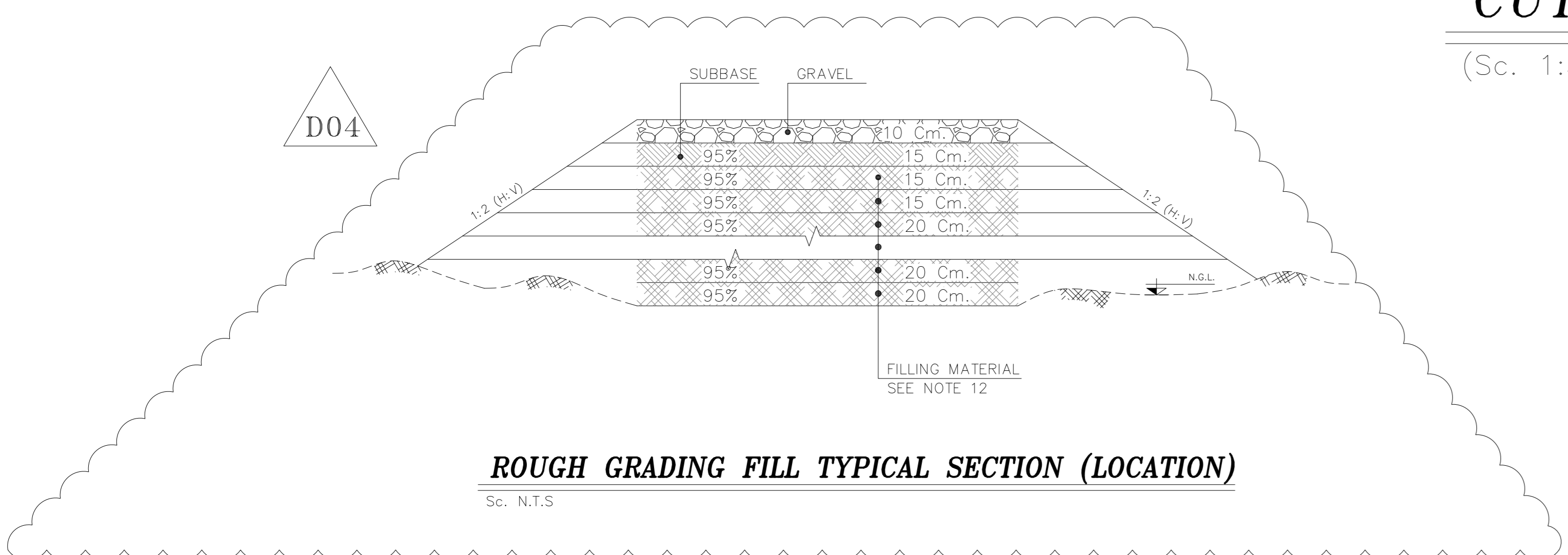

D04	APR. 2023	APC	R.BERLOUIE	M.FAKHARIAN	M.MEHRSHAD	***
D03	OCT. 2022	IFA	R.BERLOUIE	M.FAKHARIAN	M.MEHRSHAD	***
D02	SEP. 2022	IFA	R.BERLOUIE	M.FAKHARIAN	M.MEHRSHAD	***
D01	AUG. 2022	IFA	R.BERLOUIE	M.FAKHARIAN	M.MEHRSHAD	***
D00	MAY. 2022	IFC	R.BERLOUIE	M.FAKHARIAN	M.MEHRSHAD	***
REV.	DATE	P.O.I.S	PREP.	CHK.	APP.	AUT.

اعمال و کلیه نسخ این نقشه و حق امتیاز متعلق به شرکت ملی مناطق نفت خیز جنوب میباشد.
 THE ORIGINAL AND ALL COPIES OF THIS DRAWING TOGETHER WITH THE COPYRIGHT THEREIN ARE THE SOLE PROPERTY OF N.I.S.O.C./ FIELDS

PROJECT NAME: BINAK OILFIELD DEVELOPMENT CLIENT SITE CAMP
 PROJECT NO.: 971020

EPC CONTRACTOR: HIRGAN ENERGY TE
 EPD/EPC CONTRACTOR(GC): PETROIRAN DEVELOPMENT COMPANY PEDCO

DRAWING TITLE: ROUGH GRADING PLAN & DETAILS

SCALE	SIZE	DRAWING NO.	SHEET NO.	REV.
1:500	A0	BK-GCS-PEDCO-120-CV-PY-0007	05 OF 08	D04

BINAK OILFIELD DEVELOPMENT GENERAL

DATE	SCALE	DRAWING BY	CHECKED BY	PROJECT ENG.

NO CONSTRUCTION PERMITTED UNLESS DRAWING APPROVED

APPROVED FOR CONSTRUCTION	BY:	DATE:
BUDGET REF.	LOCATION	SIZE CLASS
1:500	A0	BK-GCS-PEDCO-120-CV-PY-0007
SHEET NO.	SERIAL NO.	SHEET REVISION
053-073-9184	F 5 S	709395 5 D04

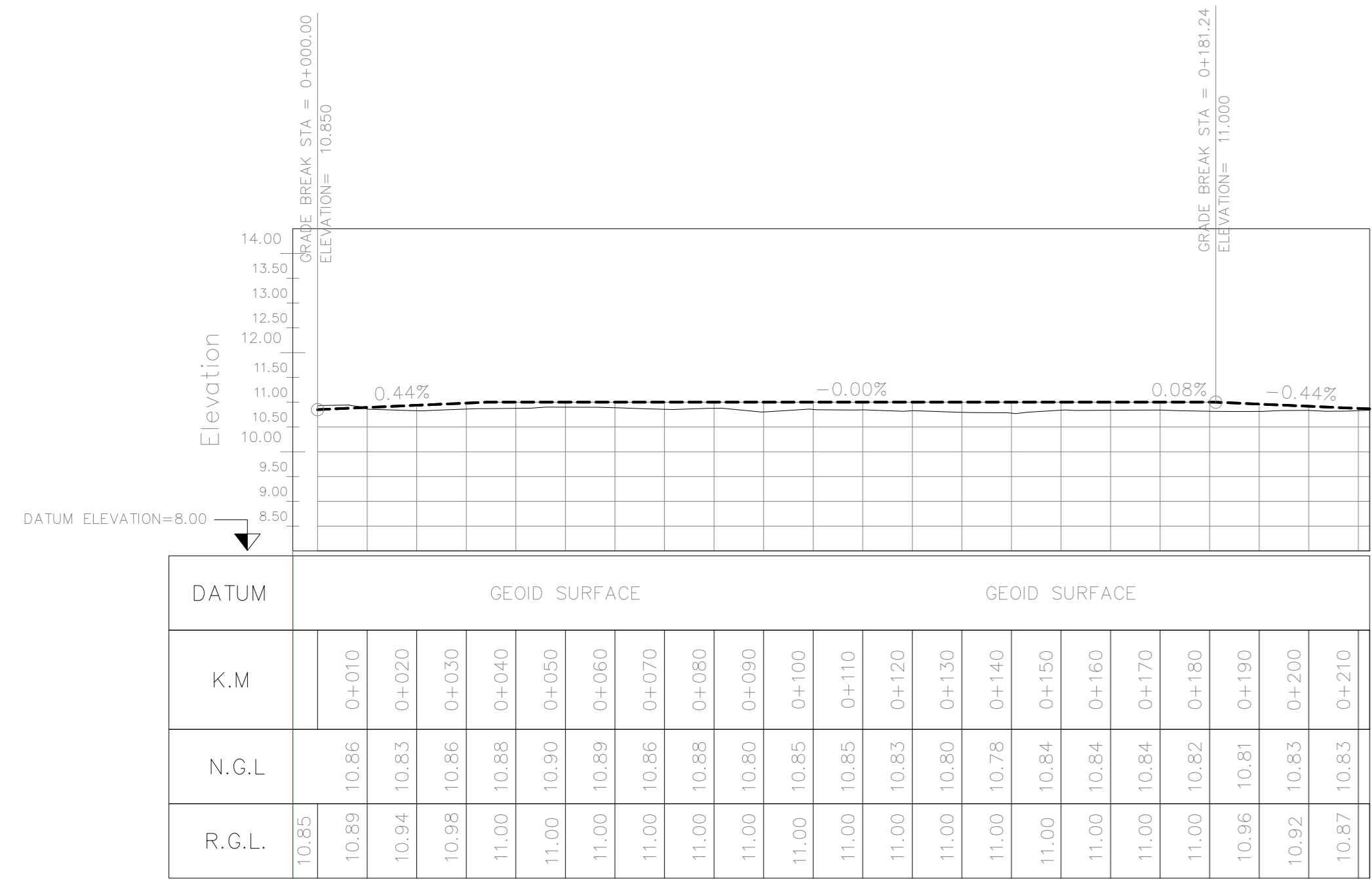

LONGITUDINAL PROFILE FOR ALIGNMENT P1

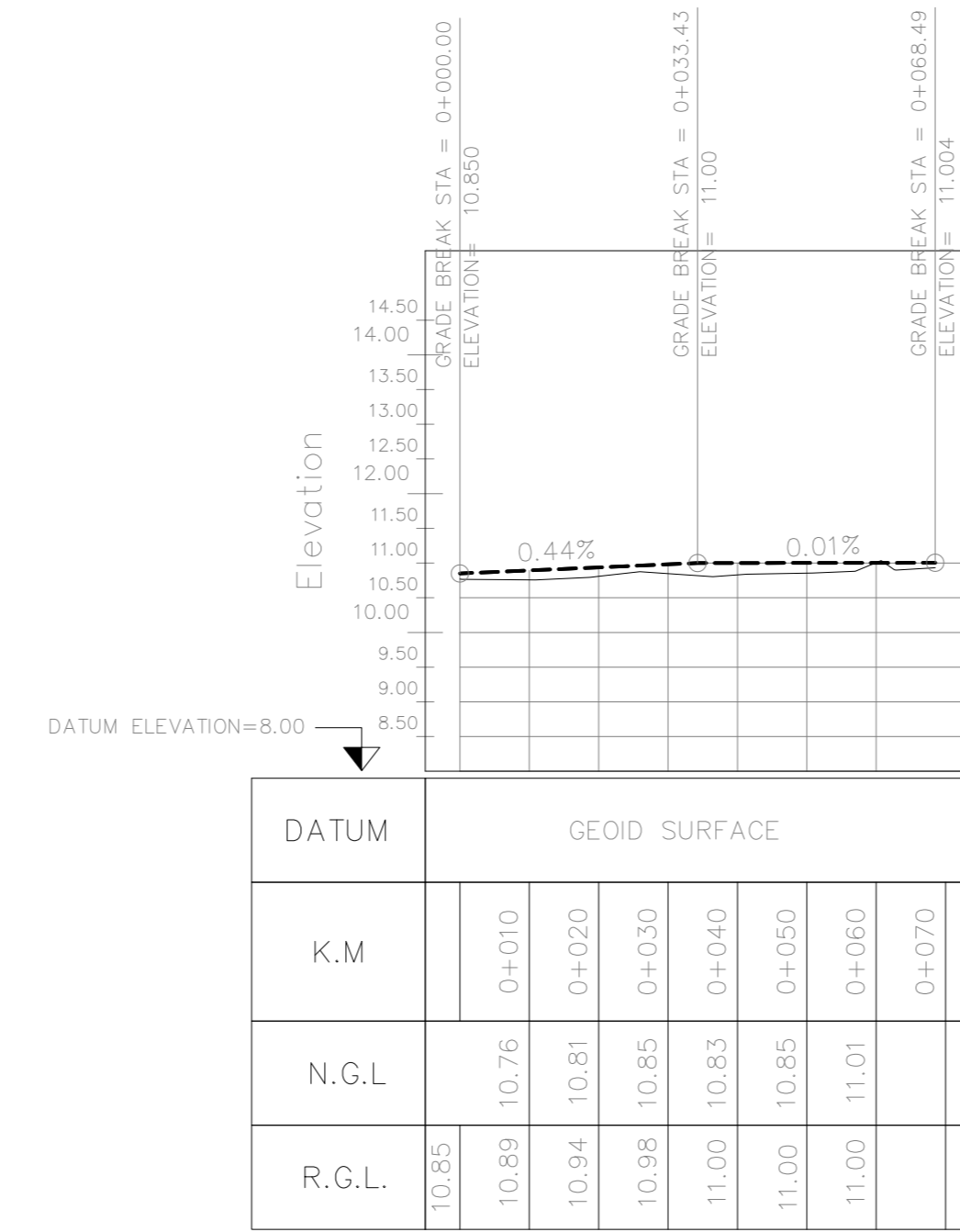

LONGITUDINAL PROFILE FOR ALIGNMENT P3

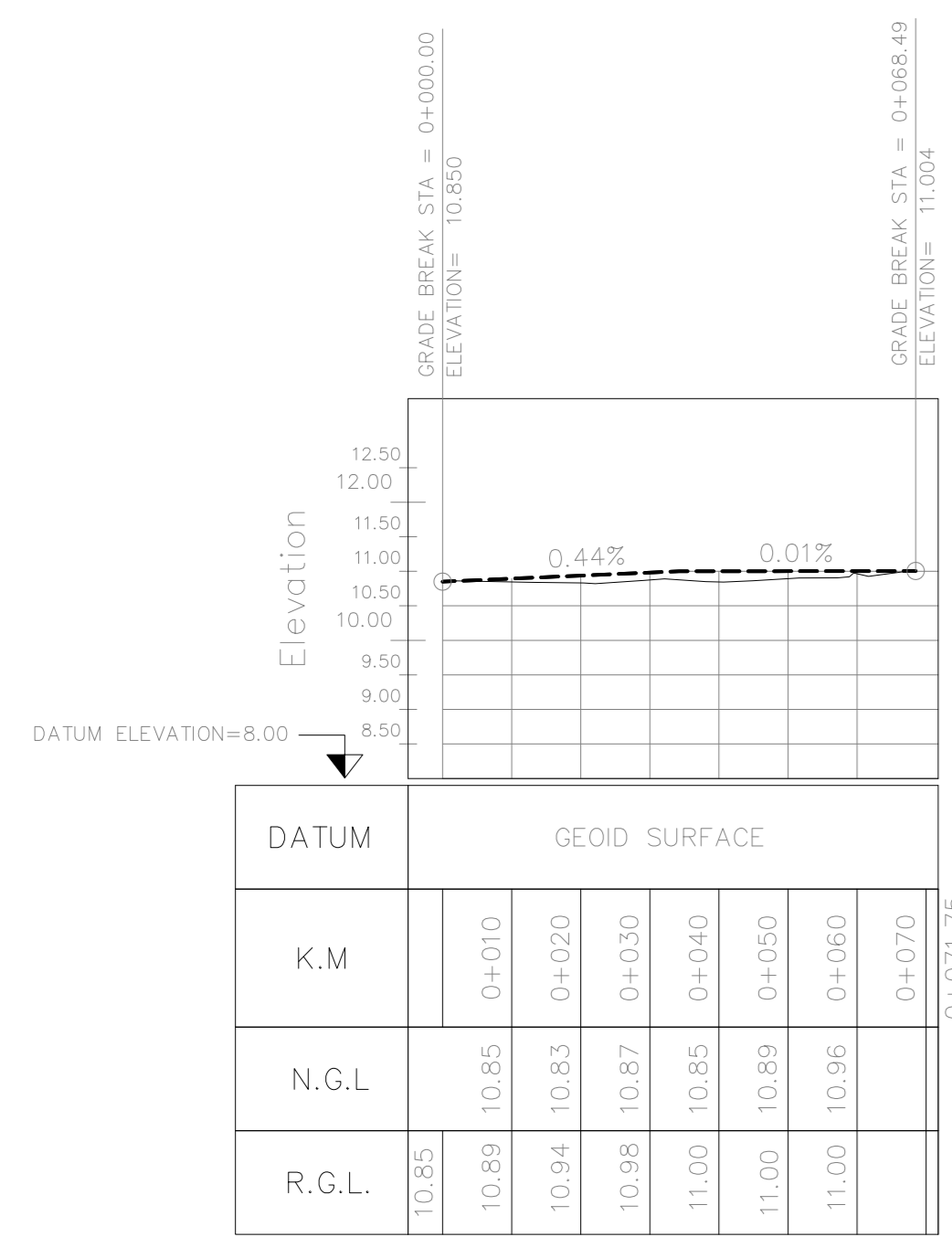

LONGITUDINAL PROFILE FOR ALIGNMENT P2

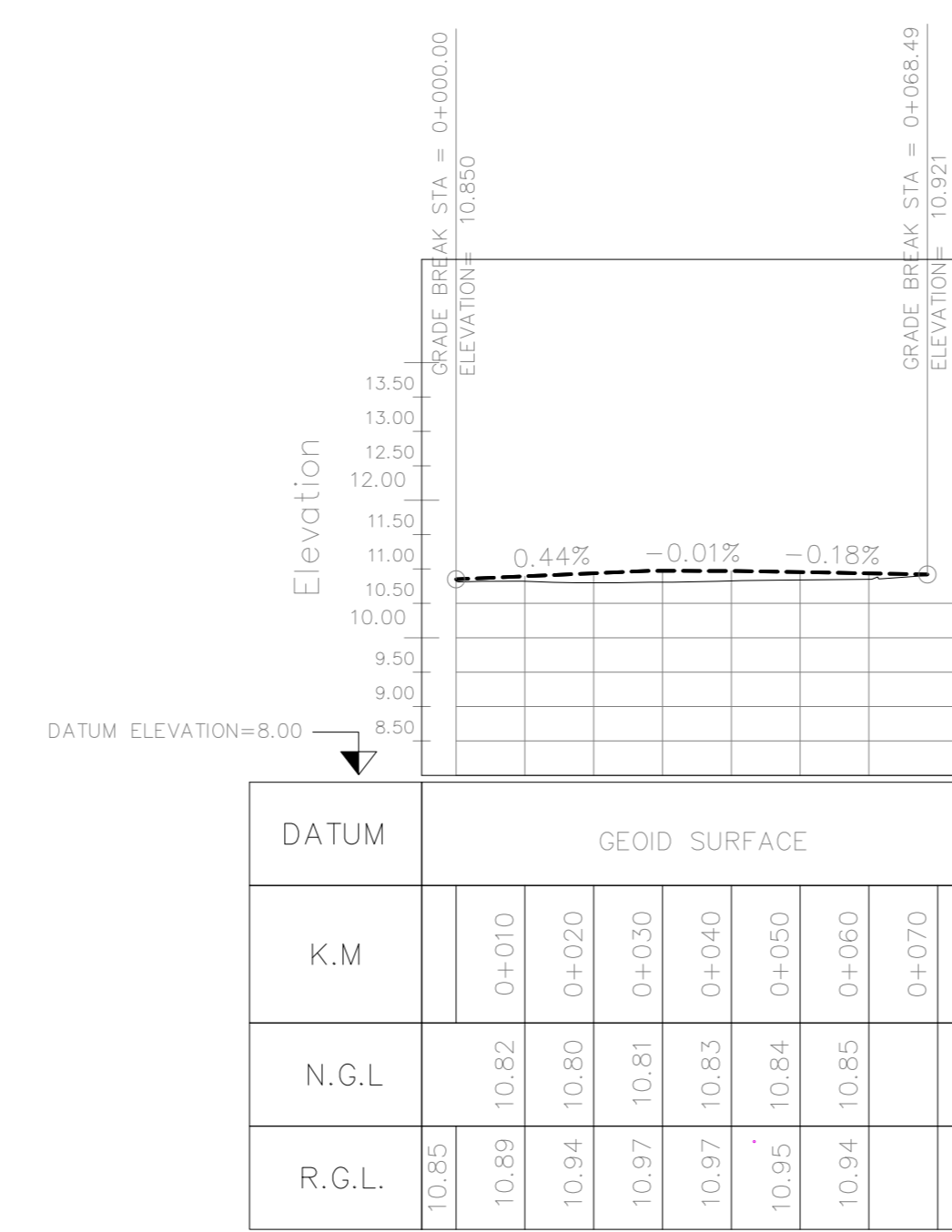

LONGITUDINAL PROFILE FOR ALIGNMENT P4

ROUGH GRADING PROFILES
(Sc. HOR 1:1000 VER 1:100)

- NOTES**
- ALL COORDINATES ARE IN UTM SYSTEM, ZONE 39.
 - ALL ELEVATION REFERENCES IS MEAN SEA LEVEL.
 - ALL DIMENSIONS ARE IN METERS UNLESS STATED OTHERWISE.
 - CUT DEPTH AND FILL HEIGHT SHOWN IN PLAN ARE ACCORDING TO NATURAL GROUND ELEVATION.
 - THE FILLING VOLUME IS FOR FINAL COMPACTED SOIL (NOT TOTAL REQUIRED SOIL) .
 - 30 cm SPOILED SOIL SHOULD BE REMOVED BEFORE ANY CONSTRUCTIONAL ACTIVITIES IF ANY.
 - CUT & FILL SLOPE IN GRADING AREA IS 1H:2V (200%).
 - HORIZONTAL AND VERTICAL DISTANCES BETWEEN TIK-MARKS IS 5m.
 - R.G.L IN GCS UNIT IS 11.00.
 - R.G.L IN UTILITY AREA IS 11.00.
 - R.G.L IN FLARE AREA IS 11.00.
 - THE SUITABLE MATERIAL FOR FILLING SHALL BE COLLECTED BASED ON TO THE BELOW RULES:
 - PROJECT GEOTECHNICAL INVESTIGATION REPORT, BORROW MATERIALS AND SPECIFICATION STUDY PART.
 - "GENERAL SPECIFICATION FOR ROAD" NO. 101, SECTION 207, IRAN PLANNING AND BUDGET ORGANIZATION.
 - PROJECT GENERAL SPECIFICATION "SPECIFICATION FOR EARTH WORK" DOCUMENT NUMBER "BK-GNRL-PEDCO-000-CV-SP-0004".
 - CLIENT'S SITE SUPERVISORY BODY RECOMMENDATIONS AND APPROVALS.
- GEODEIC PARAMETERS:**
 HORIZONTAL COORDINATE SYSTEM : WGS84 / UTM ZONE 39
 ELLIPSOID : WORLD GEODEIC SYSTEM 1984 (WGS84)
 MAP PROJECTION : UNIVERSAL TRANSVERSE MERCATOR (UTM)
 VERTICAL DATUM : MSL

LEGEND

STAIR	WATER CHANNEL
EMBANKMENT	RIVER
BURNING PIT LINE	WATER COURSE
GAS LINE	CONTOURS
WATER LINE	SPOT HEIGHT
EXISTING BUILDING	TRIC POINT
CONCRETE AREA	BRIDGE
MANHOLE	CULVERT
LIGHTING PIGLE	WELL LOCATION
GUARD ROOM	WELL
HELIPAD	SITE
FENCE	CAMP SITE
TREE	ASPHALT ROAD
FOUNDATION	GRAVEL ROAD
BOUNDARY	PROPOSED ROAD
	TRACK
	ROUGH GRADING CONTOUR
	SLOPE LIMIT DIRECTION

REFERENCE DRAWING	DRG. No.
SPECIFICATION FOR EARTH WORK	BK-GNRL-PEDCO-220-CV-PY-0001

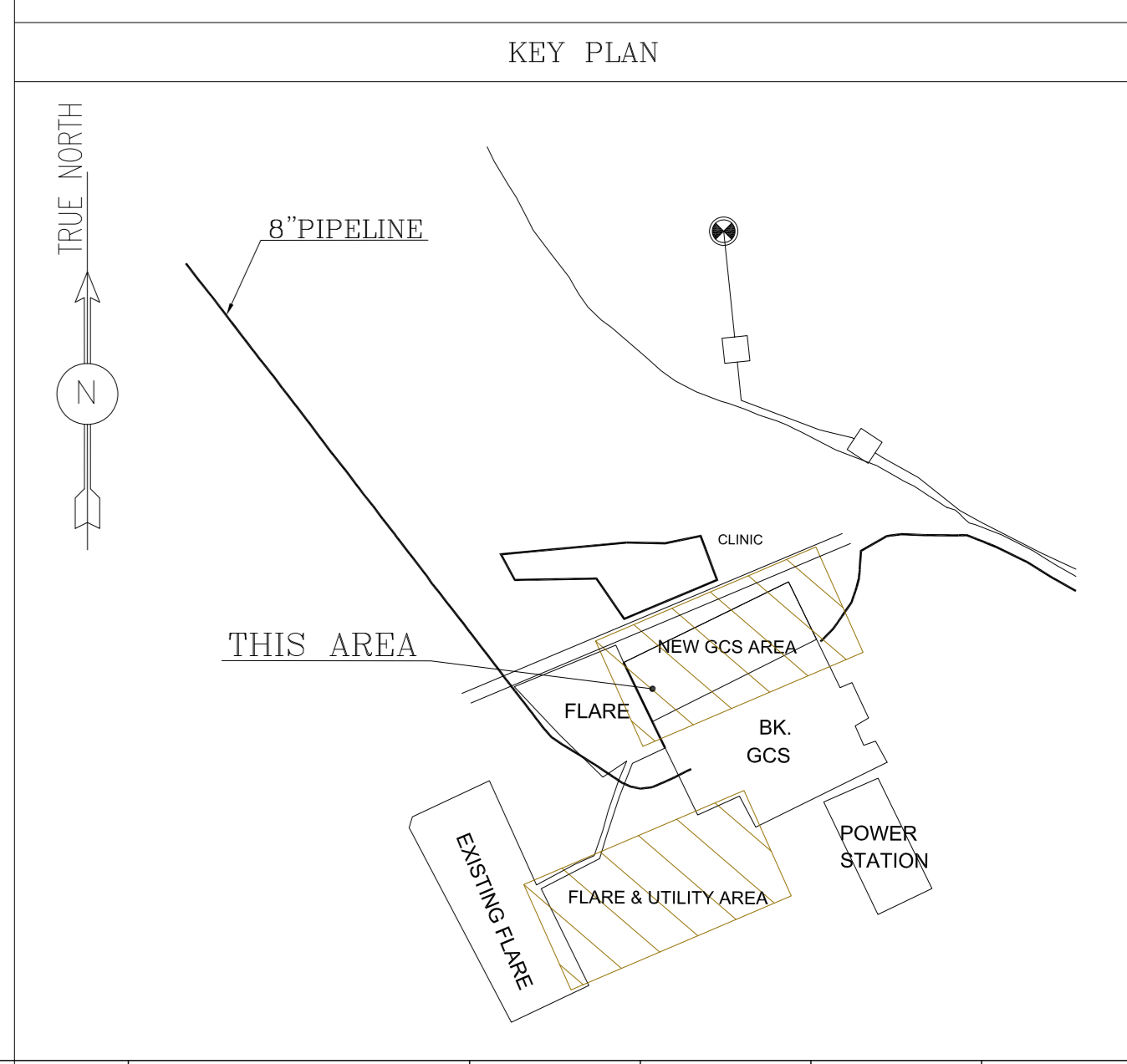

D04	APR.2023	APC	R.BERLOUIE	M.FAKHARIAN	M.MEHRSHAD	***				
D03	OCT.2022	IFA	R.BERLOUIE	M.FAKHARIAN	M.MEHRSHAD	**				
D02	SEP.2022	IFA	R.BERLOUIE	M.FAKHARIAN	M.MEHRSHAD	***				
D01	AUG.2022	IFA	R.BERLOUIE	M.FAKHARIAN	M.MEHRSHAD	***				
D00	MAY.2022	IFC	R.BERLOUIE	M.FAKHARIAN	M.MEHRSHAD	**				
REV.	DATE	P.O.I.S	PREP.	CHK.	APP.	AUT.	DESCRIPTION	CHECKED	BY	DATE

PROJECT NAME: BINAK OILFIELD DEVELOPMENT CLIENT SITE CAMP
 PROJECT NO.: 971020

EPC CONTRACTOR: HIRGAN ENERGY TE
 HIRGAN ENERGY - DESIGN & INSPECTION COMPANIES

EPD/EPC CONTRACTOR(GC): PEDCO
 PETROIRAN DEVELOPMENT COMPANY

DRAWING TITLE: ROUGH GRADING PLAN & DETAILS

NO CONSTRUCTION PERMITTED UNLESS DRAWING APPROVED

APPROVED FOR CONSTRUCTION BY: DATE:

SCALE	SIZE	DRAWING NO.	SHEET NO.	REV.	BUDGET REF.	LOCATION	SIZE CLASS	SERIAL NO.	SHEET	REVISION
AS SHOWN	A0	BK-GCS-PEDCO-120-CV-PY-0007	06 OF 08	D04	053-073-9184	F	5	S	709395	6

THE ORIGINAL AND ALL COPIES OF THIS DRAWING TOGETHER WITH THE COPYRIGHT THEREIN ARE THE SOLE PROPERTY OF N.I.S.O.C./ FIELDS

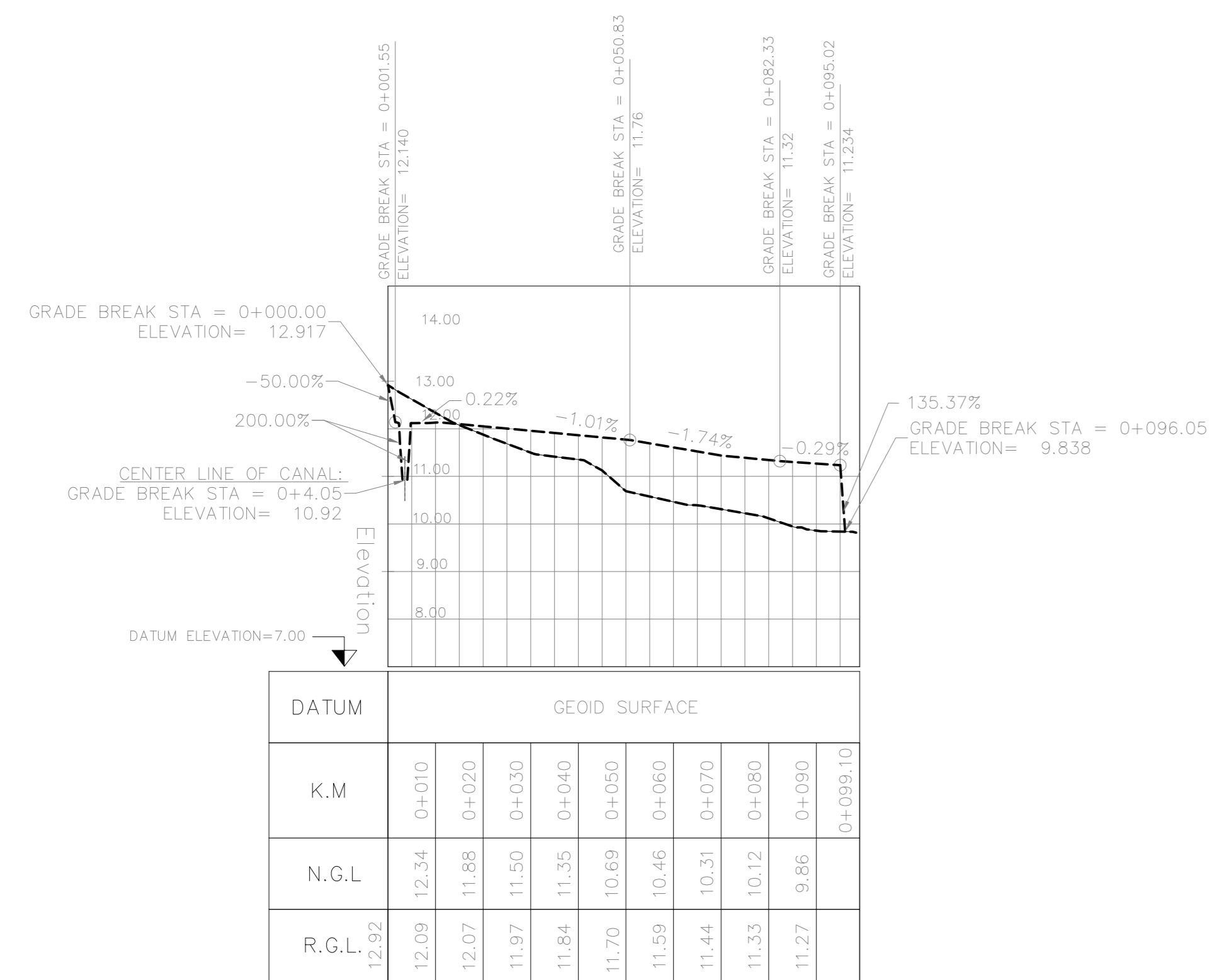

LONGITUDINAL PROFILE FOR ALIGNMENT Q1

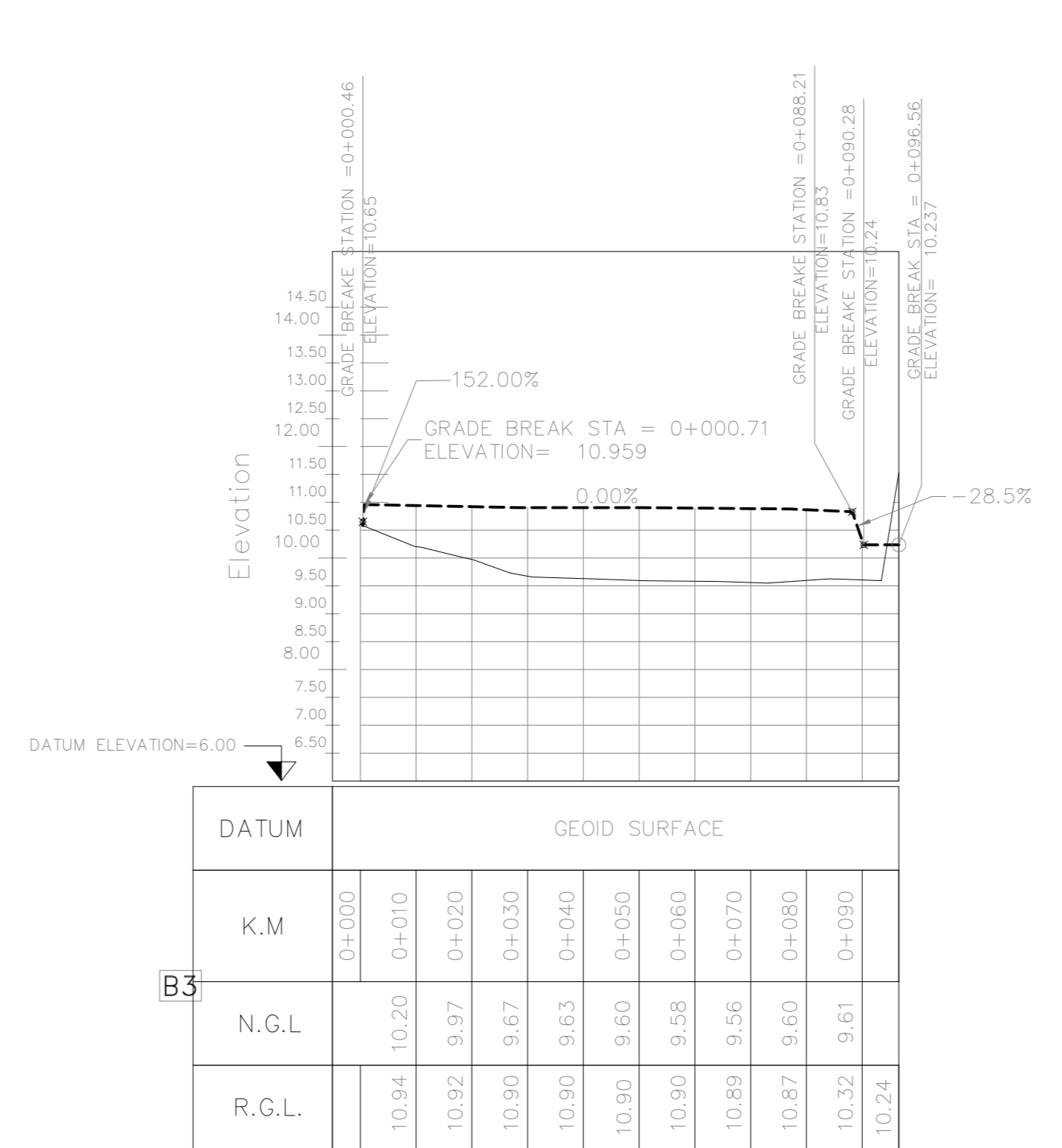

LONGITUDINAL PROFILE FOR ALIGNMENT Q3

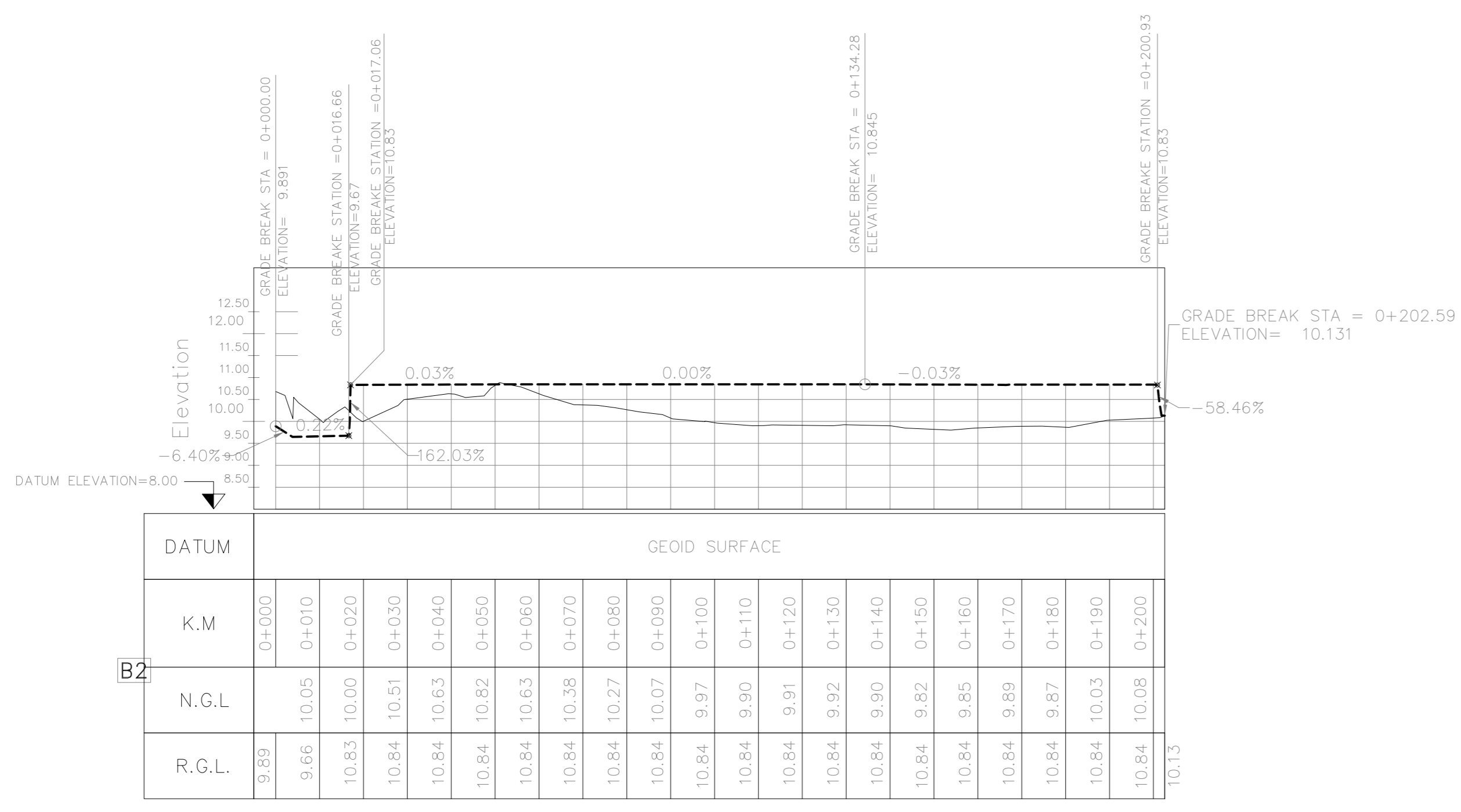

LONGITUDINAL PROFILE FOR ALIGNMENT Q2

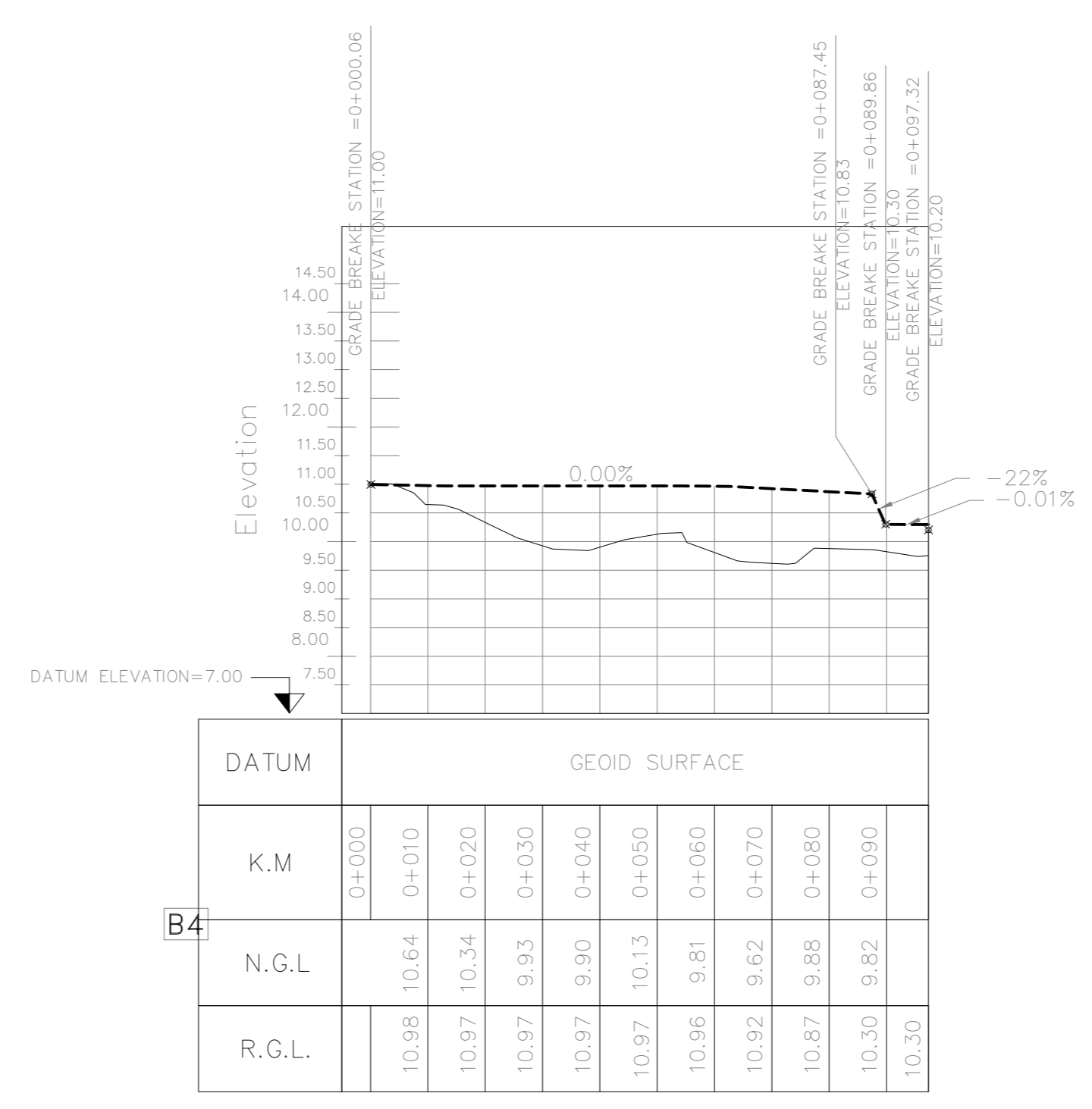

LONGITUDINAL PROFILE FOR ALIGNMENT Q4

- NOTES**
- ALL COORDINATES ARE IN UTM SYSTEM, ZONE 39.
 - ALL ELEVATION REFERENCES IS MEAN SEA LEVEL.
 - ALL DIMENSIONS ARE IN METERS UNLESS STATED OTHERWISE.
 - CUT DEPTH AND FILL HEIGHT SHOWN IN PLAN ARE ACCORDING TO NATURAL GROUND ELEVATION.
 - THE FILLING VOLUME IS FOR FINAL COMPACTED SOIL (NOT TOTAL REQUIRED SOIL).
 - 30 cm SPOILED SOIL SHOULD BE REMOVED BEFORE ANY CONSTRUCTIONAL ACTIVITIES IF ANY.
 - CUT & FILL SLOPE IN GRADING AREA IS 1H:2V (200%).
 - HORIZONTAL AND VERTICAL DISTANCES BETWEEN TIK-MARKS IS 5m.
 - R.G.L IN GCS UNIT IS 11.00.
 - R.G.L IN UTILITY AREA IS 11.00.
 - R.G.L IN FLARE AREA IS 11.00.
 - THE SUITABLE MATERIAL FOR FILLING SHALL BE COLLECTED BASED ON THE BELOW RULES:
 - PROJECT GEOTECHNICAL INVESTIGATION REPORT, BORROW MATERIALS AND SPECIFICATION STUDY PART.
 - "GENERAL SPECIFICATION FOR ROAD" NO. 101, SECTION 207, IRAN PLANNING AND BUDGET ORGANIZATION.
 - PROJECT GENERAL SPECIFICATION "SPECIFICATION FOR EARTH WORK" DOCUMENT NUMBER "BK-GNRL-PEDCO-000-CV-SP-0004".
 - CLIENT'S SITE SUPERVISORY BODY RECOMMENDATIONS AND APPROVALS.
- GEODETIC PARAMETERS:**
 HORIZONTAL COORDINATE SYSTEM : WGS84 / UTM ZONE 39
 ELLIPSOID : WORLD GEODETIC SYSTEM 1984 (WGS84)
 MAP PROJECTION : UNIVERSAL TRANSVERSE MERCATOR (UTM)
 VERTICAL DATUM : MSL

LEGEND

	STAR		WATER CHANNEL
	EMBANKMENT		RIVER
	BURNING PIT LINE		WATER COURSE
	GAS LINE		CONTOURS
	WATER LINE		SPOT HEIGHT
	EXISTING BUILDING		TRIG POINT
	CONCRETE AREA		BRIDGE
	MANHOLE		CULVERT
	LIGHTING PGL		WELL LOCATION
	GUARD ROOM		WELL
	HELIPAD		SITE
	FENCE		CAMP SITE
	TREE		ASPHALT ROAD
	FOUNDATION		GRAVEL ROAD
	BOUNDARY		PROPOSED ROAD
			TRACK
			ROUGH GRADING CONTOUR
			SLOPE LIMIT DIRECTION

REFERENCE DRAWING	DRG. No.
SPECIFICATION FOR EARTH WORK	BK-GNRL-PEDCO-220-CV-PY-0001

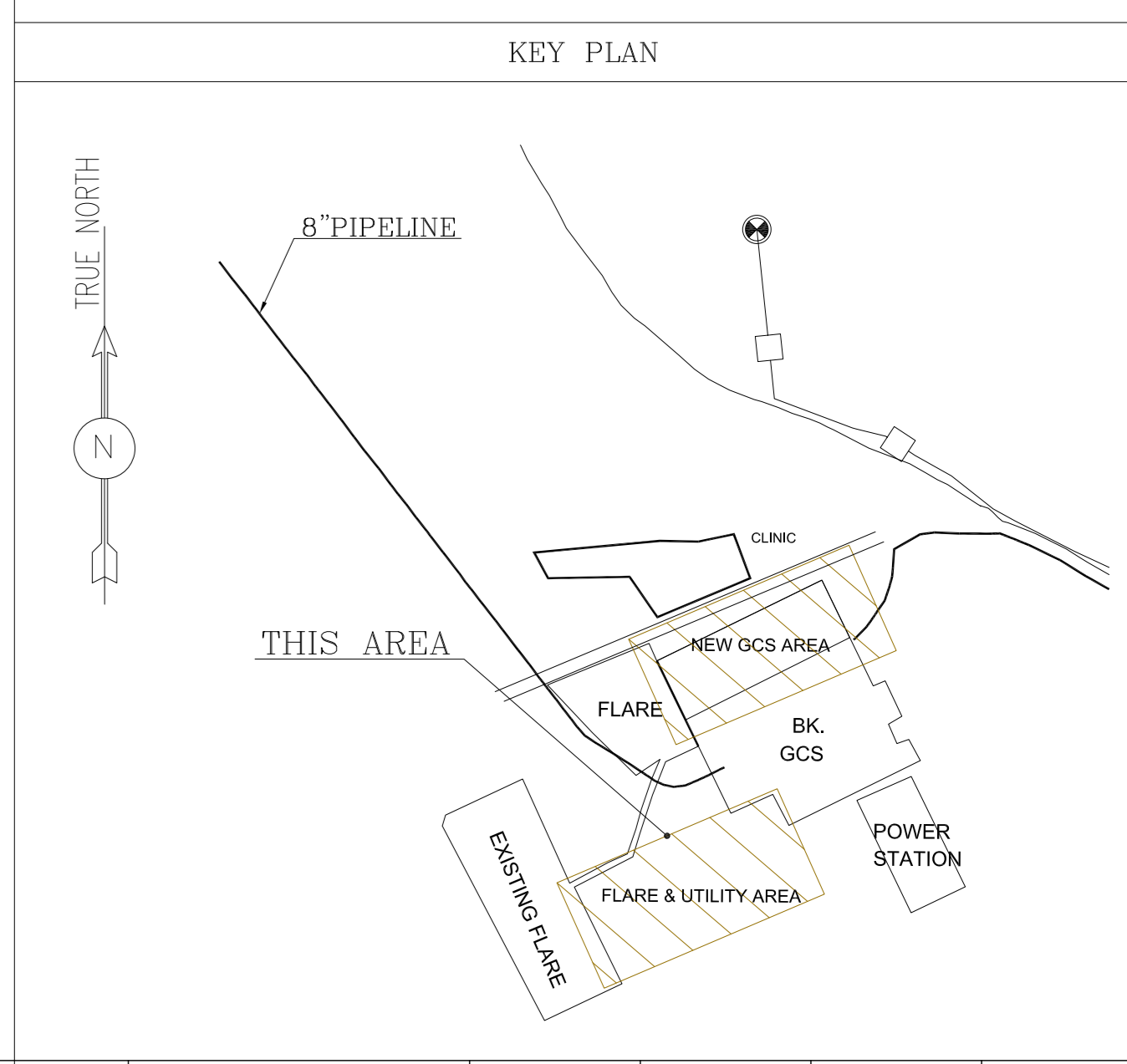

ROUGH GRADING PROFILES
 (Sc. HOR 1:1000 VER 1:100)

D04	APR.2023	APC	R.BERLOUIE	M.FAKHARIAN	M.MEHRSHAD	***												
D03	OCT.2022	IFA	R.BERLOUIE	M.FAKHARIAN	M.MEHRSHAD	**												
D02	SEP.2022	IFA	R.BERLOUIE	M.FAKHARIAN	M.MEHRSHAD	***												
D01	AUG.2022	IFA	R.BERLOUIE	M.FAKHARIAN	M.MEHRSHAD	***												
D00	MAY.2022	IFC	R.BERLOUIE	M.FAKHARIAN	M.MEHRSHAD	**												
REV.	DATE	P.O.I.S	PREP.	CHK.	APP.	AUT.	DESCRIPTION	BY	DATE	BY	DATE							
							احمل و کلیه نسخ این نقشه و حق اقتباس متعلق به شرکت ملی مناطق نفت خیز جنوب میباشد.											
PROJECT NAME:							BINAK OILFIELD DEVELOPMENT CLIENT SITE CAMP											
PROJECT NO.:							971020											
EPC CONTRACTOR:			EPD/EPC CONTRACTOR(GC):															
 HIRGAN ENERGY - DESIGN & INSPECTION COMPANIES			 PETROIRAN DEVELOPMENT COMPANY															
DRAWING TITLE:							BINAK OILFIELD DEVELOPMENT GENERAL											
DRAWING TITLE:							ROUGH GRADING PLAN & DETAILS											
NO CONSTRUCTION PERMITTED UNLESS DRAWING APPROVED							APPROVED FOR CONSTRUCTION											
SCALE							BUDGET REF.		BY:		DATE:							
AS SHOWN							LOCATION	SIZE	CLASS	SERIAL NO.	SHEET	REVISION						
A0							BK-GCS-PEDCO-120-CV-PY-0007	07	0P	08	D04	053-073-9184	F	5	S	709395	7	D04



ROUGH GRADING PROFILES

(Sc. HOR 1:1000 VER 1:100)

- NOTES**
- ALL COORDINATES ARE IN UTM SYSTEM, ZONE 39.
 - ALL ELEVATION REFERENCES IS MEAN SEA LEVEL.
 - ALL DIMENSIONS ARE IN METERS UNLESS STATED OTHERWISE.
 - CUT DEPTH AND FILL HEIGHT SHOWN IN PLAN ARE ACCORDING TO NATURAL GROUND ELEVATION.
 - THE FILLING VOLUME IS FOR FINAL COMPACTED SOIL (NOT TOTAL REQUIRED SOIL).
 - 30 cm SPOILED SOIL SHOULD BE REMOVED BEFORE ANY CONSTRUCTIONAL ACTIVITIES IF ANY.
 - CUT & FILL SLOPE IN GRADING AREA IS 1H:2V (200%).
 - HORIZONTAL AND VERTICAL DISTANCES BETWEEN TIK-MARKS IS 5m.
 - R.G.L IN GCS UNIT IS 11.00.
 - R.G.L IN UTILITY AREA IS 11.00.
 - R.G.L IN FLARE AREA IS 11.00.
 - THE SUITABLE MATERIAL FOR FILLING SHALL BE COLLECTED BASED ON TO THE BELOW RULES:
 - PROJECT GEOTECHNICAL INVESTIGATION REPORT, BORROW MATERIALS AND SPECIFICATION STUDY PART.
 - "GENERAL SPECIFICATION FOR ROAD" NO. 101, SECTION 207, IRAN PLANNING AND BUDGET ORGANIZATION.
 - PROJECT GENERAL SPECIFICATION "SPECIFICATION FOR EARTH WORK" DOCUMENT NUMBER "BK-GNRL-PEDCO-000-CV-SP-0004".
 - CLIENT'S SITE SUPERVISORY BODY RECOMMENDATIONS AND APPROVALS.
- GEOIDETIC PARAMETERS:**
 HORIZONTAL COORDINATE SYSTEM : WGS84 / UTM ZONE 39
 ELLIPSOID : WORLD GEODETIC SYSTEM 1984 (WGS84)
 MAP PROJECTION : UNIVERSAL TRANSVERSE MERCATOR (UTM)
 VERTICAL DATUM : MSL

LEGEND

	STAR		WATER CHANNEL
	EMBANKMENT		RIVER
	BURNING PIT LINE		WATER COURSE
	GAS LINE		CONTOURS
	WATER LINE		SPOT HEIGHT
	EXISTING BUILDING		TRIC POINT
	CONCRETE AREA		BRIDGE
	MANHOLE		CULVERT
	LIGHTING PIGLE		WELL LOCATION
	GUARD ROOM		WELL
	HELIPAD		SITE
	FENCE		CAMP SITE
	TREE		ASPHALT ROAD
	FOUNDATION		GRAVEL ROAD
	BOUNDARY		PROPOSED ROAD
			TRACK
			SLOPE LIMIT DIRECTION

REFERENCE DRAWING	DRG. No.
SPECIFICATION FOR EARTH WORK	BK-GNRL-PEDCO-220-CV-PY-0001

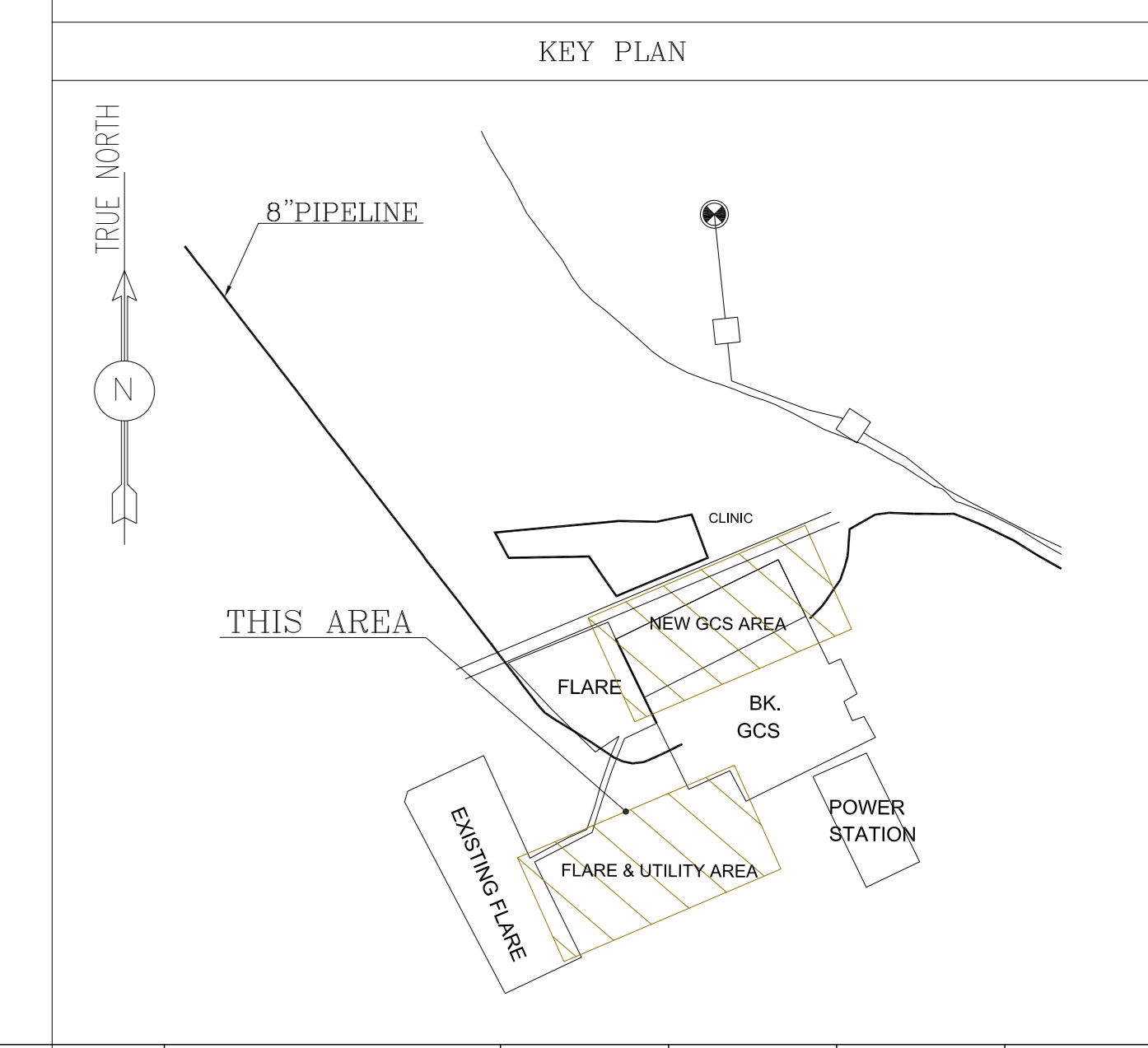

DO4	APR.2023	APC	R.BERLOUIE	M.FAKHARIAN	M.MEHRSHAD	***					
DO3	OCT.2022	IFA	R.BERLOUIE	M.FAKHARIAN	M.MEHRSHAD	**					
DO2	SEP.2022	IFA	R.BERLOUIE	M.FAKHARIAN	M.MEHRSHAD	***					
DO1	AUG.2022	IFA	R.BERLOUIE	M.FAKHARIAN	M.MEHRSHAD	***					
DO0	MAY.2022	IFC	R.BERLOUIE	M.FAKHARIAN	M.MEHRSHAD	**					
REV.	DATE	P.O.I.S	PREP.	CHK.	APP.	AUT.	DESCRIPTION	BY	DATE	BY	DATE
							اعمال و کلیه نسخ این نقشه و حق اقتباس متعلق به شرکت ملی مناطق نفت خیز جنوب میباشد. THE ORIGINAL AND ALL COPIES OF THIS DRAWING TOGETHER WITH THE COPYRIGHT THEREIN ARE THE SOLE PROPERTY OF N.I.S.O.C./ FIELDS				
PROJECT NAME:		BINAK OILFIELD DEVELOPMENT CLIENT SITE CAMP									
PROJECT NO.:		971020									
EPC CONTRACTOR:			EPD/EPC CONTRACTOR(GC):								
 HIRGAN ENERGY - DESIGN & INSPECTION COMPANIES			 PETROIRAN DEVELOPMENT COMPANY								
DRAWING TITLE:			ROUGH GRADING PLAN & DETAILS								
			NO CONSTRUCTION PERMITTED UNLESS DRAWING APPROVED								
			APPROVED FOR CONSTRUCTION			BY:			DATE:		
SCALE	SIZE	DRAWING NO.		SHEET NO.	REV.	BUDGET REF.	LOCATION	SIZE CLASS	SERIAL NO.	SHEET	REVISION
AS SHOWN	A0	BK-GCS-PEDCO-120-CV-PY-0007		08 OF 08	D04	053-073-9184	F	5	S	709395	B D04