

NOTES
 1- ALL COORDINATES AND ELEVATIONS ARE IN METER.
 2- ALL DRAWINGS SHALL BE CHECKED BY CONTRACTOR WITH RELATIVE DRAWINGS BEFORE CONSTRUCTION.
 3- GEODETIC PARAMETERS FOR COORDINATES ARE AS BELOW:
 HORIZONTAL COORDINATE SYSTEM: WGS84/UTM ZONE 39
 ELLIPSOID : WORLD GEODETIC SYSTEM 1984 (WGS84)
 MAP PROJECTION: UNIVERSAL TRANSVERSE MERCATOR (UTM)
 VERTICAL DATUM: MEAN SEA LEVEL

ABBREVIATIONS
 N.G.L.=Natural Ground Level AR=Asphalt Road
 B.O.P.L=Bottom of Pipe Level GR=Gravel Road
 R.O.W.L=Right of Way Level PL=Pipe Line Corridor
 PC=Pipe Line Crossing PL=Pipe Line
 OF=Optical Fiber CH=Channel
 BP=Beginning of Plan PI=Point of Intersection
 EP=End of Plan

LEGEND

Existing GRAVEL ROAD	CHANNEL
New GRAVEL ROAD	RIVER
ASPHALT ROAD	WATER COURSE
STAIR	CONTOURS
TRENCH	60
EMBANKMENT	50
BURNING PIT LINE	99.27 SPOT HEIGHT
WATER LINE	TRIG POINT
BUILDING	CULVERT
CONCRETE AREA	WELL LOCATION
SEPTIC	WELL
MANHOLE	SITE
POLE	CAMP SITE
HELIPAD	
Existing OIL Pipe Line	
New OIL Pipe Line	
GAS PIPE LINE (UG)	

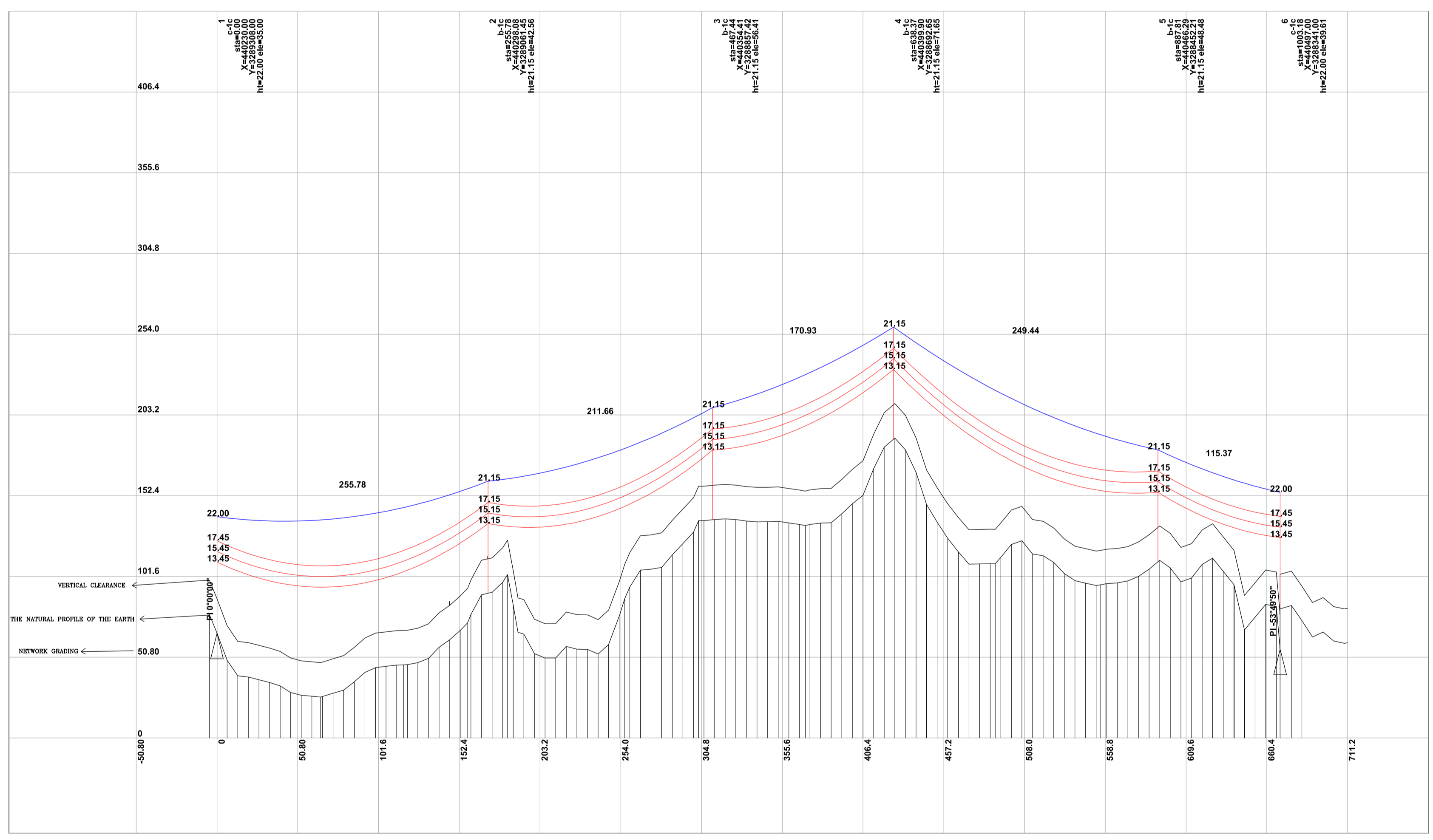

REFERENCE DRAWING DRG. No.
 PROPOSED ROUTE PLAN OF POWER LINE F-3-AR-80370

KEY PLAN

Crossing List				Coordinate of Bench Marks (UTM)			COORDINATES OF INTERSECTION POINTS (UTM)										
Item	Description	Start (KM)	End (KM)	Reference Sheet & Note	Points	Northing (m)	Easting (m)	Elevation (m)	Station	Northing (m)	Easting (m)	Station	Northing (m)	Easting (m)	Station	Northing (m)	Easting (m)
1	RIVER CROSSING	0+067.0	0+108.0		IP-0	440230.15	3289308.49	35.301	0+000.00	3289308.27	440230.07	0+480.00	3288845.69	440358.20	0+960.00	3288311.11	440486.33
2	PL CROSSING	0+296.00		ABOVE GROUND OIL PIPE LINE	IP-1	440497.93	3288341.90	39.610	0+020.00	3289299.00	440235.41	0+500.00	3288526.42	440363.54	0+980.00	3288033.85	440491.67
3	ROAD CROSSING	0+945.50							0+040.00	3289269.72	440240.75	0+520.00	3288807.14	440368.88	1+000.00	3288344.56	440497.01
4	ROAD CROSSING	1+076.00							0+060.00	3289250.45	440246.09	0+540.00	3288787.87	440374.22	1+020.00	3288356.33	440506.41
5									0+080.00	3289231.18	440251.42	0+560.00	3288768.59	440379.56	1+040.00	3288373.59	440516.53
6									0+100.00	3289211.90	440256.76	0+580.00	3288749.12	440384.80	1+060.00	3288390.84	440526.66
7									0+120.00	3289192.63	440262.10	0+600.00	3288730.05	440390.23	1+080.00	3288408.09	440536.77
									0+140.00	3289173.35	440267.44	0+620.00	3288710.77	440395.57	1+100.00	3288425.34	440546.89
									0+160.00	3289154.08	440272.78	0+640.00	3288691.50	440400.91	1+120.00	3288442.59	440557.01
									0+180.00	3289134.81	440278.12	0+660.00	3288672.22	440406.25	1+140.00	3288459.84	440567.13
									0+200.00	3289115.53	440283.46	0+680.00	3288652.95	440411.59	1+160.00	3288477.09	440577.25
									0+220.00	3289096.26	440288.80	0+700.00	3288633.67	440416.93	1+180.00	3288494.34	440587.37
									0+240.00	3289076.98	440294.14	0+720.00	3288614.40	440422.27	1+200.00	3288511.59	440597.49
									0+260.00	3289057.71	440299.47	0+740.00	3288595.13	440427.61	1+220.00	3288528.84	440607.61
									0+280.00	3289038.43	440304.81	0+760.00	3288575.85	440432.94	1+240.00	3288546.14	440617.73
									0+300.00	3289019.16	440310.15	0+780.00	3288556.58	440438.28			
									0+320.00	3288999.89	440315.49	0+800.00	3288537.30	440443.62			
									0+340.00	3288980.61	440320.83	0+820.00	3288518.03	440448.96			
									0+360.00	3288961.34	440326.17	0+840.00	3288498.75	440454.30			
									0+380.00	3288942.06	440331.51	0+860.00	3288479.48	440459.64			
									0+400.00	3288922.79	440336.85	0+880.00	3288460.21	440464.98			
									0+420.00	3288903.51	440342.18	0+900.00	3288440.93	440470.32			
									0+440.00	3288884.24	440347.52	0+920.00	3288421.66	440475.65			
									0+460.00	3288864.97	440352.86	0+940.00	3288402.38	440480.99			

REV.	DESCRIPTION	BY	DATE	BY	DATE	
D03	JUN 2023	APC	H.SHAKIBA	M.FAKHARIAN	A.M.MOHSSENI	
D02	DEC 2022	APC	H.SHAKIBA	M.FAKHARIAN	M.MEHRSHAD	
D01	AUG 2022	IFA	H.SHAKIBA	M.FAKHARIAN	M.MEHRSHAD	
D00	MAY 2022	IPC	H.SHAKIBA	M.FAKHARIAN	M.MEHRSHAD	
REV.	DATE	P.O.I.S	PREP.	CHK.	APP.	AUT.

PROJECT NAME: BINAK OILFIELD DEVELOPMENT/SUB-SURFACE WORK PACKAGES
 BK12 WHF MODIFICATIONS

PROJECT NO.: 971020

EPC CONTRACTOR: HIRGAN ENERGY - DESIGN & INSPECTION COMPANIES

EPD/EPC CONTRACTOR (GC): PETROIRAN DEVELOPMENT COMPANY

DRAWING TITLE: Over Head Line Plan and Profile - BK12

SCALE	SIZE	DRAWING NO.	SHEET NO.	REV.	BUDGET REF.	LOCATION	SIZE	CLASS	SERIAL NO.	SHEET	REVISION
H=1:1000 V=1:200	A1	BK-BK12-PEDCO-110-SU-DW-0001	01 OF 01	D03	053-073-9184	F	4	A	708310	01 OF 01	D03

NO CONSTRUCTION PERMITTED UNLESS DRAWING APPROVED

APPROVED FOR CONSTRUCTION BY: DATE: