

1 FLOOR PLAN  
SC.1:50

**NOTES**

1. ALL DIMENSIONS ARE IN MILLIMETER & ALL ELEVATIONS ARE IN METER.  
2. ALL DIMENSIONS AND ELEVATIONS SHALL BE CHECKED BY THE CONTRACTOR PRIOR TO CONSTRUCTION.  
3. CONTRACTOR SHALL COMPARE ALL ARCHITECTURAL, MECHANICAL, ELECTRICAL, PIPING AND STRUCTURAL DRAWINGS AND IN CASE OF ANY CONFLICTS OR DISCREPANCY, INFORM THE ENGINEER.  
4. ALL MATERIALS ARE SELECTED FROM THE HIGHEST QUALITY AND MUST BE APPROVED BY THE CLIENT.  
5. ALL OPENINGS FOR PIPING/CABLEING AND HVAC OPENINGS SHALL BE CONSIDERED AS PER RELATED DRAWINGS BEFORE CONSTRUCTION.  
6. FINISH GRADING LEVEL IS EQUIVALENT=±0.00 LOCAL=+11.05 GLOBE(M.S.L.)

**LEGEND**

R.C. CONCRETE

GALVANIZED GRATING

T.O.PA  
F.G.L.  
T.O.F.  
T.O.B.  
B.O.G.  
T.O.PED.  
T.O.S  
B.O.GU.  
L.P.L.  
H.P.L.  
B.O.S.

TOP OF PAVING  
FINISH GRADING LEVEL  
TOP OF FOUNDATION  
TOP OF BEAM  
BOTTOM OF GIRT  
TOP OF PEDESTAL  
TOP OF SHELTER  
BOTTOM OF GUTTER  
LOWEST POINT LEVEL  
HIGHEST POINT LEVEL  
BOTTOM OF SLEEVE

REFERENCE DRAWING	DRG. No.
STANDARD DRAWING FOR ARCHITECTURAL DETAILS	BK-GNRL-PEDCO-000-AR-DW-0001
SITE SEWAGE SYSTEM LAYOUT & DETAILS	BK-GCS-PEDCO-120-CV-PY-0001
CABLE TRENCH AND DUCT BANK LAYOUT	BK-GCS-PEDCO-120-CV-PY-0002
ROAD, PAVING AND PLANT FINISH GRADING LAYOUT & SECTIONS	BK-GCS-PEDCO-120-CV-PY-0005
ELECTRICAL CABLE ROUTE & SECTION LAYOUT FOR BUILDING & SHEDS	BK-GCS-PEDCO-120-EL-PY-0006
FOUNDATION DRAWING FOR FIRE WATER PUMP SHEDS	BK-GCS-PEDCO-120-ST-DW-0006
STRUCTURAL DRAWING FOR FIRE WATER PUMP SHEDS	BK-GCS-PEDCO-120-ST-DW-0006
UNIT PLANT PLAN FOR PIG RECEIVER AREA (IN SHAMKAN G.S. SECTION)	BK-PPL-PEDCO-320-PI-PY-0001

**KEY PLAN**

REV.	DATE	DESCRIPTION	CHECKED	DATE	BY	DATE	BY	DATE	BY
D01	JUL.2023	1FA	R.BERLOUE	M.FAKHARIAN	A.M.MOHESEN	**	**	**	**
D00	OCT.2022	1FC	R.BERLOUE	M.FAKHARIAN	M.MEHRSHAD	**	**	**	**

PROJECT NAME: BINAK OILFIELD DEVELOPMENT/SURFACE FACILITIES GAS COMPRESSOR STATION

PROJECT NO.: 971020

EPC CONTRACTOR: HIRGAN ENERGY - DESIGN & INSPECTION COMPANIES

EPD/EPC CONTRACTOR (GC): PETROIRAN DEVELOPMENT COMPANY

DRAWING TITLE: ARCHITECTURAL DRAWING FOR FIRE WATER PUPS SHELTER

NO CONSTRUCTION PERMITTED UNLESS DRAWING APPROVED

APPROVED FOR CONSTRUCTION BY: DATE:

SCALE	SIZE	DRAWING NO.	SHEET NO.	REV.	BUDGET REF.	LOCATION	SIZE	CLASS	SERIAL NO.	SHEET	REVISION
AS SHOWN	A1	BK-GCS-PEDCO-120-AR-DW-0006	01 OF 07	D01	053-073-9184	F	4	B	709104	01 OF 07	D01

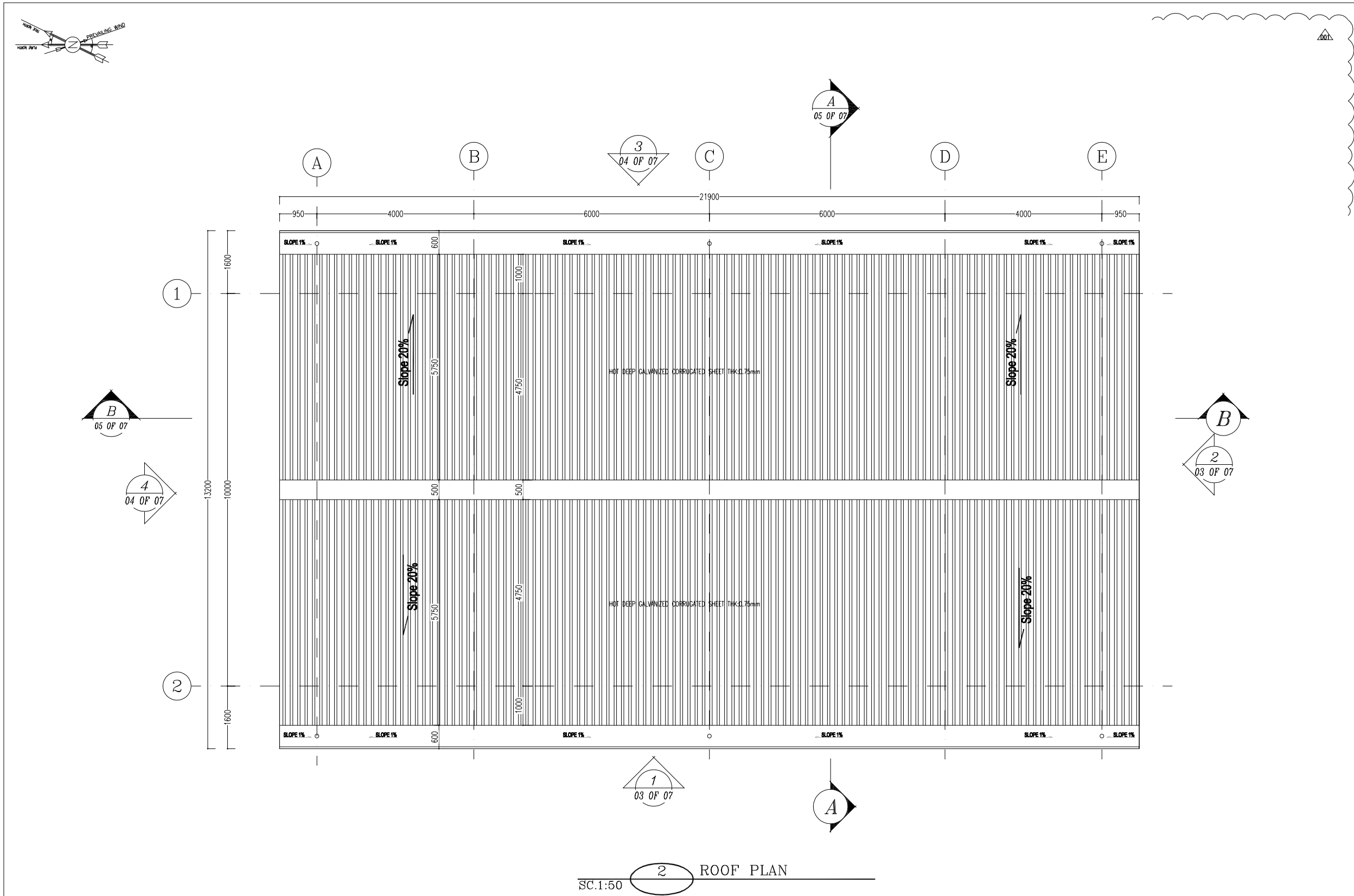

NOTES

1. ALL DIMENSIONS ARE IN MILLIMETER & ALL ELEVATIONS ARE IN METER.  
2. ALL DIMENSIONS AND ELEVATIONS SHALL BE CHECKED BY THE CONTRACTOR PRIOR TO CONSTRUCTION.  
3. CONTRACTOR SHALL COMPARE ALL ARCHITECTURAL, MECHANICAL, ELECTRICAL, PIPING AND STRUCTURAL DRAWINGS AND IN CASE OF ANY CONFLICTS OR DISCREPANCY, INFORM THE ENGINEER.  
4. ALL MATERIALS ARE SELECTED FROM THE HIGHEST QUALITY AND MUST BE APPROVED BY THE CLIENT.  
5. ALL OPENINGS FOR PIPING/CABLEING AND HVAC OPENINGS SHALL BE CONSIDERED AS PER RELATED DRAWINGS BEFORE CONSTRUCTION.  
6. FINISH GRADING LEVEL IS EQUIVALENT=±0.00 LOCAL=+11.05 GLOBAL(M.S.L.)

LEGEND

HOT DIP GALVANIZED THK. = 0.75mm

T.O.PA.

F.G.L.

T.O.F.

T.O.B.

B.O.G.

T.O.PED.

T.O.S

B.O.GU.

L.P.L.

H.P.L.

B.O.S.

TOP OF PAVING

FINISH GRADING LEVEL

TOP OF FOUNDATION

TOP OF BEAM

BOTTOM OF GIRT

TOP OF PEDESTAL

TOP OF SHELTER

BOTTOM OF GUTTER

LOWEST POINT LEVEL

HIGHEST POINT LEVEL

BOTTOM OF SLEEVE

REFERENCE DRAWING	DRG. No.
STANDARD DRAWING FOR ARCHITECTURAL DETAILS	BK-GNRL-PEDCO-000-AR-DW-0001
SITE SEWAGE SYSTEM LAYOUT & DETAILS	BK-GCS-PEDCO-120-CV-PY-0001
CABLE TRENCH AND DUCT BANK LAYOUT	BK-GCS-PEDCO-120-CV-PY-0002
ROAD, PAVING AND PLANT FINISH GRADING LAYOUT & SECTIONS	BK-GCS-PEDCO-120-CV-PY-0005
ELECTRICAL CABLE ROUTE & SECTION LAYOUT FOR BUILDING & SHELTER	BK-GCS-PEDCO-120-EL-PY-0006
FOUNDATION DRAWING FOR FIRE WATER PUMP SHELTER	BK-GCS-PEDCO-120-ST-DW-0006
STRUCTURAL DRAWING FOR FIRE WATER PUMP SHELTER	BK-GCS-PEDCO-120-ST-DW-0006
UNIT PLAT PLAN FOR PIG RECEIVER AREA (IN SAHABKAN G.I. SYSTEM)	BK-PPL-PEDCO-320-PI-PY-0001

KEY PLAN

THIS AREA

REV.	DATE	DESCRIPTION	BY	DATE	CHECKED	DATE	REV. APPR.
D01	JUL.2023	IFA	R.BERLOUE	M.FAKHARIAN	A.M.MOHSEN	** **	
D00	OCT.2022	IPC	R.BERLOUE	M.FAKHARIAN	M.MEHRSHAD	** **	

PROJECT NAME:

BINAK OILFIELD DEVELOPMENT/SURFACE FACILITIES  
GAS COMPRESSOR STATION

PROJECT NO.:

971020

EPC CONTRACTOR:

HIRGAN ENERGY - DESIGN & INSPECTION  
COMPANIES

EPD/EPC CONTRACTOR (GC):

PEDCO  
PETROIRAN  
DEVELOPMENT  
COMPANY

DRAWING TITLE:

ARCHITECTURAL DRAWING FOR FIRE WATER PUPS SHELTER

NO CONSTRUCTION PERMITTED UNLESS DRAWING APPROVED

APPROVED FOR CONSTRUCTION

BY:

DATE:

SCALE	SIZE	DRAWING NO.	SHEET NO.	REV.	BUDGET REF.	LOCATION	SIZE	CLASS	SERIAL NO.	SHEET	REVISION
AS SHOWN	A1	BK-GCS-PEDCO-120-AR-DW-0006	02 OF 07	D01	053-073-9184	F	4	B	709104	02 OF 07	D01

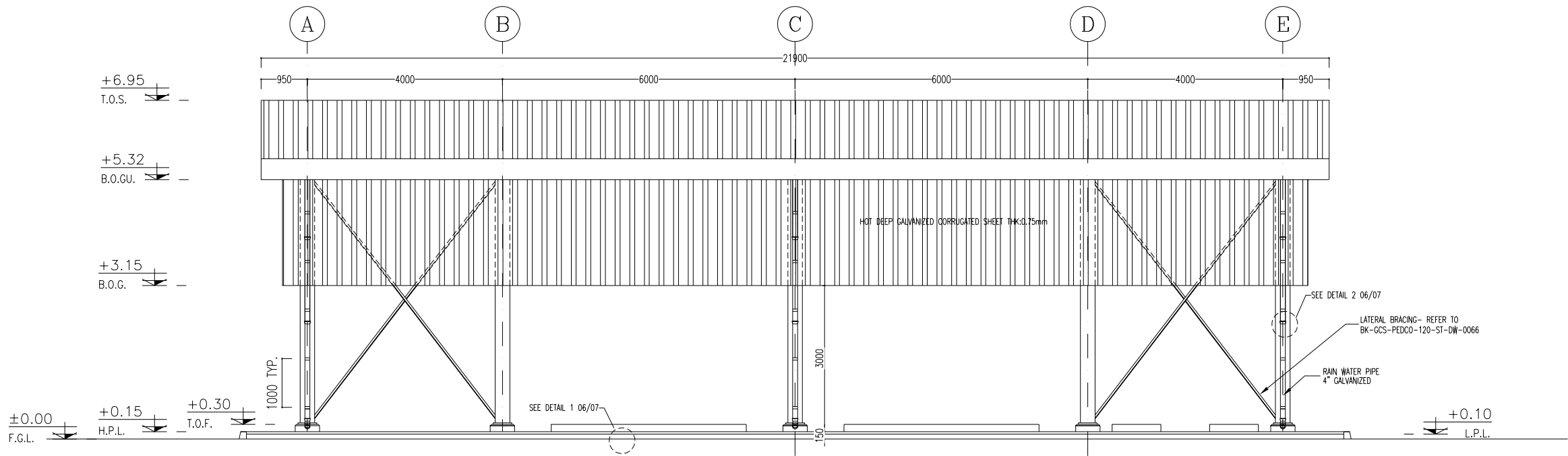

SC.1:50 1 OF 05 ELEVATION

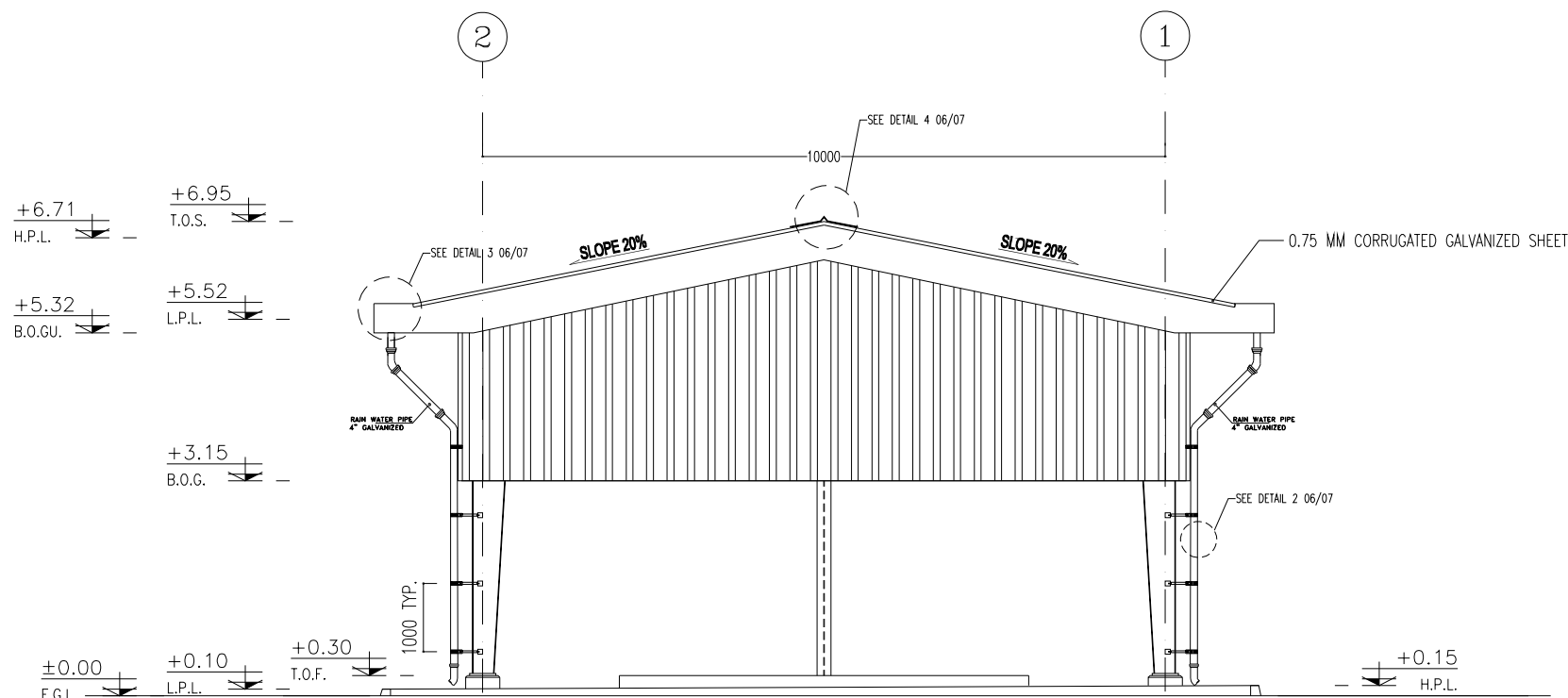

SC.1:50 2 OF 05 ELEVATION

NOTES

1. ALL DIMENSIONS ARE IN MILLIMETER & ALL ELEVATIONS ARE IN METER.
2. ALL DIMENSIONS AND ELEVATIONS SHALL BE CHECKED BY THE CONTRACTOR PRIOR TO CONSTRUCTION.
3. CONTRACTOR SHALL COMPLY ALL ARCHITECTURAL, MECHANICAL, ELECTRICAL, PIPING AND STRUCTURAL DRAWINGS AND IN CASE OF ANY CONFLICTS OR DISCREPANCY, INFORM THE ENGINEER.
4. ALL MATERIALS ARE SELECTED FROM THE HIGHEST QUALITY AND MUST BE APPROVED BY THE CLIENT.
5. ALL OPENINGS FOR PIPING/CABLEING AND HVAC OPENINGS SHALL BE CONSIDERED AS PER RELATED DRAWINGS BEFORE CONSTRUCTION.
6. FINISH GRADING LEVEL IS EQUIVALENT  $\pm 0.00$  LOCAL  $\pm 11.05$  GLOBAL (M.S.L.)

LEGEND

HOT DIP GALVANIZED THK. = 0.75mm



F.G.L. FINISH GRADING LEVEL  
T.O.F. TOP OF FOUNDATION  
T.O.B. TOP OF BEAM  
B.O.G. BOTTOM OF GIRT  
T.O.PED. TOP OF PEDESTAL  
T.O.S. TOP OF SHELTER  
B.O.GU. BOTTOM OF GUTTER  
L.P.L. LOWEST POINT LEVEL  
H.P.L. HIGHEST POINT LEVEL

REFERENCE DRAWING	DRG. No.
STANDARD DRAWING FOR ARCHITECTURAL DETAILS	BK-GNRL-PEDCO-000-AR-DW-0001
SITE SEWAGE SYSTEM LAYOUT & DETAILS	BK-GCS-PEDCO-120-CV-PY-0001
CABLE TRENCH AND DUCT BANK LAYOUT	BK-GCS-PEDCO-120-CV-PY-0002
ROAD, PAVING AND PLANT FINISH GRADING LAYOUT & SECTIONS	BK-GCS-PEDCO-120-CV-PY-0005
ELECTRICAL CABLE ROUTES & SECTION LAYOUT FOR BUILDING & SHELTER	BK-GCS-PEDCO-120-EL-PY-0006
FOUNDATION DRAWING FOR FIRE WATER PUMP SHELTER	BK-GCS-PEDCO-120-ST-DW-0006
STRUCTURAL DRAWING FOR FIRE WATER PUMP SHELTER	BK-GCS-PEDCO-120-ST-DW-0006
UNIT PLANT PLAN FOR PLS RECEIVER AREA (IN SAHABKAN G.S. SECTION)	BK-PPL-PEDCO-320-PI-PY-0001

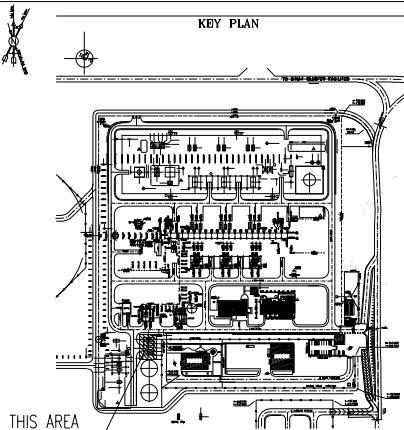

PROJECT NO.:	971020	EPD/EPC CONTRACTOR (GC):	PETROIRAN DEVELOPMENT COMPANY	BINAK OILFIELD DEVELOPMENT SURFACE FACILITIES GAS COMPRESSOR STATION
EPC CONTRACTOR:	HIRGAN ENERGY - DESIGN & INSPECTION COMPANIES	PEPCO		
DRAWING TITLE:	ARCHITECTURAL DRAWING FOR FIRE WATER PUPS SHELTER			
SCALE	SIZE	DRAWING NO.	SHEET NO.	REV.
AS SHOWN	A1	BK-GCS-PEDCO-120-AR-DW-0006	03 OF 07	D01
BUDGET REF.	LOCATION	SIZE	CLASS	SERIAL NO.
053-073-9184	F	4	B	709104
APPROVED FOR CONSTRUCTION	BY:	DATE:		
DATE:	SCALE	DRAWING BY	CHECKED BY	PROJECT ENG.
NO CONSTRUCTION PERMITTED UNLESS DRAWING APPROVED				
APPROVED FOR CONSTRUCTION	BY:	DATE:		

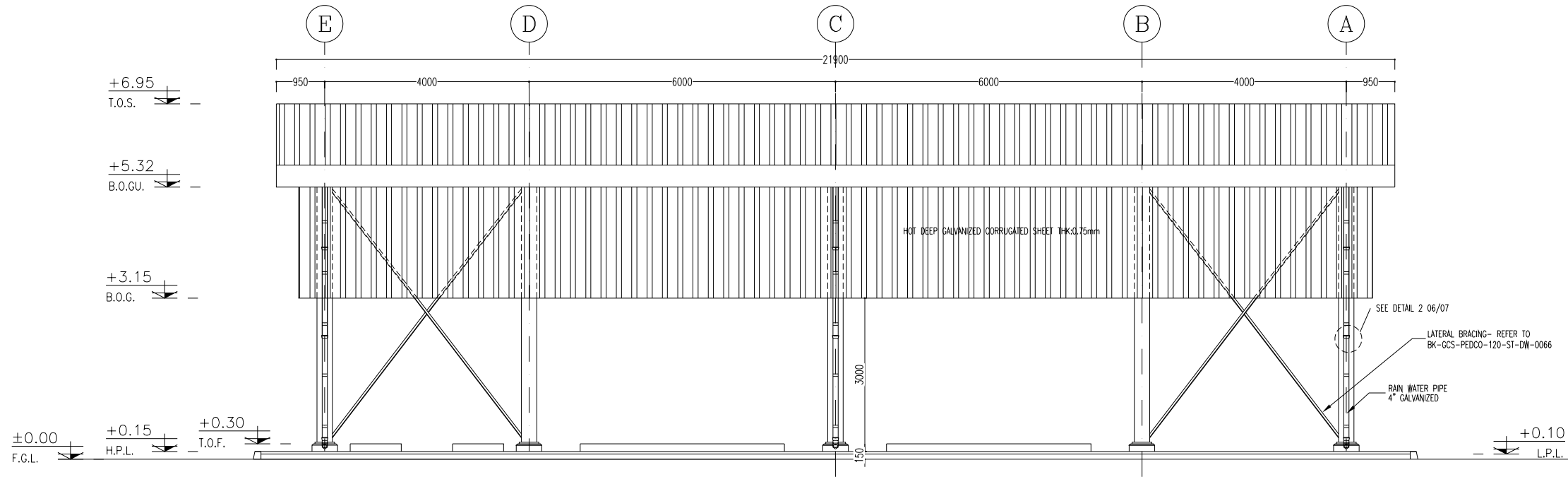

3 ELEVATION  
SC.1:50  
01 OF 05

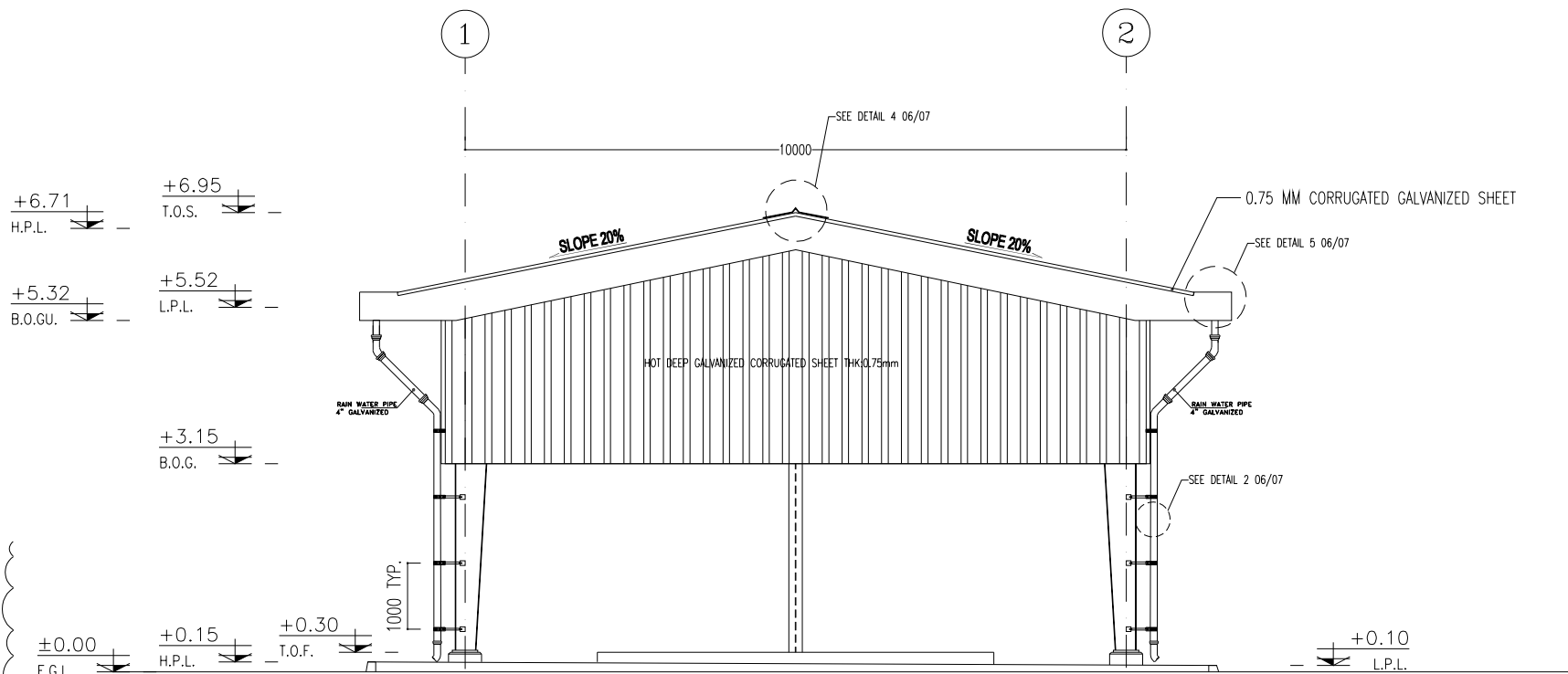

4 ELEVATION  
SC.1:50  
01 OF 05

NOTES

1. ALL DIMENSIONS ARE IN MILLIMETER & ALL ELEVATIONS ARE IN METER.
2. ALL DIMENSIONS AND ELEVATIONS SHALL BE CHECKED BY THE CONTRACTOR PRIOR TO CONSTRUCTION.
3. CONTRACTOR SHALL COMPARE ALL ARCHITECTURAL, MECHANICAL, ELECTRICAL, PIPING AND STRUCTURAL DRAWINGS AND IN CASE OF ANY CONFLICTS OR DISCREPANCY, INFORM THE ENGINEER.
4. ALL MATERIALS ARE SELECTED FROM THE HIGHEST QUALITY AND MUST BE APPROVED BY THE CLIENT.
5. ALL OPENINGS FOR PIPING/CABLEING AND HVAC OPENINGS SHALL BE CONSIDERED AS PER RELATED DRAWINGS BEFORE CONSTRUCTION.
6. FINISH GRADING LEVEL IS EQUIVALENT=±0.00 LOCAL=+11.05 GLOBE(M.S.L.)

LEGEND

HOT DIP GALVANIZED THK. = 0.75mm



F.G.L. FINISH GRADING LEVEL  
T.O.F. TOP OF FOUNDATION  
T.O.B. TOP OF BEAM  
B.O.G. BOTTOM OF GIRT  
T.O.PED. TOP OF PEDESTAL  
T.O.S. TOP OF SHELTER  
B.O.GU. BOTTOM OF GUTTER  
L.P.L. LOWEST POINT LEVEL  
H.P.L. HIGHEST POINT LEVEL  
B.O.S. BOTTOM OF SLEEVE

REFERENCE DRAWING	DRG. No.
STANDARD DRAWING FOR ARCHITECTURAL DETAILS	BK-GNRL-PEDCO-000-AR-DW-0001
SITE SEWAGE SYSTEM LAYOUT & DETAILS	BK-GCS-PEDCO-120-CV-PY-0001
CABLE TRENCH AND DUCT BANK LAYOUT	BK-GCS-PEDCO-120-CV-PY-0002
ROAD, PAVING AND PLANT FINISH GRADING LAYOUT & SECTIONS	BK-GCS-PEDCO-120-CV-PY-0005
ELECTRICAL CABLE ROUTE & SECTION LAYOUT FOR BUILDING & SHEDS	BK-GCS-PEDCO-120-EL-PY-0005
FOUNDATION DRAWING FOR FIRE WATER PUMP SHEDS	BK-GCS-PEDCO-120-ST-DW-0005
STRUCTURAL DRAWING FOR FIRE WATER PUMP SHEDS	BK-GCS-PEDCO-120-ST-DW-0006
UNIT PLANT PLAN FOR PLS RECEIVER AREA (IN SHAMKAN G.S. SECTION)	BK-PPL-PEDCO-320-PI-PY-0001

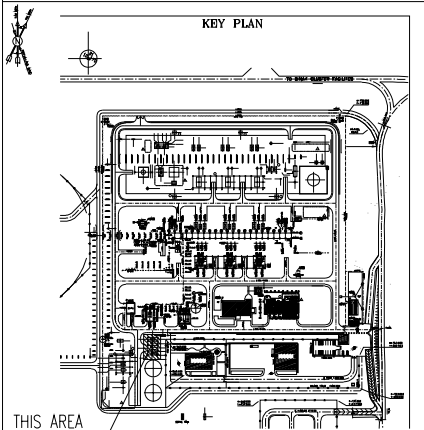

																																																																																																																																																																																																																																																																																																																																																																																																																																																																																																																																																																																																																																																																																																																																																																																																																																																																																																																																																																																																																																																																																																																																																																																																																																																																																																																																																																																																																																																								</
--	--	--	--	--	--	--	--	--	--	--	--	--	--	--	--	--	--	--	--	--	--	--	--	--	--	--	--	--	--	--	--	--	--	--	--	--	--	--	--	--	--	--	--	--	--	--	--	--	--	--	--	--	--	--	--	--	--	--	--	--	--	--	--	--	--	--	--	--	--	--	--	--	--	--	--	--	--	--	--	--	--	--	--	--	--	--	--	--	--	--	--	--	--	--	--	--	--	--	--	--	--	--	--	--	--	--	--	--	--	--	--	--	--	--	--	--	--	--	--	--	--	--	--	--	--	--	--	--	--	--	--	--	--	--	--	--	--	--	--	--	--	--	--	--	--	--	--	--	--	--	--	--	--	--	--	--	--	--	--	--	--	--	--	--	--	--	--	--	--	--	--	--	--	--	--	--	--	--	--	--	--	--	--	--	--	--	--	--	--	--	--	--	--	--	--	--	--	--	--	--	--	--	--	--	--	--	--	--	--	--	--	--	--	--	--	--	--	--	--	--	--	--	--	--	--	--	--	--	--	--	--	--	--	--	--	--	--	--	--	--	--	--	--	--	--	--	--	--	--	--	--	--	--	--	--	--	--	--	--	--	--	--	--	--	--	--	--	--	--	--	--	--	--	--	--	--	--	--	--	--	--	--	--	--	--	--	--	--	--	--	--	--	--	--	--	--	--	--	--	--	--	--	--	--	--	--	--	--	--	--	--	--	--	--	--	--	--	--	--	--	--	--	--	--	--	--	--	--	--	--	--	--	--	--	--	--	--	--	--	--	--	--	--	--	--	--	--	--	--	--	--	--	--	--	--	--	--	--	--	--	--	--	--	--	--	--	--	--	--	--	--	--	--	--	--	--	--	--	--	--	--	--	--	--	--	--	--	--	--	--	--	--	--	--	--	--	--	--	--	--	--	--	--	--	--	--	--	--	--	--	--	--	--	--	--	--	--	--	--	--	--	--	--	--	--	--	--	--	--	--	--	--	--	--	--	--	--	--	--	--	--	--	--	--	--	--	--	--	--	--	--	--	--	--	--	--	--	--	--	--	--	--	--	--	--	--	--	--	--	--	--	--	--	--	--	--	--	--	--	--	--	--	--	--	--	--	--	--	--	--	--	--	--	--	--	--	--	--	--	--	--	--	--	--	--	--	--	--	--	--	--	--	--	--	--	--	--	--	--	--	--	--	--	--	--	--	--	--	--	--	--	--	--	--	--	--	--	--	--	--	--	--	--	--	--	--	--	--	--	--	--	--	--	--	--	--	--	--	--	--	--	--	--	--	--	--	--	--	--	--	--	--	--	--	--	--	--	--	--	--	--	--	--	--	--	--	--	--	--	--	--	--	--	--	--	--	--	--	--	--	--	--	--	--	--	--	--	--	--	--	--	--	--	--	--	--	--	--	--	--	--	--	--	--	--	--	--	--	--	--	--	--	--	--	--	--	--	--	--	--	--	--	--	--	--	--	--	--	--	--	--	--	--	--	--	--	--	--	--	--	--	--	--	--	--	--	--	--	--	--	--	--	--	--	--	--	--	--	--	--	--	--	--	--	--	--	--	--	--	--	--	--	--	--	--	--	--	--	--	--	--	--	--	--	--	--	--	--	--	--	--	--	--	--	--	--	--	--	--	--	--	--	--	--	--	--	--	--	--	--	--	--	--	--	--	--	--	--	--	--	--	--	--	--	--	--	--	--	--	--	--	--	--	--	--	--	--	--	--	--	--	--	--	--	--	--	--	--	--	--	--	--	--	--	--	--	--	--	--	--	--	--	--	--	--	--	--	--	--	--	--	--	--	--	--	--	--	--	--	--	--	--	--	--	--	--	--	--	--	--	--	--	--	--	--	--	--	--	--	--	--	--	--	--	--	--	--	--	--	--	--	--	--	--	--	--	--	--	--	--	--	--	--	--	--	--	--	--	--	--	--	--	--	--	--	--	--	--	--	--	--	--	--	--	--	--	--	--	--	--	--	--	--	--	--	--	--	--	--	--	--	--	--	--	--	--	--	--	--	--	--	--	--	--	--	--	--	--	--	--	--	--	--	--	--	--	--	--	--	--	--	--	--	--	--	--	--	--	--	--	--	--	--	--	--	--	--	--	--	--	--	--	--	--	--	--	--	--	--	--	--	--	--	--	--	--	--	--	--	--	--	--	--	--	--	--	--	--	--	--	--	--	--	--	--	--	--	--	--	--	--	--	--	--	--	--	--	--	--	--	--	--	--	--	--	--	--	--	--	--	--	--	--	--	--	--	--	--	--	--	--	--	--	--	--	--	--	--	--	--	--	--	--	--	--	--	--	--	--	--	--	--	--	--	--	--	--	--	--	--	--	--	--	--	--	--	--	--	--	--	--	--	--	--	--	--	--	--	--	--	--	--	--	--	--	--	--	--	--	--	--	--	--	--	--	--	--	--	--	--	--	--	--	--	--	--	--	--	--	--	--	--	--	--	--	--	--	--	--	--	--	--	--	--	--	--	--	--	--	--	--	--	--	--	--	--	--	--	--	--	--	--	--	--	--	--	--	--	--	--	--	--	--	--	--	--	--	--	--	--	--	--	--	--	--	--	--	--	--	--	--	--	--	--	--	--	--	--	--	--	--	--	--	--	--	--	--	--	--	--	--	--	--	--	--	--	--	--	--	--	--	--	--	--	--	--	--	--	--	--	--	--	--	--	--	--	--	--	--	--	--	--	--	--	--	--	--	--	--	--	--	--	--	--	--	--	--	--	--	--	--	--	--	--	--	--	--	--	--	--	--	--	--	--	--	--	--	--	--	--	--	--	--	--	--	--	--	--	--	--	--	--	--	--	--	--	--	--	--	--	--	--	--	--	--	--	--	--	--	--	--	--	--	--	--	--	--	--	--	--	--	--	--	--	--	--	--	--	--	--	--	--	--	--	--	--	--	--	--	--	--	--	--	--	--	--	--	--	--	--	--	--	--	--	--	--	--	--	--	--	--	--	--	--	--	--	--	--	--	--	--	--	--	--	--	--	--	--	--	--	--	--	--	--	--	--	--	--	--	--	--	--	--	--	--	--	--	--	--	--	--	--	--	--	--	--	--	--	--	--	--	--	--	--	--	--	--	--	--	--	--	--	--	--	--	--	--	--	--	--	--	--	--	--	--	--	--	--	--	--	--	--	--	--	--	--	--	--	--	----

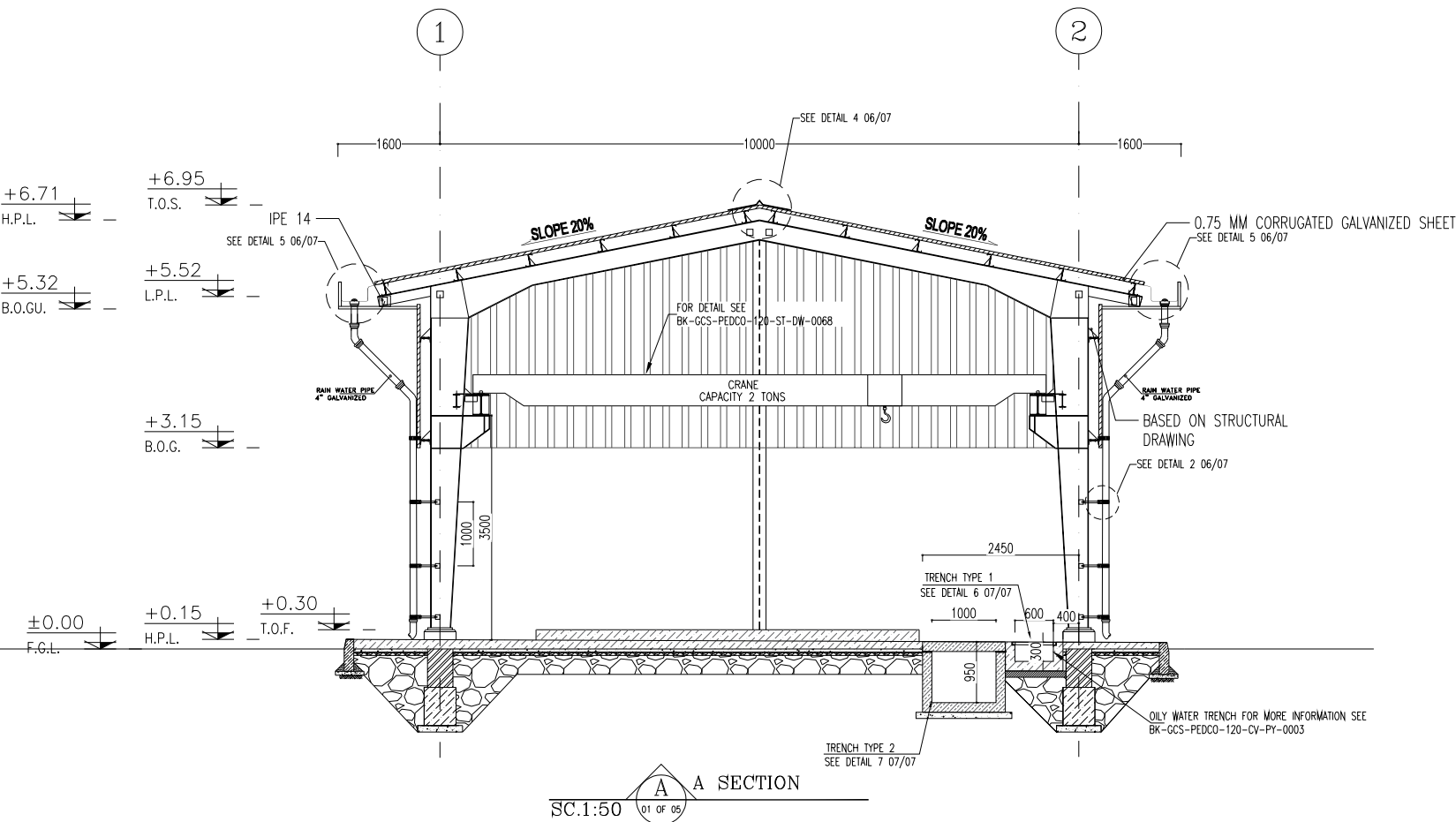
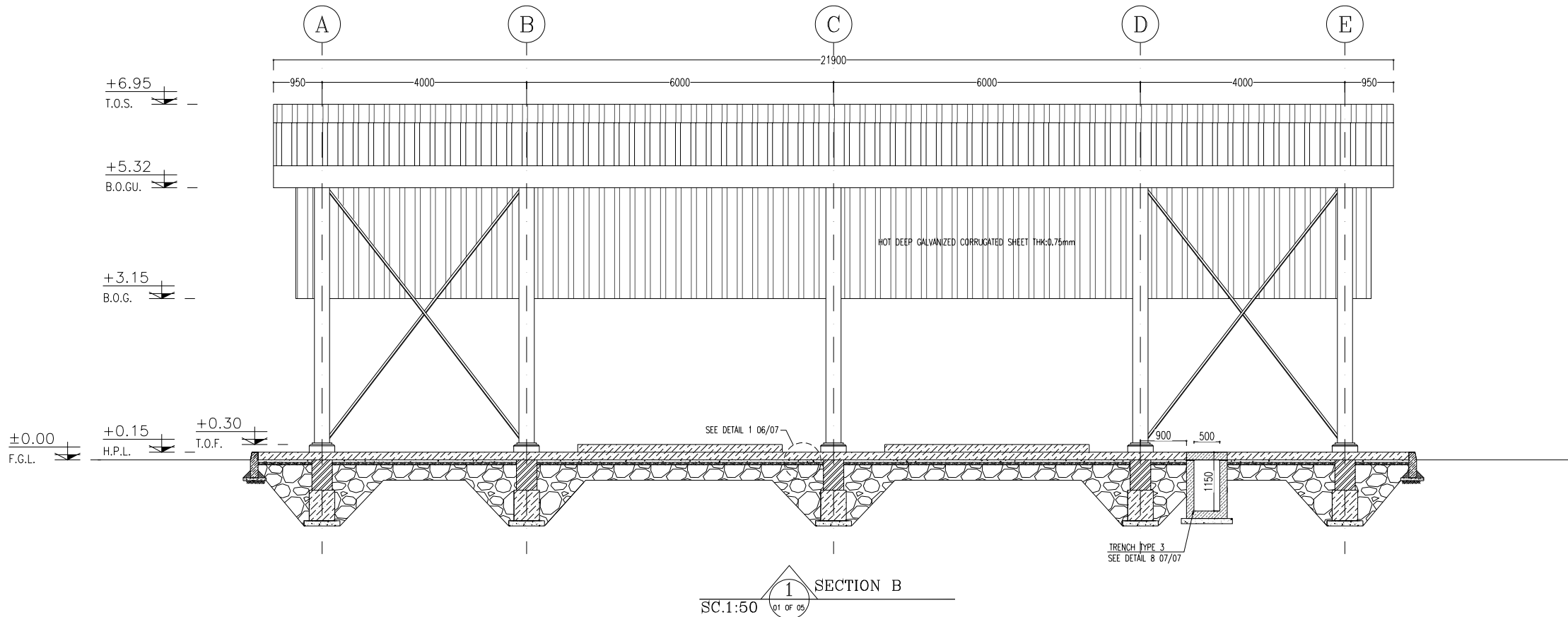

# NOTES

1. ALL DIMENSIONS ARE IN MILLIMETER & ALL ELEVATIONS ARE IN METER.
2. ALL DIMENSIONS AND ELEVATIONS SHALL BE CHECKED BY THE CONTRACTOR PRIOR TO CONSTRUCTION.
3. CONTRACTOR SHALL COMPLY ALL ARCHITECTURAL, MECHANICAL, ELECTRICAL, PIPING AND STRUCTURAL DRAWINGS AND IN CASE OF ANY CONFLICTS OR DISCREPANCY, INFORM THE ENGINEER.
4. ALL MATERIALS ARE SELECTED FROM THE HIGHEST QUALITY AND MUST BE APPROVED BY THE CLIENT.
5. ALL OPENINGS FOR PIPING/CABLEING AND HVAC OPENINGS SHALL BE CONSIDERED AS PER RELATED DRAWINGS BEFORE CONSTRUCTION.
6. FINISH GRADING LEVEL IS EQUIVALENT=±0.00 LOCAL=+11.05 GLOBAL(M.S.L.)

## LEGEND

HOT DIP GALVANIZED THK. = 0.75mm	
REINFORCED CONCRETE	
BLOCKAGE	
PRESSED BRICK	
LEAN CONCRETE	

F.G.L.	FINISH GRADING LEVEL
T.O.F.	TOP OF FOUNDATION
T.O.B.	TOP OF BEAM
B.O.G.	BOTTOM OF GIRT
T.O.PED.	TOP OF PEDESTAL
T.O.S.	TOP OF SHELTER
B.O.GU.	BOTTOM OF GUTTER
L.P.L.	LOWEST POINT LEVEL
H.P.L.	HIGHEST POINT LEVEL
B.O.S.	BOTTOM OF SLEEVE

REFERENCE DRAWING	DRG. No.
STANDARD DRAWING FOR ARCHITECTURAL DETAILS	BK-GNRL-PEDCO-000-AR-DW-0001
SITE SEWAGE SYSTEM LAYOUT & DETAILS	BK-GCS-PEDCO-120-CV-PY-0001
CABLE TRENCH AND DUCT BANK LAYOUT	BK-GCS-PEDCO-120-CV-PY-0002
ROAD, PAVING AND PLANT FINISH GRADING LAYOUT & SECTIONS	BK-GCS-PEDCO-120-CV-PY-0005
ELECTRICAL CABLE ROUTE & SECTION LAYOUT FOR BUILDING & INSULATOR	BK-GCS-PEDCO-120-EL-PY-0006
FOUNDATION DRAWING FOR FIRE WATER PUMP INSULATOR	BK-GCS-PEDCO-120-ST-DW-0006
STRUCTURAL DRAWING FOR FIRE WATER PUMP INSULATOR	BK-GCS-PEDCO-120-ST-DW-0006
UNIT PLANT PLAN FOR PIG RECEIVER AREA (IN SAHABANAN G.I. SECTION)	BK-PPL-PEDCO-320-PI-PY-0001

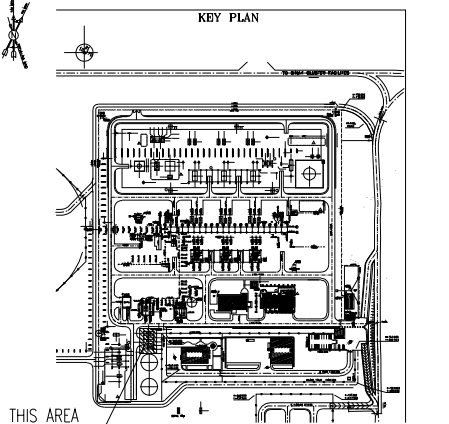

REV.	DATE	BY	DATE	BY	DATE
D01	JUL.2023	IFA	R.BERLOUE	M.FAKHARIAN	A.M.MOHSEN
D00	OCT.2022	IPC	R.BERLOUE	M.FAKHARIAN	M.MEHRSHAD
REV.	DATE	P.O.I.S	PREP.	CHK.	APP.
PROJECT NAME: BINAK OILFIELD DEVELOPMENT/SURFACE FACILITIES GAS COMPRESSOR STATION					
PROJECT NO.: 971020					
EPC CONTRACTOR: HIRGAN ENERGY - DESIGN & INSPECTION COMPANIES			EPD/EPC CONTRACTOR (GC): PETROIRAN DEVELOPMENT COMPANY		
DRAWING TITLE: ARCHITECTURAL DRAWING FOR FIRE WATER PUPS SHELTER					
NO CONSTRUCTION PERMITTED UNLESS DRAWING APPROVED					
APPROVED FOR CONSTRUCTION BY: DATE:					
SCALE	SIZE	DRAWING NO.	SHEET NO.	REV.	BUDGET REF.
AS SHOWN	A1	BK-GCS-PEDCO-120-AR-DW-0006	06 OF 07	D01	053-073-9184

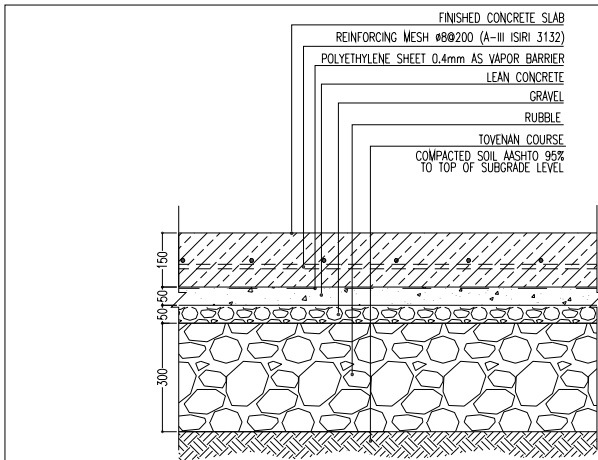

1 DETAIL  
SC.1:10

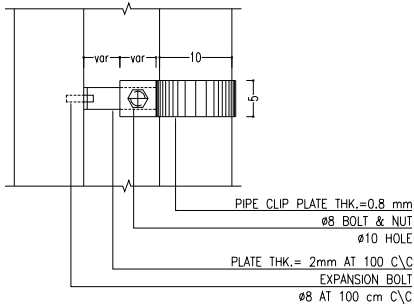

2 DETAIL  
SC.N.T.S

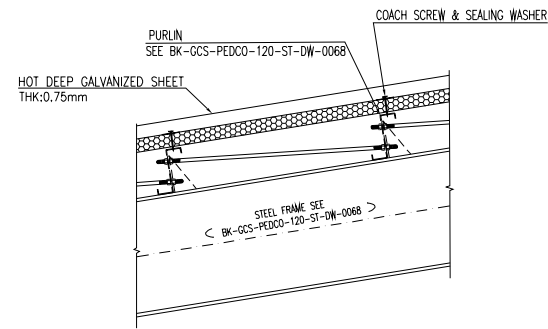
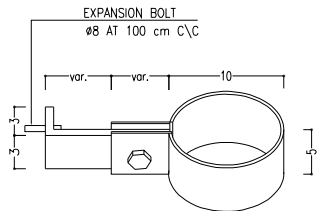

3 DETAIL  
SC.1:10

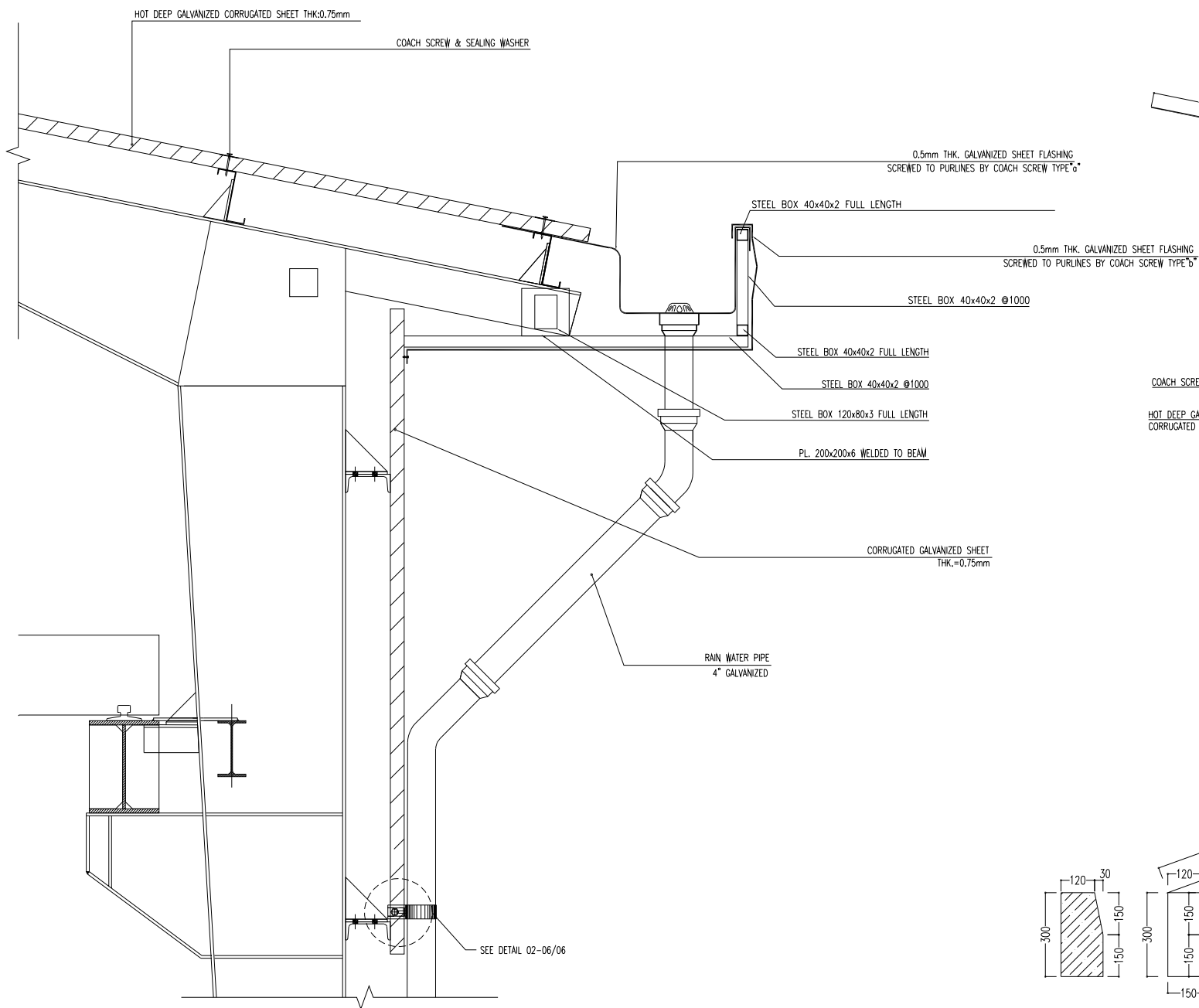

5 DETAIL  
SC.1:10

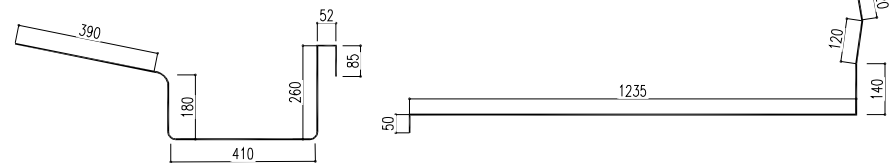

TYPE "a"

TYPE "b"

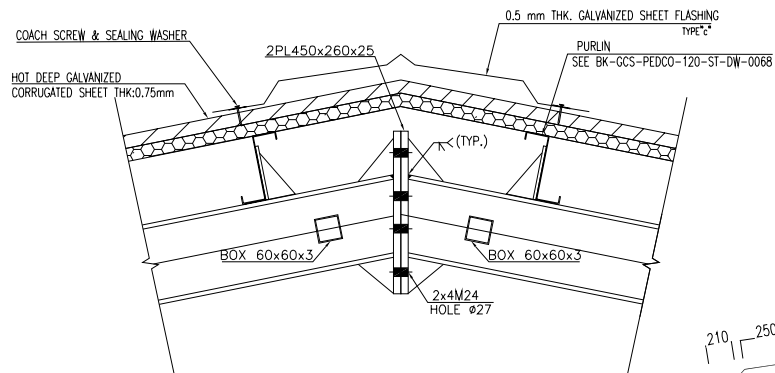

4 DETAIL  
SC.1:10

TYPE "c"  
SC.1:5

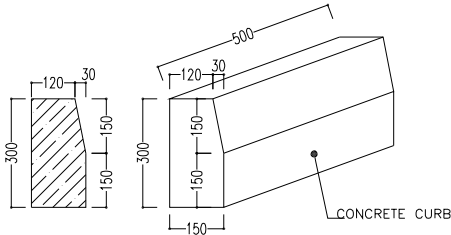

6 DETAIL  
SC.1:10

**NOTES**

1. ALL DIMENSIONS ARE IN MILLIMETER & ALL ELEVATIONS ARE IN METER.
2. ALL DIMENSIONS AND ELEVATIONS SHALL BE CHECKED BY THE CONTRACTOR PRIOR TO CONSTRUCTION.
3. CONTRACTOR SHALL COMPLY ALL ARCHITECTURAL, MECHANICAL, ELECTRICAL, PIPING AND STRUCTURAL DRAWINGS AND IN CASE OF ANY CONFLICTS OR DISCREPANCY, INFORM THE ENGINEER.
4. ALL MATERIALS ARE SELECTED FROM THE HIGHEST QUALITY AND MUST BE APPROVED BY THE CLIENT.
5. ALL OPENINGS FOR PIPING/CABLES AND HVAC OPENINGS SHALL BE CONSIDERED AS PER RELATED DRAWINGS BEFORE CONSTRUCTION.
6. FINISH GRADING LEVEL IS EQUIVALENT+0.00 LOCAL=+11.05 GLOBAL(M.S.L.)

**LEGEND**

HOT DIP GALVANIZED THK. = 0.75mm	
REINFORCED CONCRETE	
BLOCKAGE	
PRESSED BRICK	
LEAN CONCRETE	

F.G.L. FINISH GRADING LEVEL  
T.O.F. TOP OF FOUNDATION  
T.O.B. TOP OF BEAM  
B.O.G. BOTTOM OF GIRT  
T.O.PED. TOP OF PEDESTAL  
T.O.S. TOP OF SHELTER  
B.O.GU. BOTTOM OF GUTTER  
L.P.L. LOWEST POINT LEVEL  
H.P.L. HIGHEST POINT LEVEL  
B.O.S. BOTTOM OF SLEEVE

REFERENCE DRAWING	DRG. No.
STANDARD DRAWING FOR ARCHITECTURAL DETAILS	BK-GNRL-PEDCO-000-AR-DW-0001
SITE SEWAGE SYSTEM LAYOUT & DETAILS	BK-GCS-PEDCO-120-CV-PY-0001
CABLE TRENCH AND DUCT BANK LAYOUT	BK-GCS-PEDCO-120-CV-PY-0002
ROAD, PAVING AND PLANT FINISH GRADING LAYOUT & SECTIONS	BK-GCS-PEDCO-120-CV-PY-0005
ELECTRICAL CABLE ROUTE & SECTION LAYOUT FOR BUILDING & SHEDS	BK-GCS-PEDCO-120-EL-PY-0006
FOUNDATION DRAWING FOR FIRE WATER PUMP SHEDS	BK-GCS-PEDCO-120-ST-DW-0006
STRUCTURAL DRAWING FOR FIRE WATER PUMP SHEDS	BK-GCS-PEDCO-120-ST-DW-0008
UNIT PLANT PLAN FOR PLS RECEIVER AREA (IN SHAHANAN G.S. SECTION)	BK-PPL-PEDCO-320-PY-0001

**KEY PLAN**

REV.	DESCRIPTION	BY	DATE	CHECKED	REV. APPR.	
D01	JUL.2023	IFA	R.BERLOUE	M.FAKHARIAN	A.M.MOHESEN	**
D00	OCT.2022	IPC	R.BERLOUE	M.FAKHARIAN	M.MEHRSHAD	**
REV.	DATE	P.O.I.S	PREP.	CHK.	APP.	AUT.

PROJECT NAME: BINAK OILFIELD DEVELOPMENT/SURFACE FACILITIES GAS COMPRESSOR STATION

PROJECT NO.: 971020

EPC CONTRACTOR: **HIRGAN ENERGY - DESIGN & INSPECTION COMPANIES**

EPD/EPC CONTRACTOR (GC): **PETROIRAN DEVELOPMENT COMPANY**

DRAWING TITLE: ARCHITECTURAL DRAWING FOR FIRE WATER PUPS SHELTER

SCALE	SIZE	DRAWING NO.	SHEET NO.	REV.	BUDGET REF.	LOCATION	SIZE	CLASS	SERIAL NO.	SHEET	REVISION
AS SHOWN	A1	BK-GCS-PEDCO-120-AR-DW-0006	06 OF 07	D01	053-073-9184	F	4	B	709104	06 OF 07	D01

امحل و کلیه نسخ این نقشه و حق اقتباس متعلق به شرکت ملی مناطق نفت خیز جنوب میباشند.

THE ORIGINAL AND ALL COPIES OF THIS DRAWING TOGETHER WITH THE COPYRIGHT THEREIN ARE THE SOLE PROPERTY OF N.I.S.O.C./ FIELDS

**BINAK OILFIELD DEVELOPMENT SURFACE FACILITIES GAS COMPRESSOR STATION**

DATE	SCALE	DRAWING BY	CHECKED BY	PROJECT ENG.

NO CONSTRUCTION PERMITTED UNLESS DRAWING APPROVED

APPROVED FOR CONSTRUCTION BY: DATE:

