

CONNECT TO SANITARY SEWERAGE NETWORK
BK-GCS-PEDCO-120-CV-PY-0001

100	CONTROL ROOM
101	RACK ROOM
102	PANTRY
103	WC
104	ENTRANCE

1 FLOOR PLAN
SC.1:50 Sewage Piping Layout

- NOTES
- GENERAL NOTES:
1. ALL DIMENSIONS AND COORDINATES ARE IN MILLIMETERS UNLESS OTHERWISE NOTED.
 2. ALL ELEVATIONS ARE IN METER FROM F.F.L. OF EACH ROOM.
 3. THIS DWG. SHOULD BE WORKED TOGETHER WITH THE OTHER MECHANICAL, ARCHITECTURAL ELECTRICAL DWGS. & ANY CONFLICT SHOULD CLARIFIED BY THE CONTRACTOR PRIOR TO CONSTRUCTION.
 4. ALL HORIZONTAL DOMESTIC WATER PIPES IN THE BUILDING SHALL RUN ABOVE THE FALSE CEILING UNLESS OTHERWISE SPECIFIED.
 5. MATERIAL OF DOMESTIC COLD AND HOT WATER PIPES OUTSIDE BUILDING ARE GALVANIZED STEEL IN ACCORDANCE WITH ASTM A53 AND FITTINGS ARE IN ACCORDANCE WITH ASME B16.12.
 6. DOMESTIC HOT WATER PIPING INSIDE THE BUILDING WILL BE COVERED WITH THERMAL INSULATION (WATER PIPE INSULATION) ACCORDING TO NBR TOPIC 16.
 7. DOMESTIC COLD WATER PIPING OUTSIDE THE BUILDING SHALL BE COVERED WITH ELASTOMERIC INSULATION (MIN 25MM)
 8. TOP OF THE SUPPORT STEEL STRUCTURE SHALL BE CONSIDERED AS B.O.P.
 9. MATERIAL OF SANITARY SEWER, VENT PIPES AND FITTINGS SHALL BE PVC-U (80-TYPE) IN ACCORDANCE WITH EN 1451.
 10. SLOPE OF SEWAGE PIPES ARE 1.5% - 2% TO DRAIN.
 11. MATERIAL OF DOMESTIC COLD AND HOT WATER PIPES INSIDE BUILDING SHALL BE FIVE LAYERED POLYETHYLENE PEX -AL- PEX ACCORDING TO ASTM F1281/1282 AND FITTINGS SHALL BE ACCORDING TO ASTM F1281/1282.
 12. MATERIAL OF HOT DIPPED GALVANIZED STEEL PIPE SHALL BE ACCORDING TO ASTM A53 GR B AND FITTINGS SHALL BE ACCORDING TO ASTM A234 GR WPB.
 13. ALL VALVES ABOVE THE FALSE CEILING SHALL HAVE ACCESS DOOR.
 14. THE WASTE FROM BUILDING TO WASTE WATER TREATMENT PLANT SHALL DISCHARGE BY GRAVITY FLOW.
 15. FINAL ROUTE FOR PLUMBING SHALL NOT BE OVER AND NEAR THE ELECTRICAL & CONTROL PANEL.

LEGEND

REFERENCE DRAWING	DRG. No.
HVAC & Plumbing Design Criteria	BK-GNRL-PEDCO-000-HV-DC-0001
Specification For Duct Work & Pipe Work	BK-GNRL-PEDCO-000-HV-SP-0002
Standard Drawing For HVAC & Plumbing	BK-GNRL-PEDCO-000-HV-DW-0001
Symbol & Legend For HVAC & Plumbing	BK-GNRL-PEDCO-000-HV-DW-0002
Architectural Drawing For CCTV Control Room - Binak GCS	BK-GCS-PEDCO-120-AR-DW-0008
Site Sewerage System Layout & Details	BK-GCS-PEDCO-120-CV-PY-0001
Unit Plot Plan Drawing	BK-GCS-PEDCO-120-PI-PY-0001

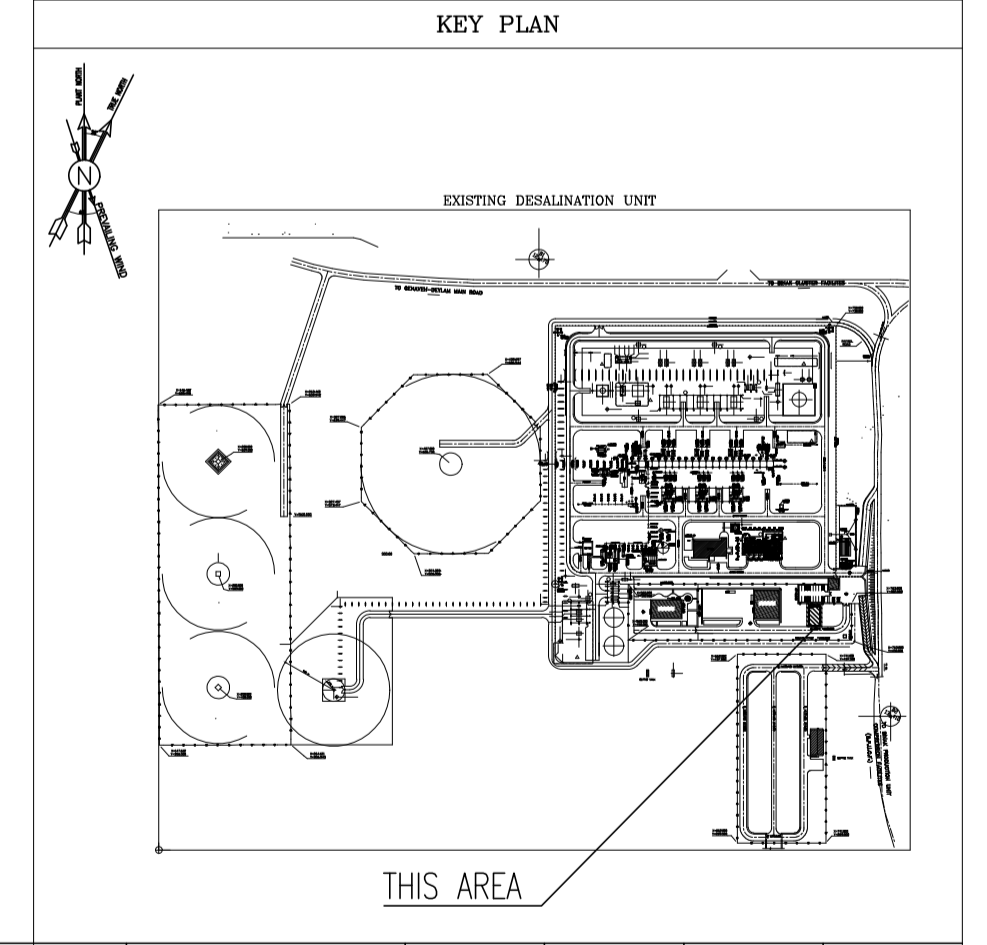

REV.	DESCRIPTION	CHECKED	DATE	BY	REV. APPR.	DATE	BY
***	*****	**	****	**	***	****	***
D00	OCT.2023	IFC	KAHMADI	M.PAKHARIAN	S.PARAMARZPOUR	***	
REV.	DATE	P.O.I.S	PREP.	CHK.	APP.	AUT.	
PROJECT NAME: BINAK OILFIELD DEVELOPMENT/SURFACE FACILITIES GAS COMPRESSOR STATION							
PROJECT NO.: 971020							
EPC CONTRACTOR: HIRGAN ENERGY - DESIGN & INSPECTION COMPANIES				EPD/EPC CONTRACTOR (GC): PETROIRAN DEVELOPMENT COMPANY			
DRAWING TITLE: Plumbing & Sewage Piping Layout For CCTV Control Room - BINAK GCS							
NO CONSTRUCTION PERMITTED UNLESS DRAWING APPROVED							
APPROVED FOR CONSTRUCTION BY: DATE:							
SCALE	SIZE	DRAWING NO.	SHEET NO.	REV.	BUDGET REF.	LOCATION	SIZE
AS SHOWN	A1	BK-GCS-PEDCO-120-HV-PY-0012	01 OF 02	D00	053-073-9184	F	4
						CLASS	SERIAL NO.
							709512
							SHEET
							01 OF 02
							REVISION
							D00

اظهار و کلیه نسخ این نقشه و حق اقتباس متعلق به شرکت ملی مناطق نفت خیز جنوب میباشد.
THE ORIGINAL AND ALL COPIES OF THIS DRAWING TOGETHER WITH THE COPYRIGHT THEREIN ARE THE SOLE PROPERTY OF N.I.S.O.C./ FIELDS

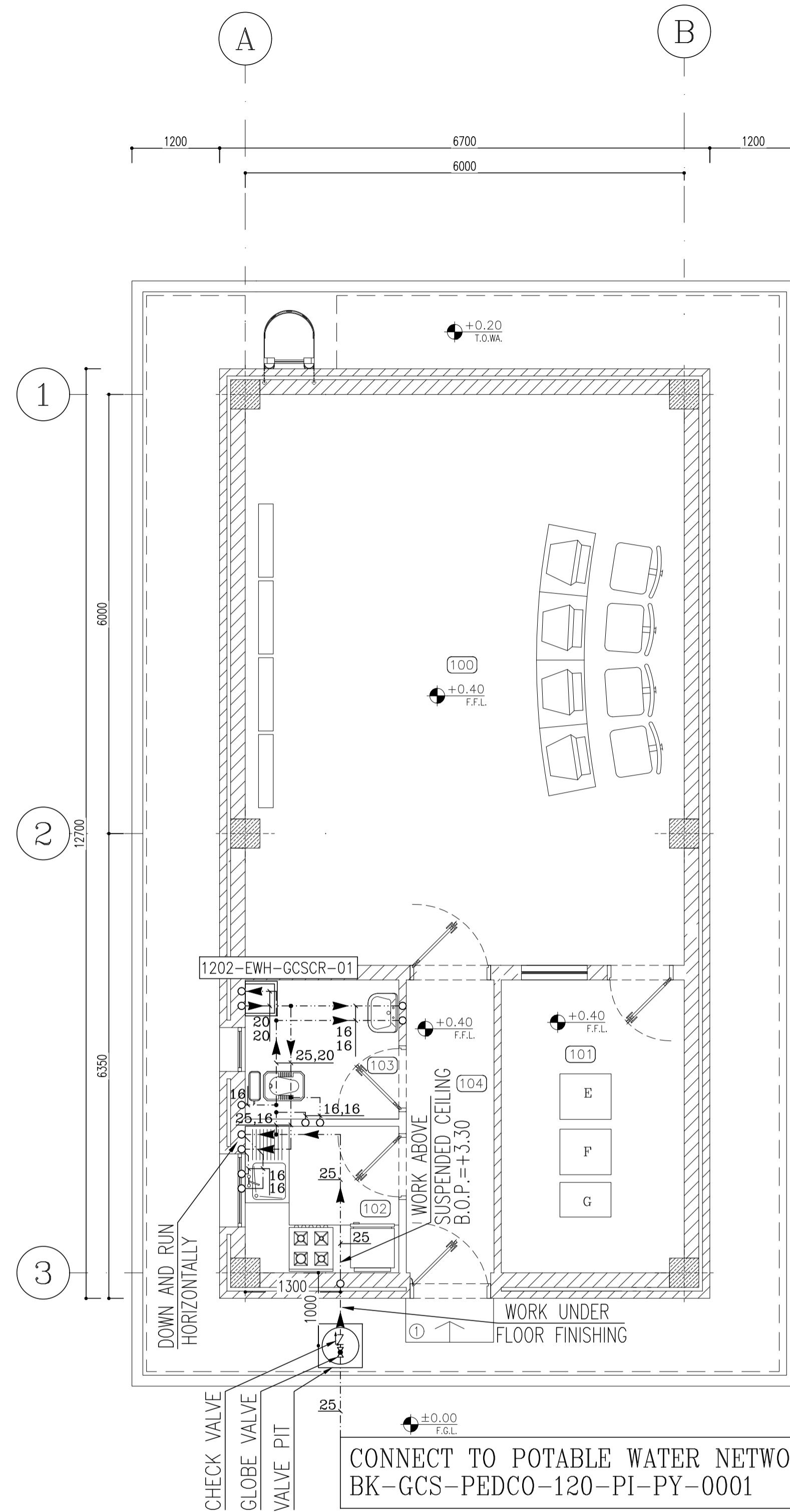
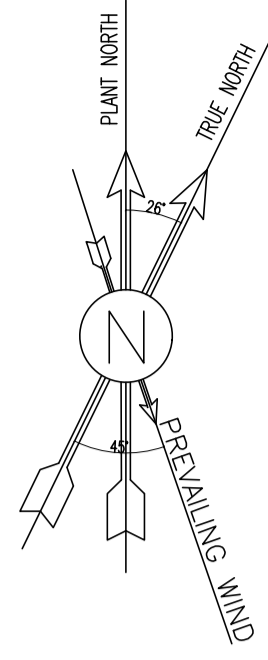

CONNECT TO POTABLE WATER NETWORK
BK-GCS-PEDCO-120-PI-PY-0001

100	CONTROL ROOM
101	RACK ROOM
102	PANTRY
103	WC
104	ENTRANCE

SC.1:50 **2** FLOOR PLAN
Potable Water Piping Layout

Hot Water Demand per Fixture (Office)			
Fixture	Demand (GPH)	Quantity	Total Demand (GPH)
Basin, privet lavatory	2	1	2
Pantry Sink	10	1	10
Demand Factor	0.3		12
Storage Factor	2		

$V = 12 \times 0.3 \times 2 \times 3.785 = 27.252 \text{ Lit} \sim 30 \text{ Lit}$

AUTOMATIC ELECTRICAL WATER HEATER

EQUIPMENT NO.	QTY	INSTALLATION AREA	TYPE	NOMINAL STORAGE TANK CAPACITY (Liter)	STORAGE TANK MATERIAL CONSTRUCTION	ELECTRIC POWER SUPPLY V/PH/Hz	HEATING ELEMENT POWER (KW)	INCLUDING
1202-EWH-GCSCR-01	1	TOILET	WALL MOUNTED	30	GALVANIZED STEEL	230/1/50	2	STANDARD THERMOSTATS (A SAFETY CUT-OUT) PREVENTING THE ELECTRICALLY-LIVE PARTS TO BE IN CONTACT WITH WATER. AND EQUIPPED WITH DRAIN VALVE, TEMPERATURE GAGE AND ALL STANDARD ACCESSORIES

- NOTES**
- GENERAL NOTES:**
- ALL DIMENSIONS AND COORDINATES ARE IN MILLIMETERS UNLESS OTHERWISE NOTED.
 - ALL ELEVATIONS ARE IN METER FROM F.F.L. OF EACH ROOM.
 - THIS DWG. SHOULD BE WORKED TOGETHER WITH THE OTHER MECHANICAL ARCHITECTURAL ELECTRICAL DWGS. & ANY CONFLICT SHOULD CLARIFIED BY THE CONTRACTOR PRIOR TO CONSTRUCTION.
 - ALL HORIZONTAL DOMESTIC WATER PIPES IN THE BUILDING SHALL RUN ABOVE THE FALSE CEILING UNLESS OTHERWISE SPECIFIED.
 - MATERIAL OF DOMESTIC COLD AND HOT WATER PIPES OUTSIDE BUILDING ARE GALVANIZED STEEL IN ACCORDANCE WITH ASTM A53 AND FITTINGS ARE IN ACCORDANCE WITH ASME B16.12.
 - DOMESTIC HOT WATER PIPING INSIDE THE BUILDING WILL BE COVERED WITH THERMAL INSULATION (WATER PIPE INSULATION) ACCORDING TO NBR TOPIC 16.
 - DOMESTIC COLD WATER PIPING OUTSIDE THE BUILDING SHALL BE COVERED WITH ELASTOMERIC INSULATION (MIN 25MM)
 - TOP OF THE SUPPORT STEEL STRUCTURE SHALL BE CONSIDERED AS B.O.P.
 - MATERIAL OF SANITARY SEWER, VENT PIPES AND FITTINGS SHALL BE PVC-U (80-TYPE) IN ACCORDANCE WITH EN 1451.
 - SLOPE OF SEWAGE PIPES ARE 1.5% ~ 2% TO DRAIN.
 - MATERIAL OF DOMESTIC COLD AND HOT WATER PIPES INSIDE BUILDING SHALL BE FIVE LAYERED POLYETHYLENE PEX -AL- PEX ACCORDING TO ASTM F1281/1282 AND FITTINGS SHALL BE ACCORDING TO ASTM F1281/1282.
 - MATERIAL OF HOT DIPPED GALVANIZED STEEL PIPE SHALL BE ACCORDING TO ASTM A53 GR B AND FITTINGS SHALL BE ACCORDING TO ASTM A234 GR B.
 - ALL VALVES ABOVE THE FALSE CEILING SHALL HAVE ACCESS DOOR.
 - THE WASTE FROM BUILDING TO WASTE WATER TREATMENT PLANT SHALL DISCHARGE BY GRAVITY FLOW.
 - FINAL ROUTE FOR PLUMBING SHALL NOT BE OVER AND NEAR THE ELECTRICAL & CONTROL PANEL.

LEGEND

REFERENCE DRAWING	DRG. No.
HVAC & Plumbing Design Criteria	BK-GNRL-PEDCO-000-HV-DC-0001
Specification For Duct Work & Pipe Work	BK-GNRL-PEDCO-000-HV-SP-0002
Standard Drawing For HVAC & Plumbing	BK-GNRL-PEDCO-000-HV-DW-0001
Symbol & Legend For HVAC & Plumbing	BK-GNRL-PEDCO-000-HV-DW-0002
Architectural Drawing For CCTV Control Room - Binak GCS	BK-GCS-PEDCO-120-AR-DW-0008
Site Sewerage System Layout & Details	BK-GCS-PEDCO-120-CV-PY-0001
Unit Plot Plan Drawing	BK-GCS-PEDCO-120-PI-PY-0001

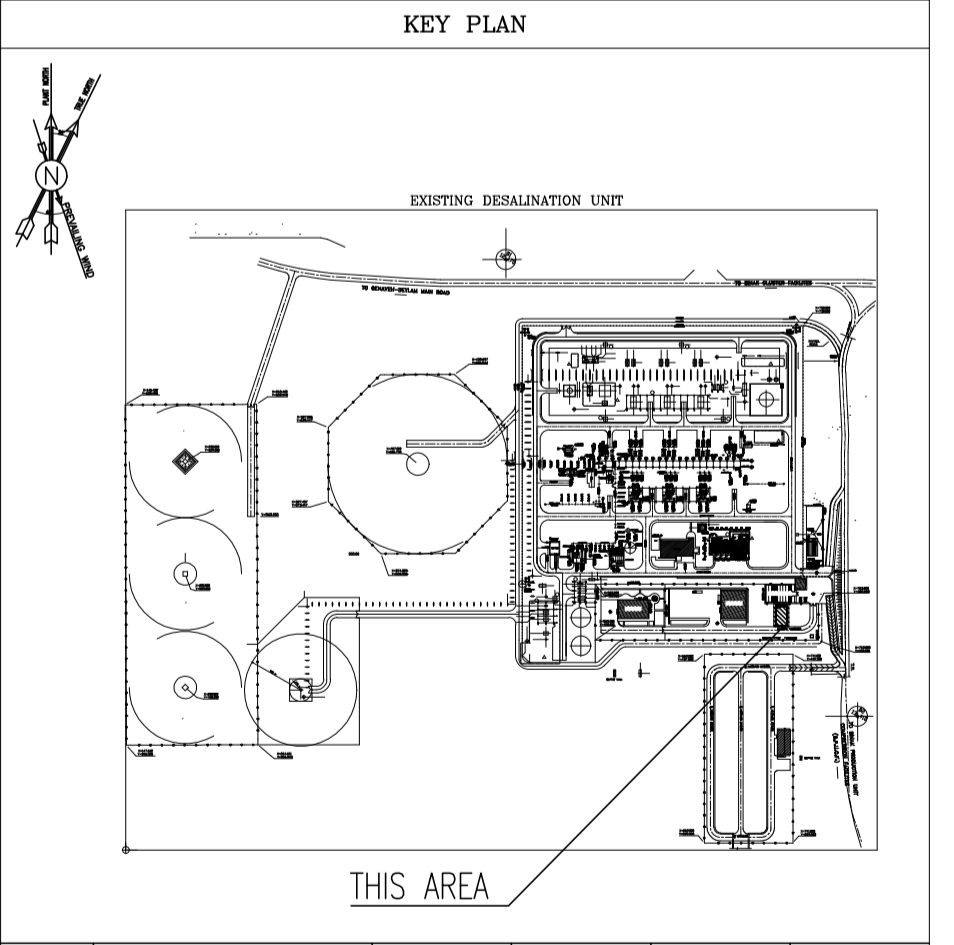

REV.	DATE	DESCRIPTION	CHECKED	DATE	BY	DATE	BY	DATE
D00	OCT.2023	IFC	K.AHMADI	M.PAKHARIAN	S.FARAMARZPOUR	***		
REV.	DATE	P.O.I.S	PREP.	CHK.	APP.	AUT.		

PROJECT NAME: BINAK OILFIELD DEVELOPMENT/SURFACE FACILITIES GAS COMPRESSOR STATION
PROJECT NO.: 971020

EPC CONTRACTOR: HIRGAN ENERGY
EPD/EPC CONTRACTOR (GC): PETROIRAN DEVELOPMENT COMPANY

BINAK OILFIELD DEVELOPMENT SURFACE FACILITIES GAS COMPRESSOR STATION

DATE	SCALE	DRAWING BY	CHECKED BY	PROJECT ENG.

NO CONSTRUCTION PERMITTED UNLESS DRAWING APPROVED

APPROVED FOR CONSTRUCTION	BY:	DATE:

SCALE	SIZE	DRAWING NO.	SHEET NO.	REV.	BUDGET REF.	LOCATION	SIZE	CLASS	SERIAL NO.	SHEET	REVISION
AS SHOWN	A1	BK-GCS-PEDCO-120-HV-PY-0012	02 OF 02	D00	053-073-9184	F	4	B	709512	02 OF 02	D00