

CONNECT TO SANITARY SEWERAGE NETWORK

1 FLOOR PLAN
SC.1:50 Sewage Piping Layout

| | |
|-----|--------------|
| 100 | CONTROL ROOM |
| 101 | RACK ROOM |
| 102 | PANTRY |
| 103 | WC |
| 104 | ENTRANCE |

- NOTES**
- GENERAL NOTES:**
- ALL DIMENSIONS ARE IN MILLIMETER & ALL ELEVATIONS ARE IN METER UNLESS NOTED OTHERWISE.
 - ALL DIMENSIONS AND ELEVATIONS SHALL BE CHECKED BY THE CONTRACTOR PRIOR TO CONSTRUCTION.
 - THIS DWG. SHOULD BE WORKED TOGETHER WITH THE OTHER MECHANICAL, ARCHITECTURAL ELECTRICAL DWGS. & ANY CONFLICT SHOULD CLARIFIED BY THE CONTRACTOR PRIOR TO CONSTRUCTION.
 - ALL HORIZONTAL DOMESTIC WATER PIPES IN THE BUILDING SHALL RUN ABOVE THE FALSE CEILING UNLESS OTHERWISE SPECIFIED.
 - MATERIAL OF DOMESTIC COLD AND HOT WATER PIPES OUTSIDE BUILDING ARE GALVANIZED STEEL IN ACCORDANCE WITH ASTM A53 AND FITTINGS ARE IN ACCORDANCE WITH ASME B16.12.
 - DOMESTIC HOT WATER PIPING INSIDE THE BUILDING WILL BE COVERED WITH THERMAL INSULATION (WATER PIPE INSULATION) ACCORDING TO NIBR TOPIC 16.
 - DOMESTIC COLD WATER PIPING OUTSIDE THE BUILDING SHALL BE COVERED WITH ELASTOMERIC INSULATION (MIN 25MM)
 - TOP OF THE SUPPORT STEEL STRUCTURE SHALL BE CONSIDERED AS B.O.P.
 - MATERIAL OF SANITARY SEWER, VENT PIPES AND FITTINGS SHALL BE PVC-U (80-TYPE) IN ACCORDANCE WITH EN 1451.
 - EXPOSED VENT PIPE AT ROOF LEVEL SHALL BE PROTECTED FROM SUNLIGHT BY PAINTING, COATING OR INSULATION.
 - SLOPE OF SEWAGE PIPES ARE 1.5% - 2% TO DRAIN.
 - MATERIAL OF DOMESTIC COLD AND HOT WATER PIPES INSIDE BUILDING SHALL BE FIVE LAYERED POLYETHYLENE PEX -AL- PEX ACCORDING TO ASTM F1281/1282 AND FITTINGS SHALL BE ACCORDING TO ASTM F1281/1282.
 - MATERIAL OF HOT DIPPED GALVANIZED STEEL PIPE SHALL BE ACCORDING TO ASTM A53 GR B AND FITTINGS SHALL BE ACCORDING TO ASTM A234 GR WPB.
 - ALL VALVES ABOVE THE FALSE CEILING SHALL HAVE ACCESS DOOR.
 - THE WASTE FROM BUILDING TO WASTE WATER TREATMENT PLANT SHALL DISCHARGE BY GRAVITY FLOW.
 - FINAL ROUTE FOR PLUMBING SHALL NOT BE OVER AND NEAR THE ELECTRICAL & CONTROL PANEL.

LEGEND

| REFERENCE DRAWING | DRG. No. |
|--|------------------------------|
| HVAC & Plumbing Design Criteria | BK-GNRL-PEDCO-000-HV-DC-0001 |
| Specification For Duct Work & Pipe Work | BK-GNRL-PEDCO-000-HV-SP-0002 |
| Standard Drawing For HVAC & Plumbing | BK-GNRL-PEDCO-000-HV-DW-0001 |
| Symbol & Legend For HVAC & Plumbing | BK-GNRL-PEDCO-000-HV-DW-0002 |
| HVAC System Layout And Plumbing For CCTV Control Room - BINAK DU | BK-GCS-PEDCO-120-HV-PY-0010 |
| Architectural Drawing For CCTV Control Room - Binak DU | BK-GCS-PEDCO-120-AR-DW-0009 |
| Site Sewerage System Layout & Details | BK-GCS-PEDCO-120-CV-PY-0001 |
| Unit Plot Plan Drawing | BK-GCS-PEDCO-120-PI-PY-0001 |

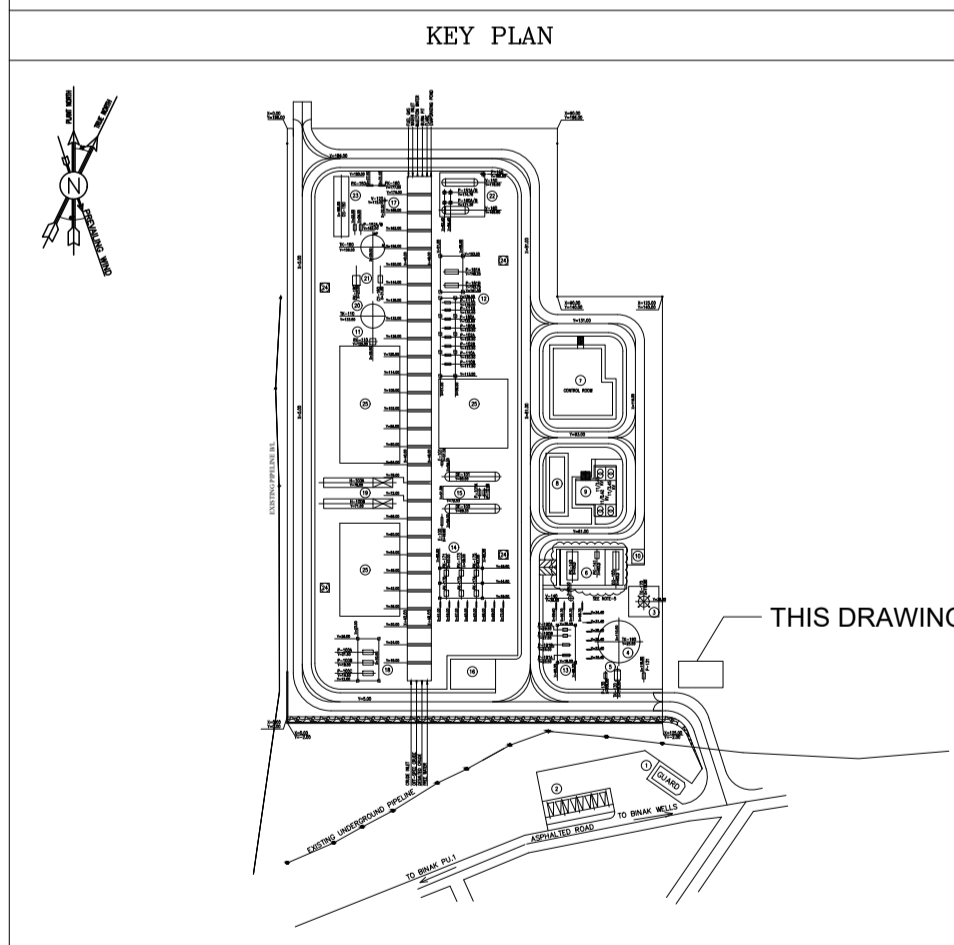

| REV. | DESCRIPTION | BY | DATE | BY | DATE | | | | | |
|--|-------------|-----------------------------|-----------------------------------|-------------|--------------|----------|------------|------------|--------|--------------|
| DOO | JAN.2024 | IPC | KAHMADI | M.FAKHARIAN | S.FARMAZPOUR | | | | | |
| REV. | DATE | P.O.I.S | PREP. | CHK. | APP. | AUT. | | | | |
| PROJECT NAME: BINAK OILFIELD DEVELOPMENT/SURFACE FACILITIES GAS COMPRESSOR STATION | | | | | | | | | | |
| PROJECT NO.: 971020 | | | | | | | | | | |
| EPC CONTRACTOR: | | | EPD/EPC CONTRACTOR (GC): | | | | | | | |
| HIRGAN ENERGY - DESIGN & INSPECTION COMPANIES | | | PETROIRAN DEVELOPMENT COMPANY | | | | | | | |
| DRAWING TITLE: Plumbing & Sewage Piping Layout For CCTV Control Room - BINAK DU | | | | | | | | | | |
| NO CONSTRUCTION PERMITTED UNLESS DRAWING APPROVED | | | | | | | | | | |
| APPROVED FOR CONSTRUCTION | | | BY: DATE: | | | | | | | |
| SCALE | SIZE | DRAWING NO. | SHEET NO. | REV. | BUDGET REF. | LOCATION | SIZE CLASS | SERIAL NO. | SHEET | REVISION |
| AS SHOWN | A1 | BK-GCS-PEDCO-120-HV-PY-0013 | 01 OF 02 | D00 | 053-073-9184 | F | 4 | B | 709513 | 01 OF 02 D00 |

اصل و کلیه نسخ این نقشه و حق اقتباس متعلق به شرکت ملی مناطق نفت خیز جنوب میباشد.
THE ORIGINAL AND ALL COPIES OF THIS DRAWING TOGETHER WITH THE COPYRIGHT THEREIN ARE THE SOLE PROPERTY OF N.I.S.O.C./ FIELDS

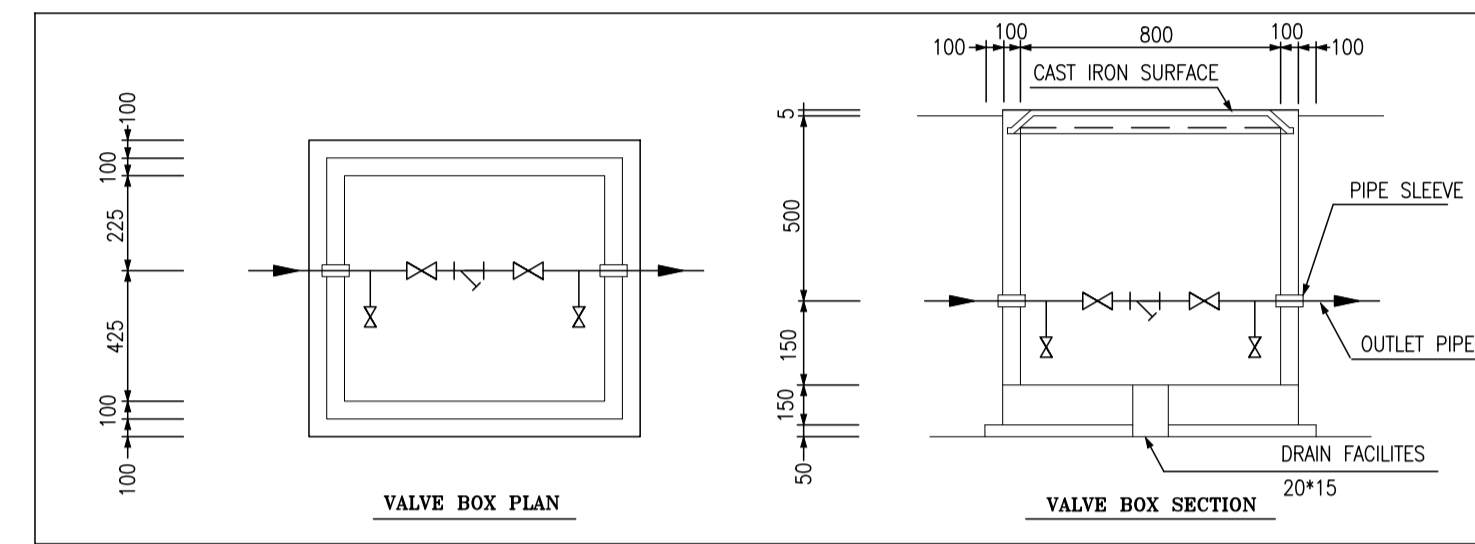
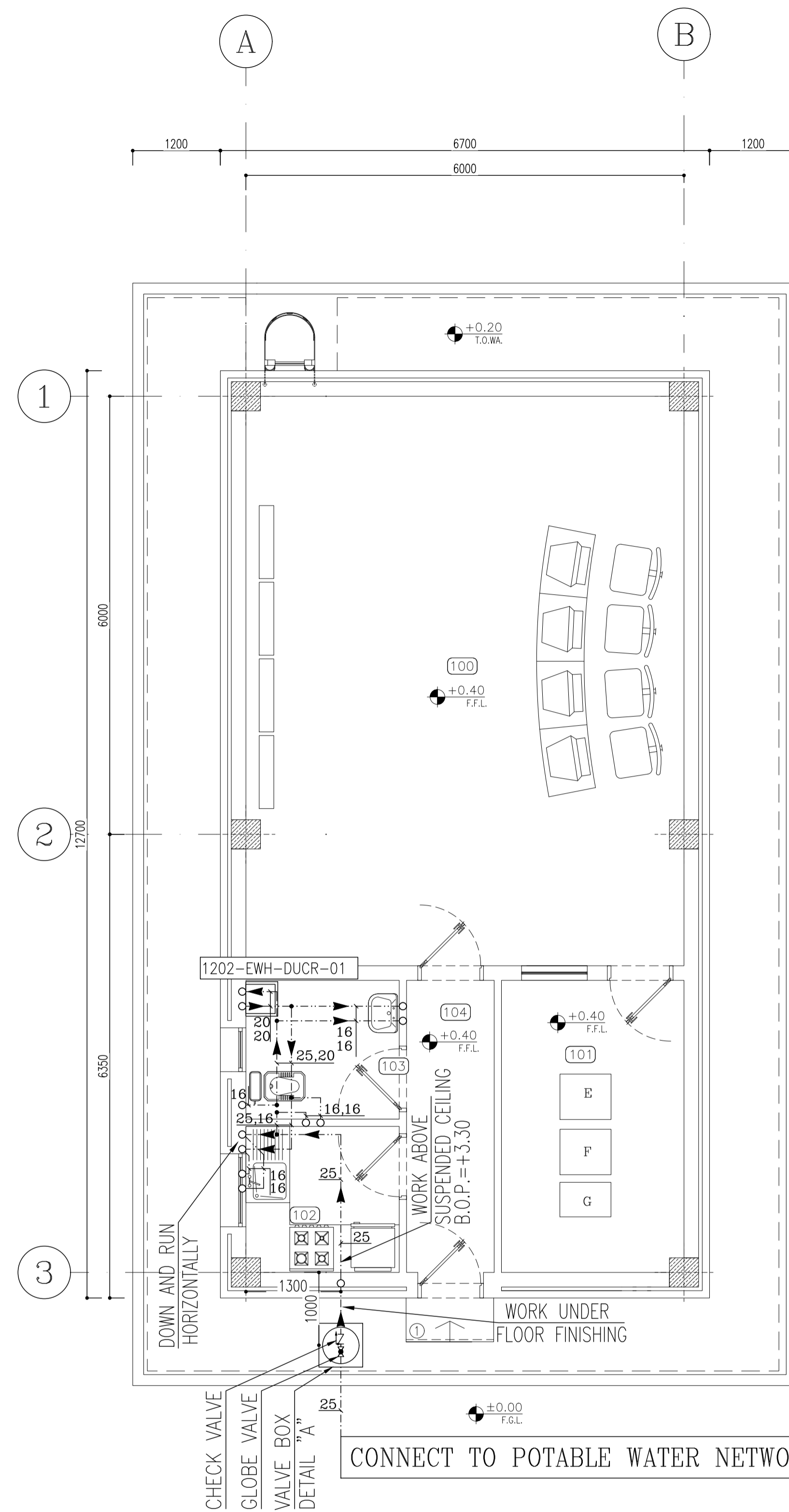
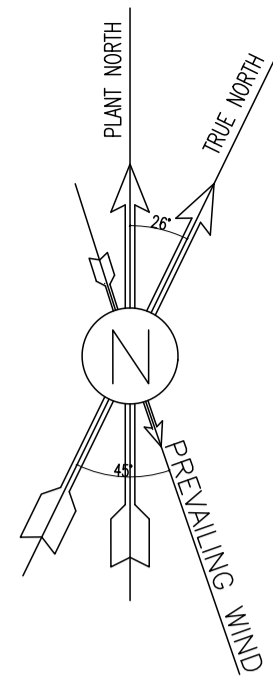

ALL DIMENSIONS OF VALVE BOX ARE IN MILIMETER

DETAIL "A" : VALVE BOX PLAN AND SECTION

2 FLOOR PLAN
SC.1:50 Potable Water Piping Layout

| | |
|-----|--------------|
| 100 | CONTROL ROOM |
| 101 | RACK ROOM |
| 102 | PANTRY |
| 103 | WC |
| 104 | ENTRANCE |

- NOTES
- GENERAL NOTES:
1. ALL DIMENSIONS ARE IN MILLIMETER & ALL ELEVATIONS ARE IN METER UNLESS NOTED OTHERWISE.
 2. ALL DIMENSIONS AND ELEVATIONS SHALL BE CHECKED BY THE CONTRACTOR PRIOR TO CONSTRUCTION.
 3. THIS DWG. SHOULD BE WORKED TOGETHER WITH THE OTHER MECHANICAL, ARCHITECTURAL ELECTRICAL DWGS. & ANY CONFLICT SHOULD CLARIFIED BY THE CONTRACTOR PRIOR TO CONSTRUCTION.
 4. ALL HORIZONTAL DOMESTIC WATER PIPES IN THE BUILDING SHALL RUN ABOVE THE FALSE CEILING UNLESS OTHERWISE SPECIFIED.
 5. MATERIAL OF DOMESTIC COLD AND HOT WATER PIPES OUTSIDE BUILDING ARE GALVANIZED STEEL IN ACCORDANCE WITH ASTM A53 AND FITTINGS ARE IN ACCORDANCE WITH ASME B16.12.
 6. DOMESTIC HOT WATER PIPING INSIDE THE BUILDING WILL BE COVERED WITH THERMAL INSULATION (WATER PIPE INSULATION) ACCORDING TO NIBR TOPIC 16.
 7. DOMESTIC COLD WATER PIPING OUTSIDE THE BUILDING SHALL BE COVERED WITH ELASTOMERIC INSULATION (MIN 25MM)
 8. TOP OF THE SUPPORT STEEL STRUCTURE SHALL BE CONSIDERED AS B.O.P.
 9. MATERIAL OF SANITARY SEWER, VENT PIPES AND FITTINGS SHALL BE PVC-U (80-TYPE) IN ACCORDANCE WITH EN 1451.
 10. EXPOSED VENT PIPE AT ROOF LEVEL SHALL BE PROTECTED FROM SUNLIGHT BY PAINTING, COATING OR INSULATION.
 11. SLOPE OF SEWAGE PIPES ARE 1.5% ~ 2% TO DRAIN.
 12. MATERIAL OF DOMESTIC COLD AND HOT WATER PIPES INSIDE BUILDING SHALL BE FIVE LAYERED POLYETHYLENE PEX -AL- PEX ACCORDING TO ASTM F1281/1282 AND FITTINGS SHALL BE ACCORDING TO ASTM F1281/1282.
 13. MATERIAL OF HOT DIPPED GALVANIZED STEEL PIPE SHALL BE ACCORDING TO ASTM A53 GR B AND FITTINGS SHALL BE ACCORDING TO ASTM A234 GR WPB.
 14. ALL VALVES ABOVE THE FALSE CEILING SHALL HAVE ACCESS DOOR.
 15. THE WASTE FROM BUILDING TO WASTE WATER TREATMENT PLANT SHALL DISCHARGE BY GRAVITY FLOW.
 16. FINAL ROUTE FOR PLUMBING SHALL NOT BE OVER AND NEAR THE ELECTRICAL & CONTROL PANEL.

LEGEND

| REFERENCE DRAWING | DRG. No. |
|--|------------------------------|
| HVAC & Plumbing Design Criteria | BK-GNRL-PEDCO-000-HV-DC-0001 |
| Specification For Duct Work & Pipe Work | BK-GNRL-PEDCO-000-HV-SP-0002 |
| Standard Drawing For HVAC & Plumbing | BK-GNRL-PEDCO-000-HV-DW-0001 |
| Symbol & Legend For HVAC & Plumbing | BK-GNRL-PEDCO-000-HV-DW-0002 |
| HVAC System Layout And Plumbing For For CCTV Control Room - BINAK DU | BK-GCS-PEDCO-120-HV-PY-0010 |
| Architectural Drawing For CCTV Control Room - Binak DU | BK-GCS-PEDCO-120-AR-DW-0009 |
| Site Sewerage System Layout & Details | BK-GCS-PEDCO-120-CV-PY-0001 |
| Unit Plot Plan Drawing | BK-GCS-PEDCO-120-PI-PY-0001 |

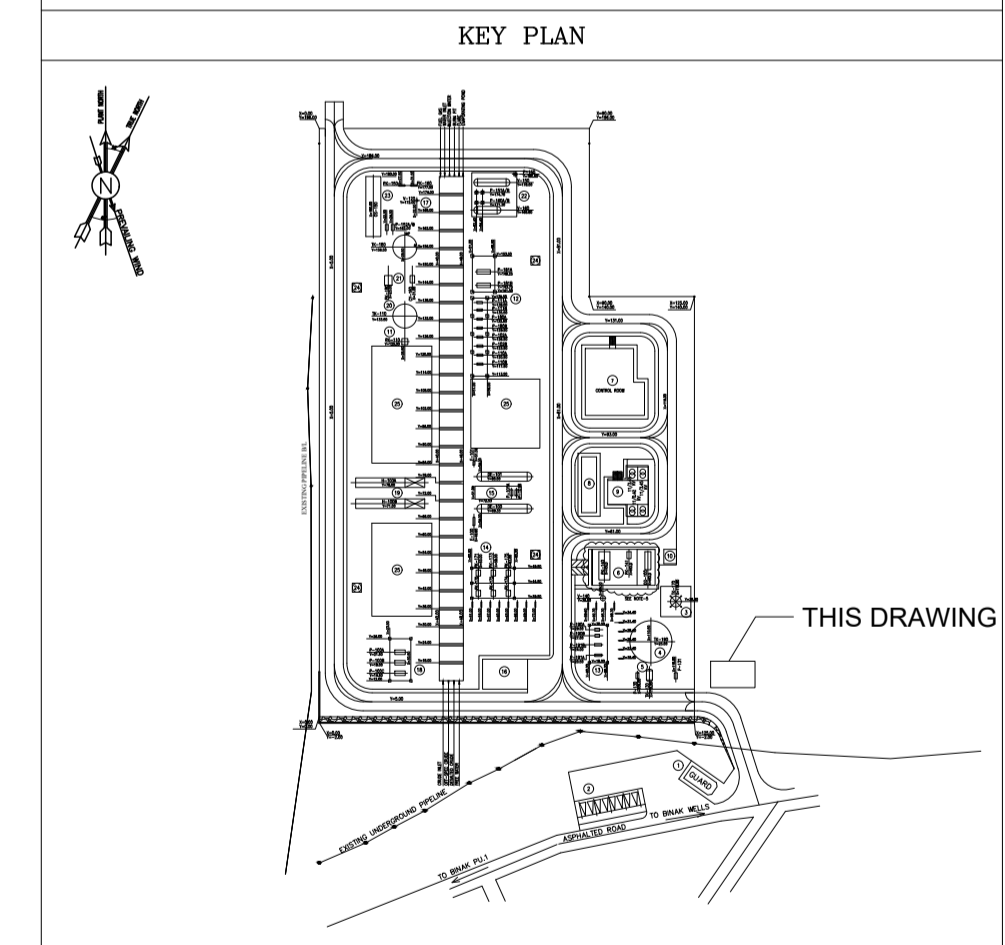

Hot Water Demand per Fixture (Office)

| Fixture | Demand (GPH) | Quantity | Total Demand (GPH) |
|------------------------|--------------|----------|--------------------|
| Basin, privet lavatory | 2 | 1 | 2 |
| Pantry Sink | 10 | 1 | 10 |
| Demand Factor | 0.3 | | 12 |
| Storage Factor | 2 | | |

$V = 12 \times 0.3 \times 2 \times 3.785 = 27.252 \text{ Lit} \sim 30 \text{ Lit}$

AUTOMATIC ELECTRICAL WATER HEATER

| EQUIPMENT NO. | QTY | INSTALLATION AREA | TYPE | NOMINAL STORAGE TANK CAPACITY (Liter) | STORAGE TANK MATERIAL CONSTRUCTION | ELECTRIC POWER SUPPLY V/PH/Hz | HEATING ELEMENT POWER (KW) | INCLUDING |
|------------------|-----|-------------------|--------------|---------------------------------------|------------------------------------|-------------------------------|----------------------------|--|
| 1202-EWH-DUCR-01 | 1 | TOILET | WALL MOUNTED | 30 | GALVANIZED STEEL | 230/1/50 | 2 | STANDARD THERMOSTATS (A SAFETY CUT-OUT) PREVENTING THE ELECTRICALLY-LIVE PARTS TO BE IN CONTACT WITH WATER. AND EQUIPPED WITH DRAIN VALVE, TEMPERATURE GAGE AND ALL STANDARD ACCESSORIES |

| REV. | DESCRIPTION | BY | DATE | BY | DATE | |
|------|-------------|---------|--------|-------------|--------------|------|
| DOO | JAN.2024 | IPC | KAHMAI | M.FAKHARIAN | S.FARMAZPOUR | |
| REV. | DATE | P.O.I.S | PREP. | CHK. | APP. | AUT. |

PROJECT NAME: BINAK OILFIELD DEVELOPMENT/SURFACE FACILITIES GAS COMPRESSOR STATION

PROJECT NO.: 971020

EPC CONTRACTOR: HIRGAN ENERGY (DESIGN & INSPECTION COMPANIES)

EPD/EPC CONTRACTOR (GC): PETROIRAN DEVELOPMENT COMPANY

DRAWING TITLE: Plumbing & Sewage Piping Layout For CCTV Control Room - BINAK DU

NO CONSTRUCTION PERMITTED UNLESS DRAWING APPROVED

| DATE | SCALE | DRAWING BY | CHECKED BY | PROJECT ENG. |
|------|-------|------------|------------|--------------|
| | | | | |

| SCALE | SIZE | DRAWING NO. | SHEET NO. | REV. | BUDGET REF. | LOCATION | SIZE CLASS | SERIAL NO. | SHEET REVISION |
|----------|------|-----------------------------|-----------|------|--------------|----------|------------|------------|---------------------|
| AS SHOWN | A1 | BK-GCS-PEDCO-120-HV-PY-0013 | 02 OF 02 | D00 | 053-073-9184 | F | 4 | B | 709513 02 OF 02 D00 |